



KUBIE GOLD  
ASSOCIATES

## BOSTON PLACE MARYLEBONE NW1



- THREE BED TWO BATHROOMS
- BRAND NEW REFURBISHMENT
- RECEPTION WOOD FLOORS
- CHARMING HOUSE
- NEAR TO PARK & TUBES
- AVAILABLE IMMEDIATELY

**£4,995 pcm**

**SALES, LETTINGS & PROPERTY MANAGEMENT**

Tel:

020 7563 7272

36 Ivor, Regents Park, London, NW1 6EA

Email: [info@kubie-gold.co.uk](mailto:info@kubie-gold.co.uk) Website: [www.kubie-gold.co.uk](http://www.kubie-gold.co.uk)

Kubie Gold Associates is the trading name of Kubie Gold Associates Ltd  
Company Registration No. 7271501 registered in England and Wales



# Boston Place, NW1

Beautifully refurbished three-bedroom, two-bathroom period house situated on quiet residential street in the highly sought-after Marylebone. Finished to an exceptional standard throughout. The spacious reception area features newly installed wooden flooring, generous ceiling heights, and an abundance of natural light perfect for both relaxing and entertaining. A brand-new modern kitchen is fully fitted with high-spec integrated appliances, with ample workspace. The principal bedroom with built-in storage and a stylish en-suite shower room, two additional well-proportioned bedrooms provide excellent flexibility for family living, guests, or a dedicated home office. Further bathroom with step in power shower . Further benefits new double-glazing, and thoughtful storage throughout. Located within walking distance of Marylebone High Street, Regent’s Park, boutique shops, cafés, excellent restaurants, and both Marylebone and Baker Street Tube Stations. Available immediately.

Approx Gross Internal Area  
76 sq m / 813 sq ft

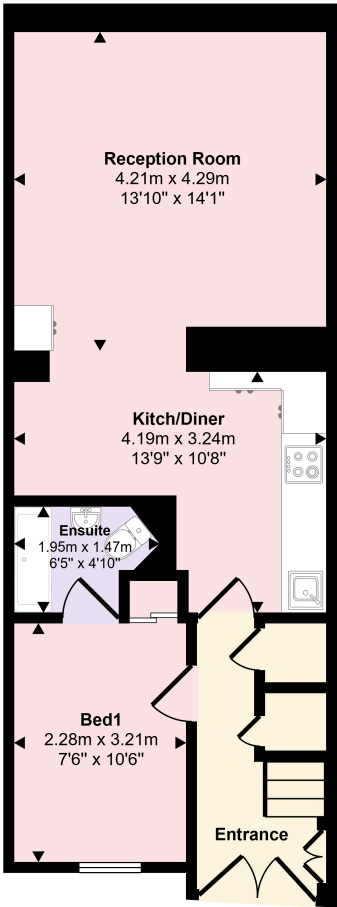

Ground Floor  
Approx 48 sq m / 522 sq ft

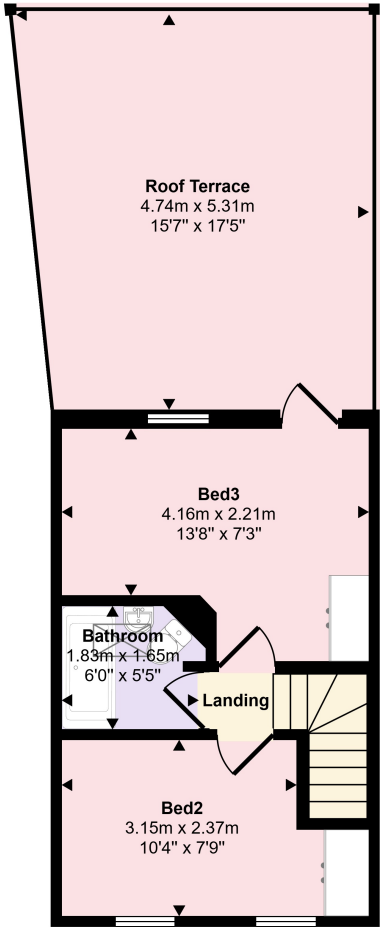

First Floor  
Approx 27 sq m / 291 sq ft

This floorplan is only for illustrative purposes and is not to scale. Measurements of rooms, doors, windows, and any items are approximate and no responsibility is taken for any error, omission or mis-statement. Icons of items such as bathroom suites are representations only and may not look like the real items. Made with Made Snappy 360.

## Local Authority:

Westminster

## Tax Band:

Band G

