



Day & Co
ESTATE AGENTS

28 Cavendish Street
Keighley
BD21 3RG



251 Bradford Road, Riddlesden,
Keighley, West Yorkshire, BD20
5JR

£299,995

T: 01535 664609

W: www.dayandcoestateagents.co.uk

E: keighley@dayandcoestateagents.co.uk

- Extended Semi-Detached
- Two Reception Rooms & Modern Fitted Kitchen
- Open Outlook To The Front
- EPC Rating D

- Five Bedrooms & Two Bathrooms
- Good Size Driveway & Spacious Outbuilding
- Popular Location Of Riddlesden

SUMMARY

****AN EXTENDED 5 BEDROOM SEMI-DETACHED FAMILY HOME, POPULAR RESIDENTIAL LOCATION OF RIDDLESDEN WITH OPEN OUTLOOK TO THE FRONT!!**** Having 2 reception rooms, 2 bathrooms, good size drive, spacious out building - VIEWING ESSENTIAL TO FULLY APPRECIATE!! EPC Rating D

FULL DESCRIPTION

An ideal purchase for the growing family is this five bedroom extended semi-detached family home situated in the popular residential location of Riddlesden with open outlook to the front. The deceptively spacious accommodation comprises of an entrance hall giving access to the lounge which has a double glazed window to the front and radiator. The sitting room measures approximately 17ft in length and has a double glazed window and radiator. the kitchen is a real feature of this property having an attractive range of modern base and wall mounted units, integrated appliances to include double oven, five ring gas hob, dishwasher, tiled flooring with under floor heating. To the first floor there are three bedrooms and the house bathroom having a bath with shower over, WC, wash hand basin. To the second floor are a further two bedrooms and a separate shower room with shower cubicle, WC, wash hand basin. Externally there is a front garden, good size drive, rear artificial lawn with decking and a spacious outbuilding with power, light and double glazed patio doors. Viewing essential to fully appreciate, EPC Rating D

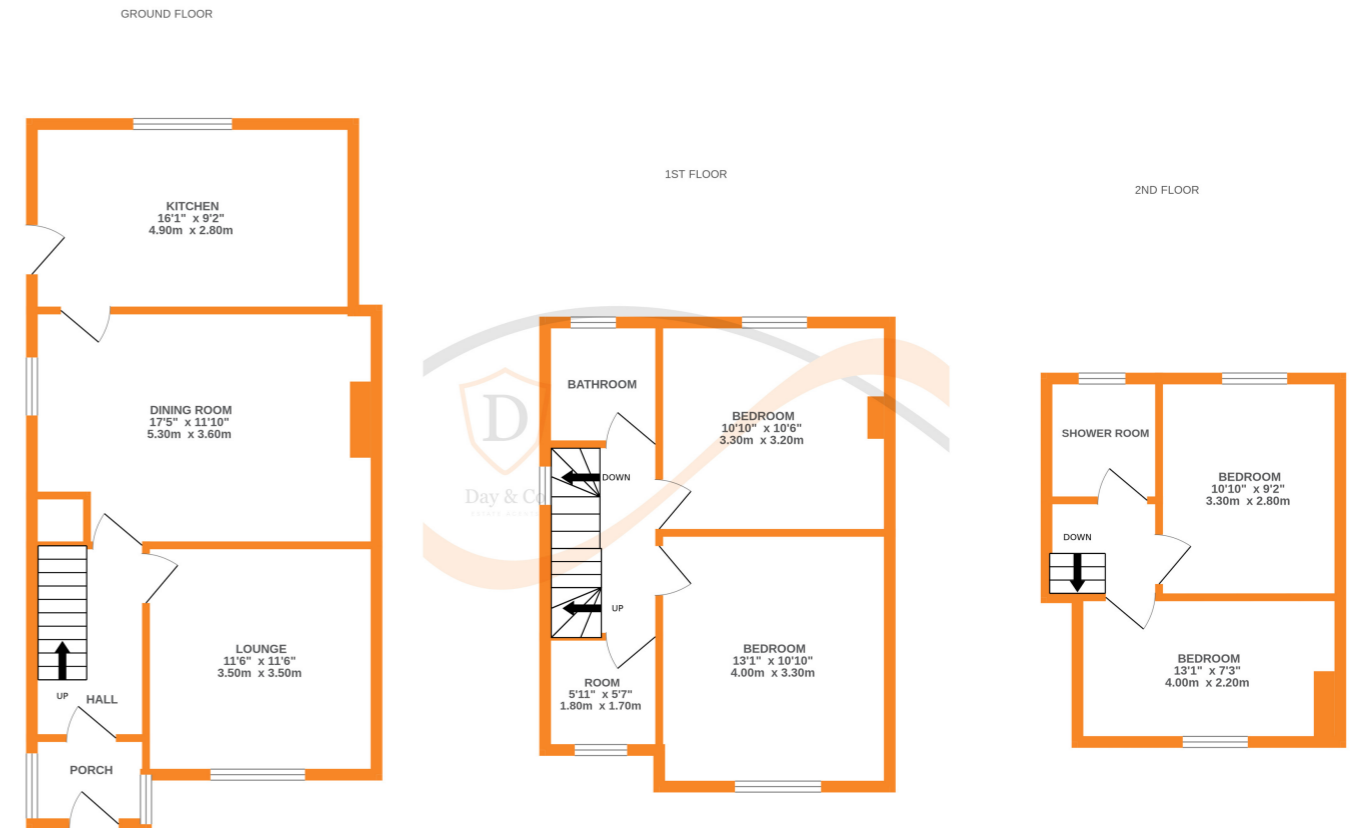

Whilst every attempt has been made to ensure the accuracy of the floorplan contained here, measurements of doors, windows, rooms and any other items are approximate and no responsibility is taken for any error, omission or mis-statement. This plan is for illustrative purposes only and should be used as such by any prospective purchaser. The services, systems and appliances shown have not been tested and no guarantee as to their operability or efficiency can be given.
Made with Metropix ©2024