

Sunbury Court Mews, Sunbury-on-Thames, TW16 5PF

Guide Price £260,000



- Garage With Power
- First Floor Apartment
- Four Piece Bathroom Suite
- Close To River Thames
- Share Of Freehold
- Well Presented Throughout
- Gas Central Heating
- Ideal First Time Buy Or Investment

Sunbury Court Mews, Sunbury, TW16

Approximate Gross Internal Area
Main House 527 sq ft - 49 sq m
Garage 205 sq ft - 19 sq m
Total 732 sq ft - 68 sq m

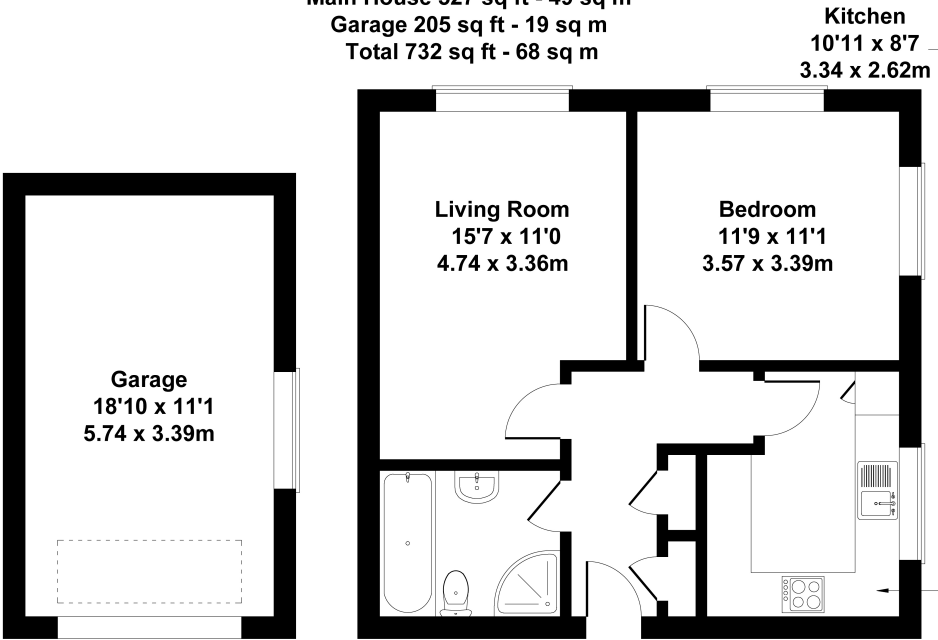

GARAGE

This floorplan is for guidance only and does not form part of an offer or contract.
Buyers or tenants should verify all details through inspection, searches, and surveys.
Measurements are approximate and should not be relied upon for valuation or transactions.
Produced by Plan Portal.
www.evovelondon.co.uk

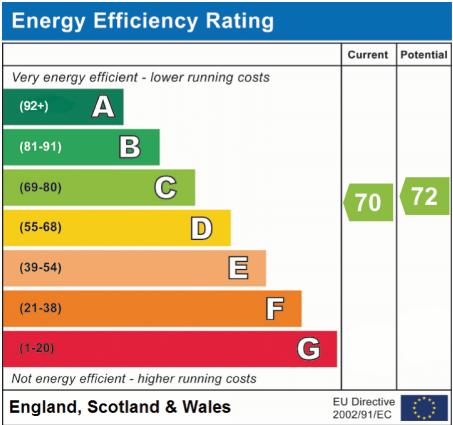

We have not tested the services or domestic appliances so we cannot verify that they are in working order. The buyer is advised to obtain verification from their solicitor or surveyor. There particulars form no part of any offer or contract and their accuracy cannot be guaranteed.