



Flat 1 Roquebrune, West Parade, Bexhill-on-Sea, East Sussex, TN39 3HE

£280,000



- Three Bedroom Garden Flat
- Highly Sought After Seafront Location
- South Facing Lounge-Diner
- Conservatory Overlooking Garden
- Central Heating & D.Glazed
- Three Good Size Bedrooms
- Master Bedroom With En-Suite
- Spacious & Versatile Accommodation
- Private Use Of Front Garden
- Off Road Parking To The Rear
- Private Entrances To Both Front & Rear
- Close To Town Centre & Station
- Long Lease & Share Of Freehold
- Maintenance Fund Being Set Up



**GROUND FLOOR**  
 1529 sq.ft. (142.0 sq.m.) approx.

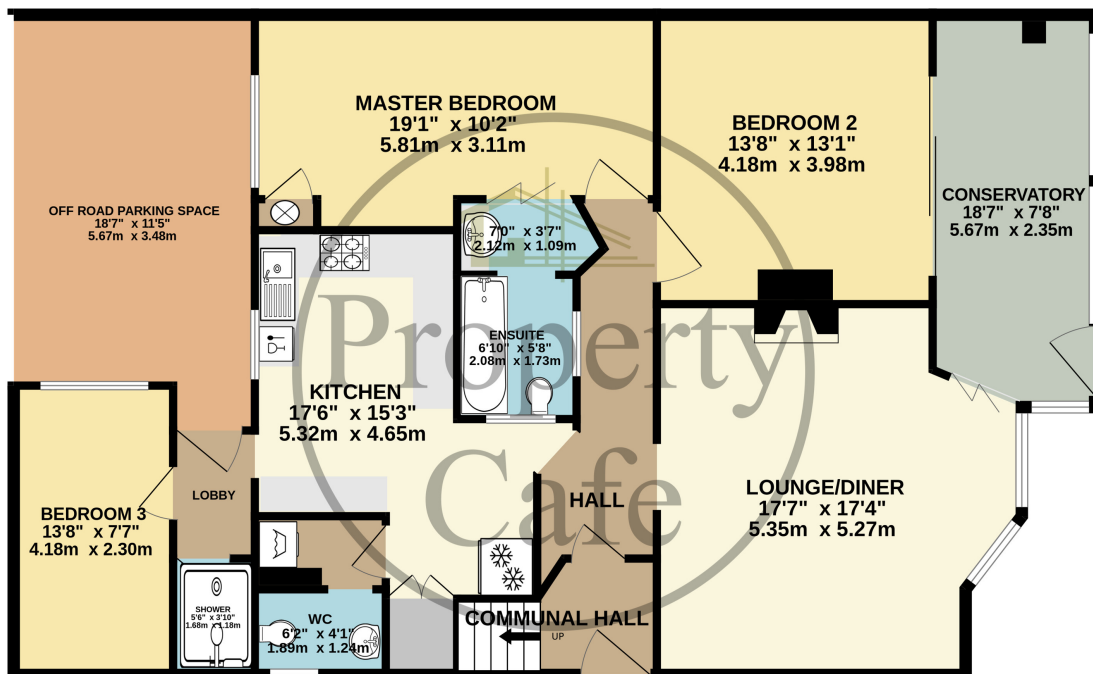

TOTAL FLOOR AREA : 1529 sq.ft. (142.0 sq.m.) approx.

Whilst every attempt has been made to ensure the accuracy of the floorplan contained here, measurements of doors, windows, rooms and any other items are approximate and no responsibility is taken for any error, omission or mis-statement. This plan is for illustrative purposes only and should be used as such by any prospective purchaser. The services, systems and appliances shown have not been tested and no guarantee as to their operability or efficiency can be given.  
 Made with Metropix ©2023

