



28 Juniper Way, Gainsborough, Lincolnshire. DN21 1GW

- IDEAL FIRST TIME BUY OR INVESTMENT OPPORTUNITY
- BEAUTIFULLY PRESENTED THROUGHOUT
- SPACIOUS LOUNGE & MODERN DINING KITCHEN
- TWO DOUBLE BEDROOMS
- PRIVATE & ENCLOSED REAR GARDEN
- AMPLE OFF ROAD PARKING



PROPERTY DESCRIPTION

****BEAUTIFULLY PRESENTED THROUGHOUT****GREAT LOCATION**** This turn key semi-detached home would make a perfect first time buy or investment opportunity with a attractive dining kitchen, spacious bedrooms and private rear garden. The home is located a short drive away from plenty of amenities including shops, schools and the town centre. The property briefly comprises an entrance hall, lounge, ground floor W.C and contemporary dining kitchen. The first floor offers two double bedrooms serviced by a family bathroom suite. The master bedroom has the added benefit of fitted wardrobes. Externally the home has a lawned frontage with a pebbles drive to the left providing off road parking for three vehicles. The private and enclosed rear garden is mainly laid to lawn with a paved patio entertaining area and useful storage shed. Viewings are highly recommended!



ROOM DESCRIPTIONS



FLOORPLAN

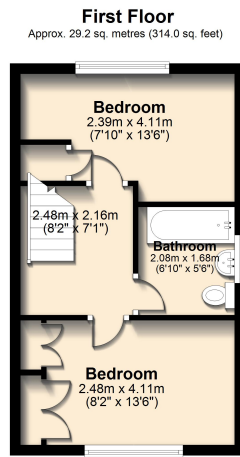
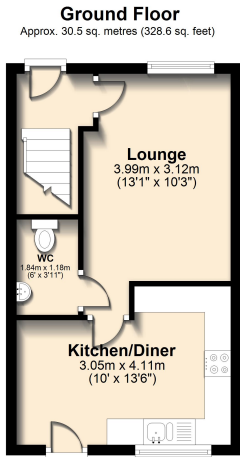

Total area: approx. 59.7 sq. metres (642.6 sq. feet)

Floor plans are intended to give a general indication of the layout only. All images and dimensions are not intended to form part any contract or warranty.
Plan produced using PlanUp.

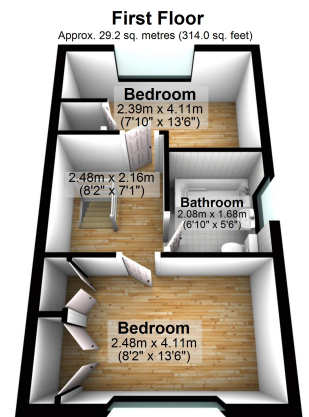
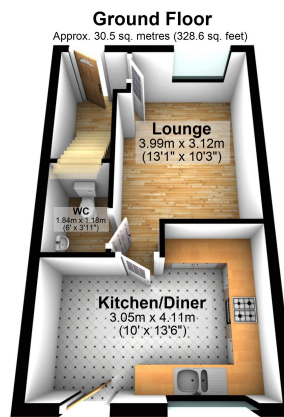

Total area: approx. 59.7 sq. metres (642.6 sq. feet)

Floor plans are intended to give a general indication of the layout only. All images and dimensions are not intended to form part any contract or warranty.
Plan produced using PlanUp.