



Twynning

01684 293246



19 Hillview Lane, Twyning, GL20 6JW

This is an immaculately presented home, having been extended and updated to offer beautifully light and spacious accommodation throughout. Sitting in an elevated position above the village centre, its prominent position provides far reaching views across to the Cheltenham escarpment.

To the right there is a separate lounge with large picture window overlooking the front garden. It has a feature fireplace housing a log burner and double doors leading through to the large, dual aspect contemporary styled kitchen/dining room with patio doors leading out to the rear garden.

The kitchen is fitted with a range of wall and base units with a large central island which houses 2 Neff ovens; an induction hob, inset extractor and dishwasher.

An archway leads from the kitchen into a dual aspect family room, again benefiting from patio doors out to the garden.

Completing the accommodation on the ground floor is a useful utility/cloakroom with wc and space and plumbing for a washing machine and tumble drier.

On the first floor there are four bedrooms and a family bathroom. The main bedroom has the benefit of a modern ensuite shower room.



The main bathroom is fitted with a modern suite comprising of a p shaped bath with shower over, a vanity unit with inset wash basin, heated towel rail and a back to the wall wc.

Outside the gardens are lovely with a large lawned area against a mature hedge back drop. There are several patio areas to take full advantage of the sun and the shade and it has the benefit of gated side access.

The garage which has the benefit of power and light with ample driveway parking for several vehicles both in front of the garage and the house.

Twyning is a popular traditional village with primary school and village inn overlooking the village green. In addition there is a further dining pub with river views; impressive recreation centre with floodlit tennis courts; church and chapel; and bus links with Tewkesbury and surrounding villages.

Being located approximately 3 miles from Tewkesbury it benefits from excellent motorway links making it an ideal commuter base.

GROUND FLOOR

1ST FLOOR

Ground Floor

| | |
|---------------------|--------------|
| Entrance Hall | |
| Lounge | 15'3"x13'8" |
| Kitchen/dining room | 18'5"x17'10" |
| Family Room | 15'5"x12'1" |
| Utility/wc | 7'2"x5'1" |

First Floor

| | |
|-----------|-------------|
| Bedroom 1 | 15'6"x12'1" |
| Ensuite | 11'8"x6'11" |
| Bedroom 2 | 9'11"x7'10" |
| Bedroom 3 | 10'x9'11" |
| Bedroom 4 | 9'3"x8'11" |
| Bathroom | 7'11"x6' |

Outside

Garage

Tewkesbury Borough Council Tax Band D

Solar

The property benefits from 3.8kw solar panels with 10kw battery storage

Oil Central Heating – External boiler new in 2021

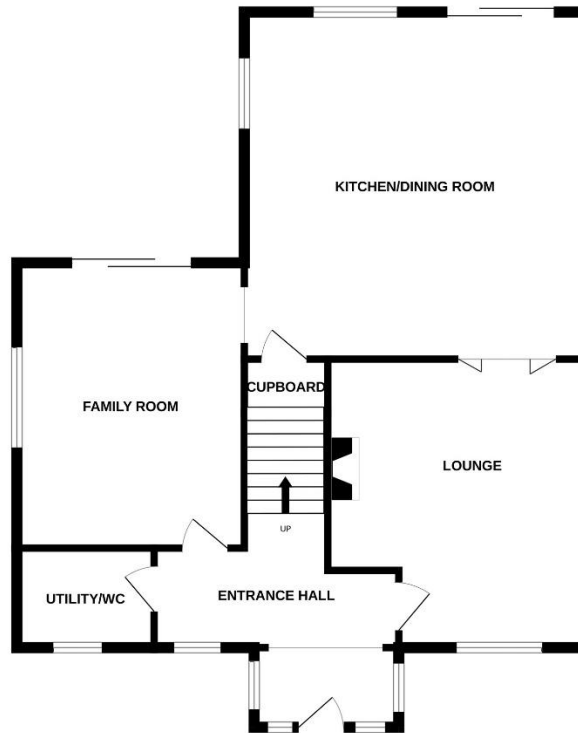

This floorplan is provided for guidance only as an approximate layout of the property and should not be relied upon as a statement of fact.



Guide Price £475,000

Viewing strictly by arrangement with Engall Castle Ltd
 155 High Street Tewkesbury Gloucestershire GL20 5JP
 Office hours: Mon – Fri 9am to 6pm, Sat 9am to 4pm
 email: sales@engallcastle.com

01684 293 246
www.engallcastle.com



Agents Note

These property details are set out as a general outline only and do not constitute any part of an Offer or Contract. Any services equipment, fittings or central heating systems have not been tested and no warranty is given or implied by Engall Castle Ltd that these are in working order. Buyers are advised to obtain verification from their solicitor or surveyor. Fixtures and fittings or other items are not included unless specifically described. All measurements, distances and areas are approximate and for guidance only and should not be relied upon for the purposes of fitting carpets or furniture etc. These property details and all statements within this document are provided without responsibility on behalf of Engall Castle Ltd or its employees or representatives and should not be relied on as statements of fact. Prospective purchasers must satisfy themselves as to the accuracy of all details pertaining to the property.

