



37 Dorset Road, Bexhill-on-Sea, East Sussex,
TN40 1SG

£315,000



- Spacious Ground Floor Garden Flat For Sale
- Vast West Facing lounge Overlooking The Garden
- Separate Dining Room
- Two Substantial Double Bedrooms
- Modern Fitted Shower Room
- Private West Facing Large Rear Garden
- Off-Road Parking
- Sought After Location Close To Town Centre & Train Station
- Feature Fire Places & High Ceilings
- Sold With No Onward Chain
- Viewing Highly Recommended





GROUND FLOOR
1214 sq.ft. (112.8 sq.m.) approx.

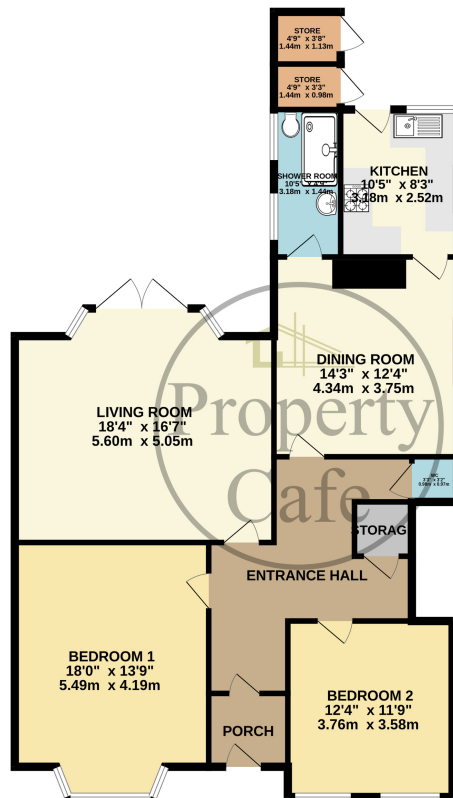

TOTAL FLOOR AREA : 1214 sq.ft. (112.8 sq.m.) approx.

Whilst every attempt has been made to ensure the accuracy of the floorplan contained here, measurements of doors, windows, rooms and any other items are approximate and no responsibility is taken for any error, omission or mis-statement. This plan is for illustrative purposes only and should be used as such by any prospective purchaser. The services, systems and appliances shown have not been tested and no guarantee as to their operability or efficiency can be given.
Made with Metropix 12/2024