



Old Park Road

Hitchin | Hertfordshire | SG5 2JX

www.stonegate-estates.co.uk



OLD PARK ROAD

Property Description

A rare find in Hitchin offering Town centre living with off road parking and your very own courtyard garden, accessed directly from your lounge.

This fabulous apartment has its own independent entrance, hallway, one double bedroom, separate kitchen and lounge with 'French Doors' leading out to the courtyard.

The apartment is very well presented and has the added advantage of underfloor heating in the lounge, hallway and kitchen, double glazing fitted throughout and of course the private off road parking to the rear of the property.

Located within the town centre and a short distance from Hitchin Market Place, High Street and all that it offers with its, cafes, bars and shopping and also allows good access to Oughtonhead nature reserve which is a short walk away.

An ideal First Time Buyer or investment property.

£237,950 Leasehold



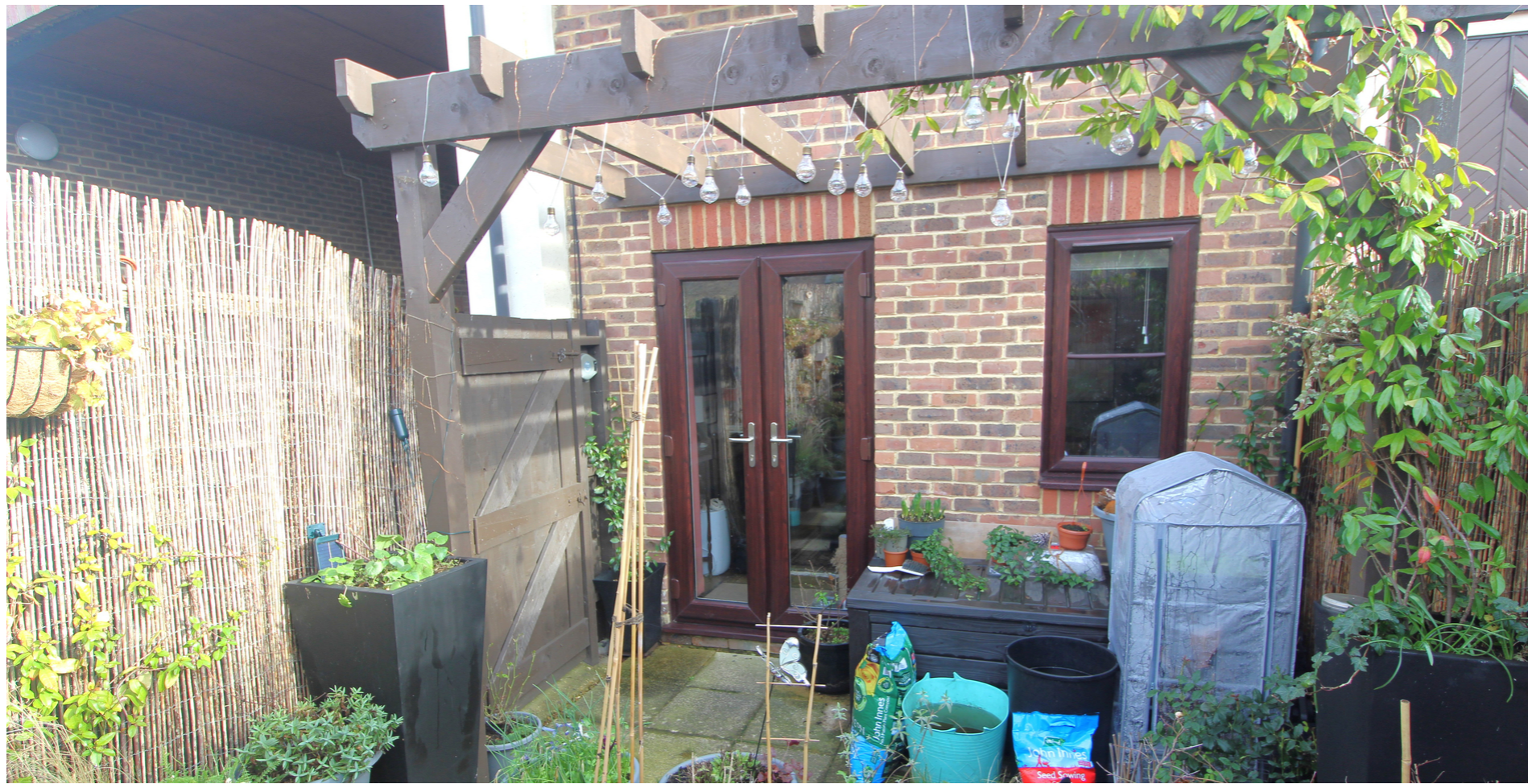

Floor Plan

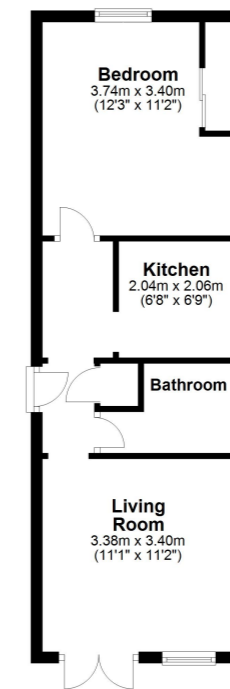

All measurements shown are approximate and for guidance only. Garages and workshops are not included in any gross floor areas unless integral to the main building where they will be included.
Plan produced using PlanUp.



- Fabulous Ground Floor Flat
- Allocated Secure Parking
- Walking Distance to Town and Station
- Central Location
- Underfloor Heating in Lounge and Kitchen
- Ideal First Time Buy or Investment
- 102 Year Lease Remaining
- Lounge Opens onto Private Courtyard
- West Facing Courtyard

EPC Rating:

Stonegate Estate Agents

01462 438979

sales@stonegate-estates.co.uk | www.stonegate-estates.co.uk

