



56 Clifton Road, Henlow, Bedfordshire, SG16 6BL

£400,000

OPEN DAY 30th NOVEMBER Three bedroom semi-detached property situated in a private close of just two houses backing and siding onto fields. Although in need of some updating the property offers great potential with room to extend to the side and rear (subject to planning). Offered with two reception rooms, kitchen, two double and one single bedroom plus bathroom and is situated on a mature plot with outbuildings. Off road parking is provided by a carport and driveway. This is the first time this property has ever come to the market.

Lane &
BENNETTS

56 Clifton Road Henlow

Approximate Gross Internal Area
893 sq ft - 83 sq m

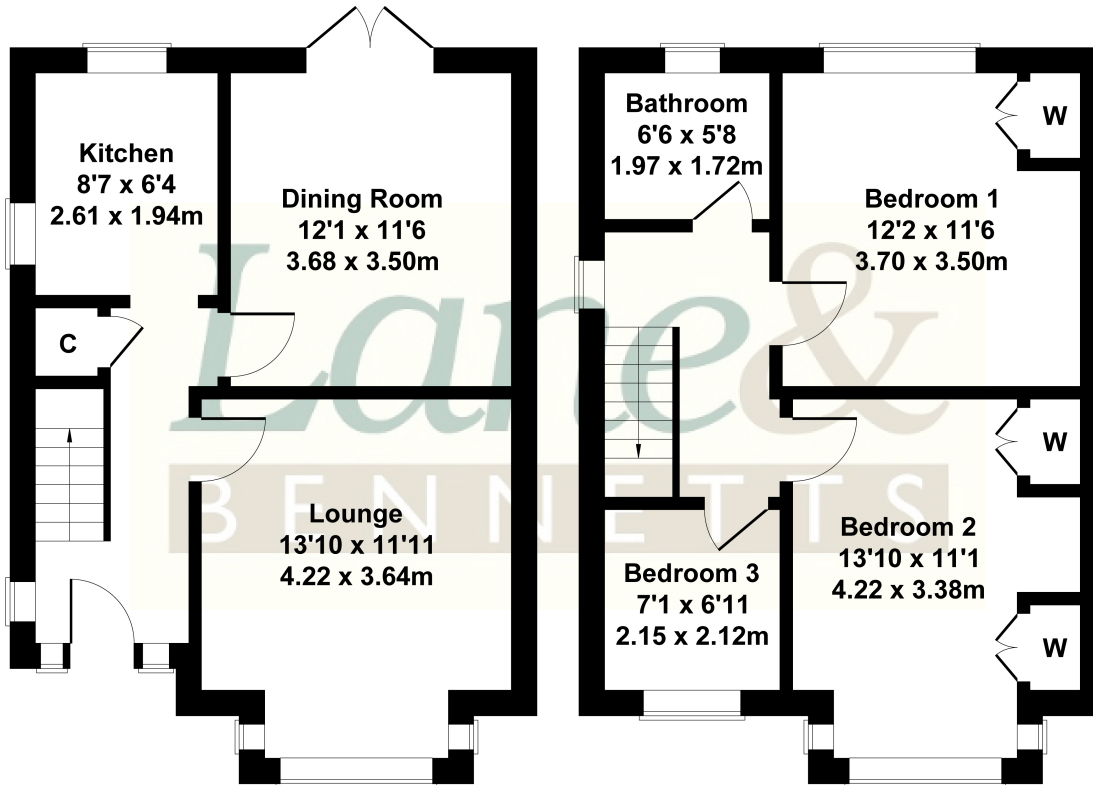

GROUND FLOOR

FIRST FLOOR

Not to Scale. Produced by The Plan Portal 2024
For Illustrative Purposes Only.

- OPEN DAY 30th NOVEMBER
- FIRST TIME THIS PROPERTY HAS EVER COME TO THE MARKET
- THREE BEDROOM SEMI DETACHED HOME
- IN NEED OF SOME UPDATING & MODERNISATION
- GREAT POTENTIAL TO IMPROVE/EXTEND (SUBJECT TO PLANNING)
- PRIVATE CLOSE OF 2 HOUSES
- OFF ROAD PARKING + CAR PORT
- BACKS AND SIDES ONTO COUNTRYSIDE
- CATCHMENT FOR "GOOD" SCHOOLS
- EASY ACCESS TO A1 & ARLESEY TRAIN STATION

