





- Communal Entrance
- Open Plan Living Room
- Lounge & Kitchen Areas
- Double Bedroom
- Shower Room
- Allocated Parking
- Convenient Location
- Unfurnished

### Description

A well-presented, one bedroom first floor apartment, which forms one of four similar properties housed within a large period house. The property is ideally located being very close to Northwich railway station and within walking distance of the town centre. With PVCu double glazing and electric heating, comprises: Communal lobby with stairs to first floor, open plan living room with lounge and kitchen areas, double bedroom and shower room. Outside there is a parking space to the rear. Available unfurnished, restrictions apply.



**Location**

NEW INSTRUCTION

**Tenure****EPC Rating:****Important Notes**

Type Here

### First Floor

Approx. 31.7 sq. metres (340.9 sq. feet)

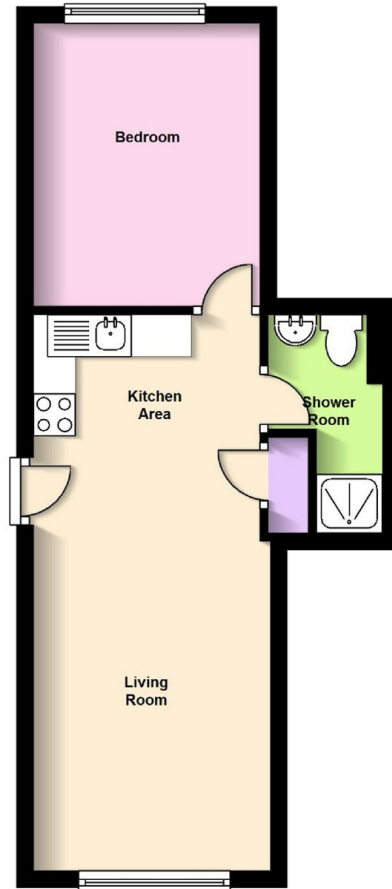

Total area: approx. 31.7 sq. metres (340.9 sq. feet)