



61 Ingleside Drive, Stevenage, Hertfordshire. SG1 4RY

- Three bedrooms
- Generous size plot
- Double garage
- Sought after location
- Private cul-de-sac location



PROPERTY DESCRIPTION

An imposing , three bedroom detached home benefiting from a double garage. A sought after location very close to Lister Hospital and has easy access to the A1m.

The accommodation comprises of light and spacious entrance hall, a spacious lounge with box bay window and light coming in from two aspects. there are shutters fitted to both windows. There is also a separate dining room. In addition to this there is a fitted kitchen with plenty of cupboard pace and part built in appliances. there is a door leading out to the rear garden.

Upstairs are three bedrooms. The master bedroom benefits from fitted, built in wardrobes and has an en-suite shower room. In addition to this the second bedroom is also a good size. Bedroom three, is currently being used as a dressing room and has fitted wardrobes also.

The main family bathroom has enclosed bath with shower, wash basin and W/C.

Outside to the front there is a blocked paved area. To the side of the property there is a detached double garage.

The rear garden is a particular feature of this property and has been laid to artificial grass. There is also a seating area that has had resin laid.

Please note this property has lots of potential and is in a ideal location.



ROOM DESCRIPTIONS



FLOORPLAN



Approximate Gross Internal Area
Ground Floor = 52.7 sq m / 567 sq ft
First Floor = 47.4 sq m / 510 sq ft
Garage = 22.6 sq m / 243 sq ft
Total = 122.7 sq m / 1,320 sq ft

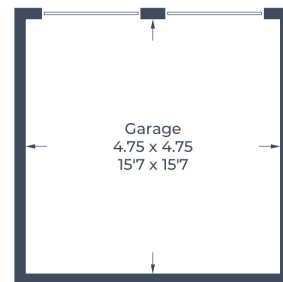

(Not Shown In Actual Location / Orientation)

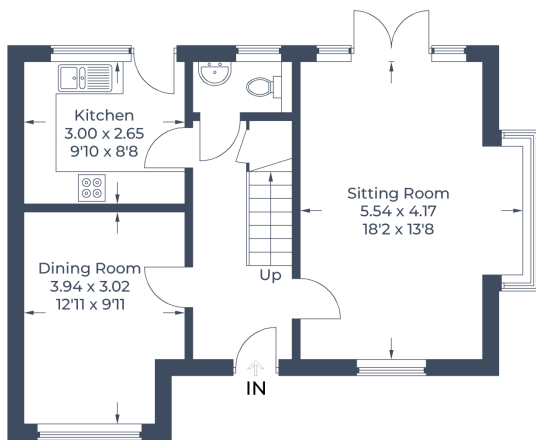

Ground Floor

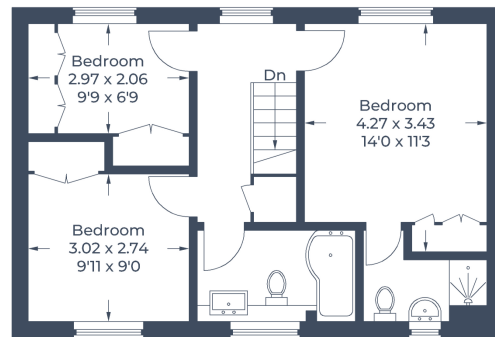

First Floor

Illustration for identification purposes only,
measurements are approximate, not to scale.
© CJ Property Marketing Produced for Own Homes

Stevenage
2, Middle Row, Stevenage, SG1 3AN
01438 367753
sales@own-homes.com