



**5 Clifton Moor, Oakhill, Milton Keynes,
Buckinghamshire, MK5 6FZ**

£330,000 Freehold

- Four bedroom family home
- Beautifully presented garden
- Conservatory / dining room
- Single garage & driveway
- Desirable location
- EPC Rating





Disclaimer

Whilst we have endeavoured to prepare our sales particulars accurately none of the services, appliances or equipment have been tested. A buyer should satisfy themselves on such matters prior to purchase. Any measurements or distances mentioned in these particulars are for guide reference only. If such particulars are fundamental to a purchase, buyers should rely on their own enquiries. All enquiries should be directed to Elevation Estate Agents in the first instance.



Ground Floor

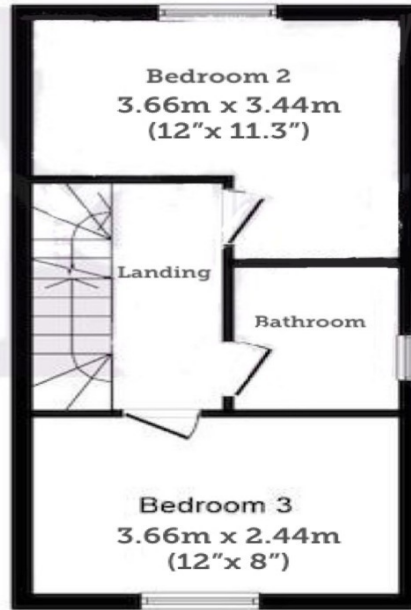

First Floor

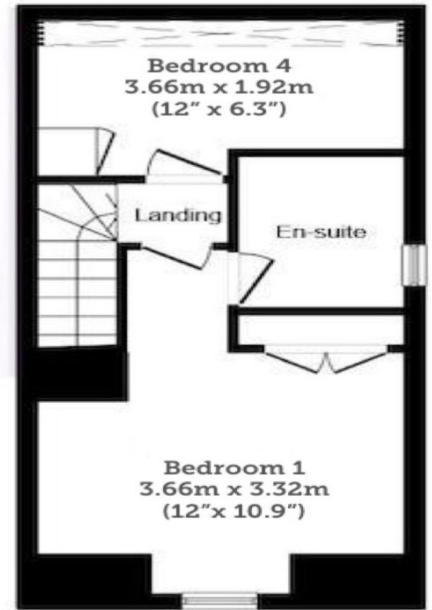

Second Floor