

41 Hermitage Road,
Hitchin, SG5 1BY

Tel: 01462 438979
sales@stonegate-estates.co.uk



Flat 37 Regal Court, Bancroft, Hitchin, Hertfordshire, SG5 1LJ

£115,000 Leasehold

- One Bedroom Apartment
- Over 60's Only
- Lift to all Floors
- Communal Gardens
- Town Centre Location
- Residents Lounge's
- Development Manager on Site
- Refitted Kitchen & Shower room
- 153 year Lease Remaining
- EPC Rating





Floor Plan

Approx. 43.7 sq. metres (469.9 sq. feet)

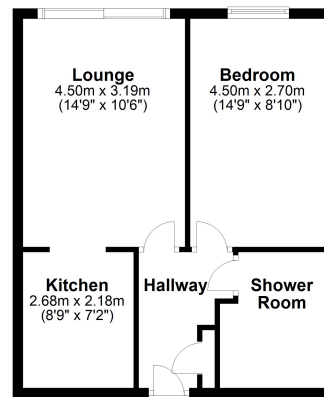

Total area: approx. 43.7 sq. metres (469.9 sq. feet)

All measurements shown are approximate and for guidance only. Garages and workshops are not included in any gross floor areas unless integral to the main building where they will be included.
Plan produced using PlanUp.



Agents note: All measurements are approximate and whilst every attempt has been made to ensure accuracy they are for general guidance only and must not be relied on. The fixture and fittings referred to have not been tested and therefore no guarantee can be given that they are in working order. Internal photographs are reproduced for general information and it must not be inferred that any item shown is included with the property.