



Flat 5, Branksea Grange, 23 The Avenue, BRANKSOME PARK, Dorset BH13 6HA

£395,000

brown & kay



onTheMarket.com



rightmove
find your happy

DISCLAIMER PROPERTY DETAILS: These particulars, whilst believed to be accurate are set out as a general outline only for guidance and do not constitute any part of an offer or contract. Intending purchasers should not rely on them as statements or representation of fact, but must satisfy themselves by inspection or otherwise as to their accuracy. We have not carried out a detailed survey nor tested the services, appliances and specific fittings. Room sizes should not be relied upon for carpets and furnishings. The measurements given are approximate. No person in this firm's employment has the authority to make or give any representation or warranty in respect of the property.

20, Seamoor Road, Bournemouth, Dorset, BH4 9AR



Email: sales@brownandkay.co.uk Web: www.brownandkay.co.uk Tel: 01202 765995



THE PROPERTY

Branksea Grange occupies a peaceful, leafy setting within one of the most sought after locations of Branksome Park amongst homes of similar calibre. Just a short distance away are the charming villages of Canford Cliffs and Westbourne, both renowned for their vibrant mix of independent shops, stylish cafés, and diverse eateries as well as high street names such as Marks and Spencer food hall. For those who enjoy coastal living, the award-winning beaches are close by, offering miles of golden sand and a scenic promenade, perfect for leisurely walks, cycling, or relaxing by the sea. The area is also well catered for with bus services operating to surrounding areas and main line train stations at both Branksome and Bournemouth. Explore a little further and you will find spectacular gardens to visit and great golf to be enjoyed at Parkstone golf club.

MATERIAL INFORMATION

- Tenure – Share of freehold
- Length of Lease – 982 years remaining
- Maintenance – £1686.30 per half year.
- Management Agent – BLR Property Management LTD
- Parking – Garage and visitor parking
- Utilities – Mains Electric, Mains Water & Drainage.
- Broadband & Mobile Signal – Refer to Ofcom website
- Council Tax – Band E
- EPC Rating – D

KEY FEATURES

- NO FORWARD CHAIN
- TWO DOUBLE BEDROOMS
- EN-SUITE AND FAMILY BATHROOM
- GARAGE & VISITOR PARKING
- MODERN KITCHEN & UTILITY ROOM
- LARGE SOUTH FACING BALCONY
- FIRST FLOOR APARTMENT (LIFT ACCESS)
- CLOSE TO WESTBOURNE & BEACH
- TENURE - SHARE OF FREEHOLD
- COUNCIL TAX - BAND E

Energy Efficiency Rating				
	Current	Potential		
Very energy efficient - lower running costs				
(92+)	59	64		
A				
(81-91)				
B				
(69-80)				
C				
(55-68)				
D				
(39-54)				
E				
(21-38)				
F				
(1-20)				
G				
Not energy efficient - higher running costs				
England, Scotland & Wales				
EU Directive 2002/91/EC				

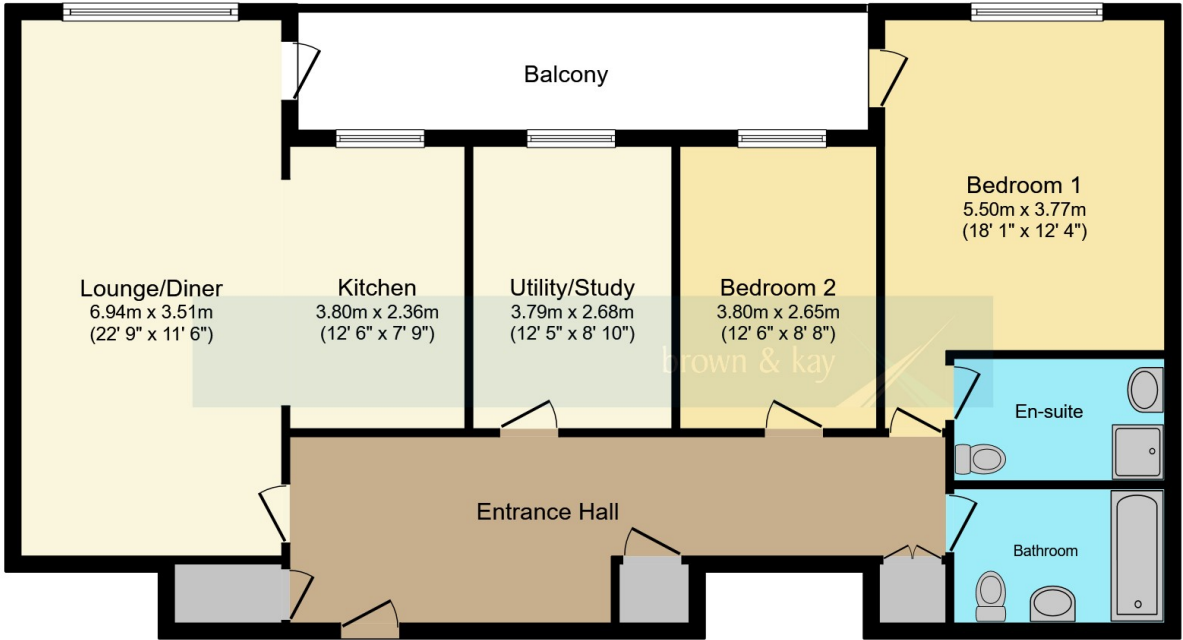

First Floor
Floor area 106.8 sq.m. (1,149 sq.ft.)

Total floor area: 106.8 sq.m. (1,149 sq.ft.)

This floor plan is for illustrative purposes only. It is not drawn to scale. Any measurements, floor areas (including any total floor area), openings and orientations are approximate. No details are guaranteed, they cannot be relied upon for any purpose and do not form any part of any agreement. No liability is taken for any error, omission or misstatement. A party must rely upon its own inspection(s). Powered by www.Propertybox.io