



Clover Cottage, Cloughbane Walk, Ramsey, Isle of Man. IM8 2JL

Spacious detached true bungalow in private setting with open aspects
offered with no onward chain



£275,000 Freehold

PROPERTY DESCRIPTION

Clover Cottage is a spacious true bungalow situated on a very quiet and private road on the South side of Ramsey. Offering generous living space and a blank canvas for your personal touch, Clover Cottage is ideal for those seeking peace, privacy, and lovely views.

Features include:

1/2 Bedrooms – a comfortable and versatile layout ready for your customization.

Open-reaching views – gaze over Ramsey towards the sea, providing a stunning backdrop every day.

Prime location – situated on a very quiet and private road, perfect for peaceful living.

TT vantage point – enjoy easy access to the famous Isle of Man TT races, with a vantage point of the mountain climb.

Newly built detached garage – complete with an electric door, offering secure parking and additional storage space.

This property is a unique opportunity to craft your own home in a sought-after location.

FEATURES

- Detached True Bungalow
- Private Woodland Setting
- Lounge plus Dining Room and Kitchen
- 2 Bedrooms plus Bathroom
- Newley Constructed Garage & Off Road Parking
- Tiered Rear Garden with TT Vantage Point
- No Onward Chain



Property Images

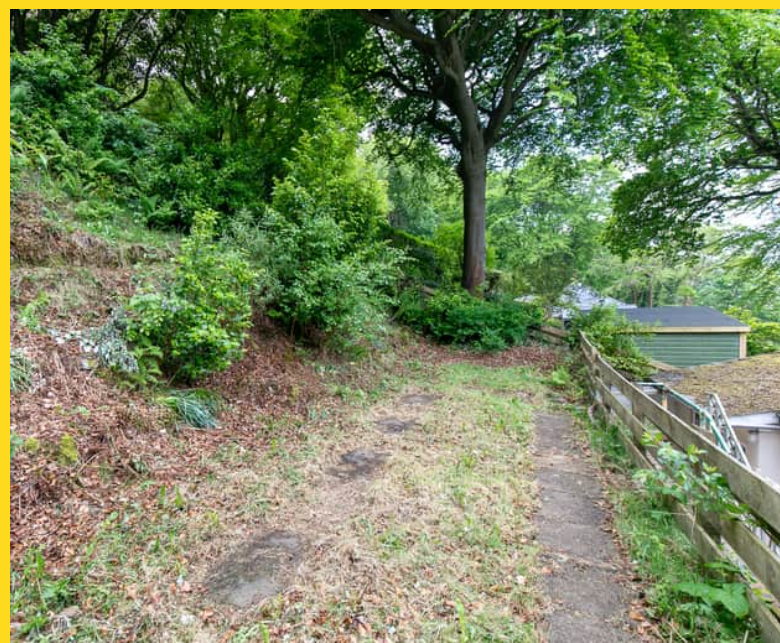

FLOORPLAN



GROUND FLOOR
703 sq.ft. (65.3 sq.m.) approx.

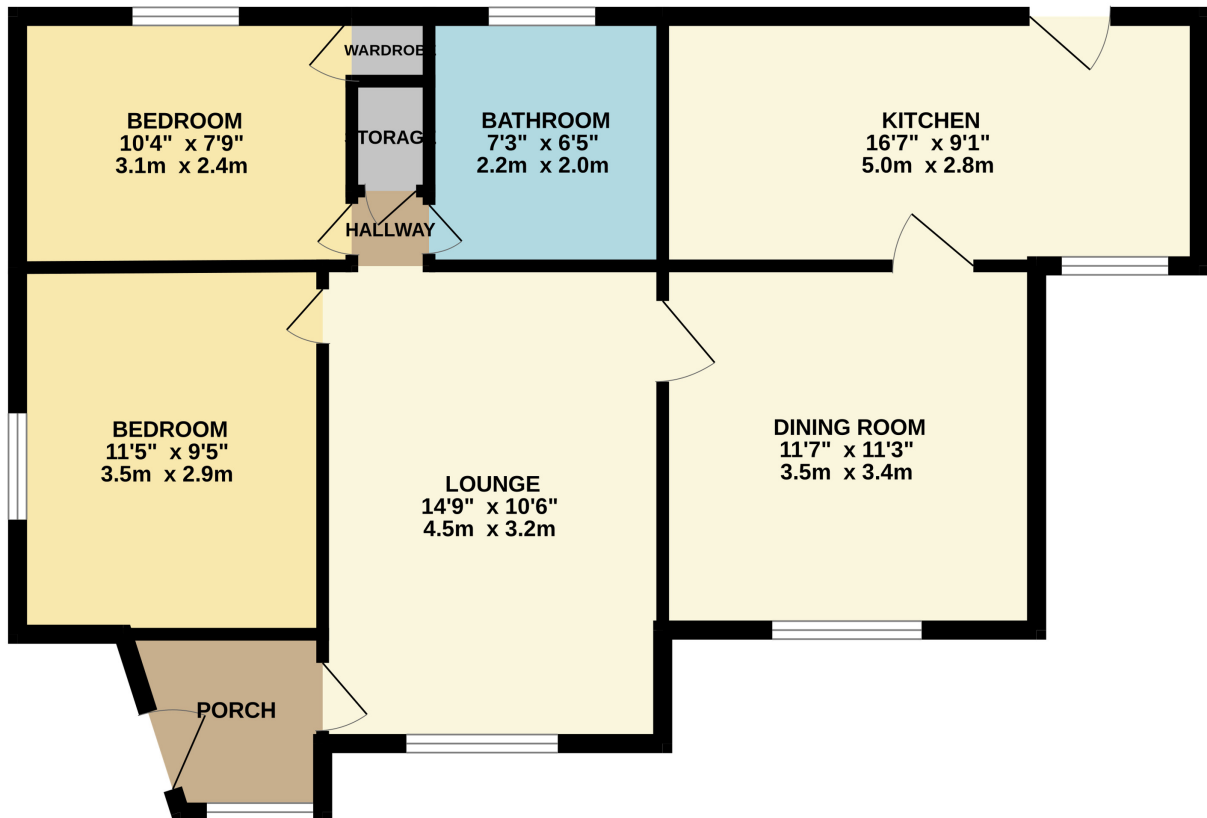

TOTAL FLOOR AREA: 703 sq.ft. (65.3 sq.m.) approx.

Whilst every attempt has been made to ensure the accuracy of the floorplan contained here, measurements of doors, windows, rooms and any other items are approximate and no responsibility is taken for any error, omission or mis-statement. This plan is for illustrative purposes only and should be used as such by any prospective purchaser. The services, systems and appliances shown have not been tested and no guarantee as to their operability or efficiency can be given.
Made with Metropix ©2025

DISCLAIMER: Whilst Manxmove Ltd believe that these details are correct, neither Manxmove Ltd or their clients guarantee their accuracy in any way. Consequently, these details are not to be used to form part of any legally binding contract. Prospective purchasers or tenants are advised to visit this property to satisfy themselves as to the correctness of these details. Please note, we use wide angle camera lenses in order to show as much of each room as possible. This is not intended to mislead any prospective purchasers or tenants in any way and an honest verbal description is always available prior to viewing if required.

Manxmove Estate Agents - Douglas
Victoria Road, Douglas, IM2 4HD
01624 619966
info@manxmove.im