



Flat 10, 165 Iverson Road, London, NW6 2RB

£540,000

- Spacious One Bedroom Apartment
- Purpose Built
- Tiled Bathroom
- Long Lease Remaining
- Top Floor Flat (with Lift)
- Balcony with Amazing Views
- Open Plan Kitchen / Living Room

Iverson Road NW6

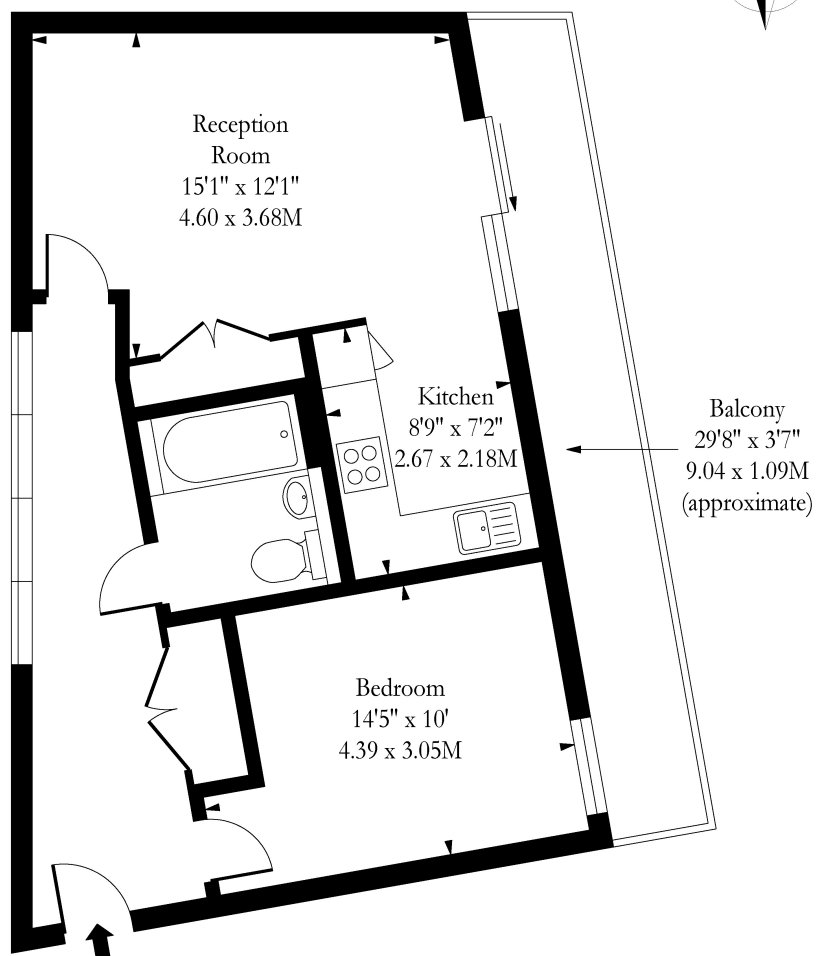
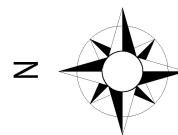

Fourth Floor

Approx Gross Internal Area

540 Sq Ft - 50.17 Sq M

Measured in accordance with RICS guidelines. Every attempt is made to ensure accuracy
However all measurements are approximate.
The floor plan is illustrative purposes only and is not to scale

www.tomekphotography.co.uk

