



Recently renovated and offered to the market with no onward chain inviting the possibility of a quick sale, this two bedroom semi-detached bungalow provides an excellent opportunity for first time buyers or even those looking to downsize in the area.

The property comprises 16ft bay-fronted living room, two double bedrooms, family bathroom and a very spacious 19ft kitchen diner overlooking the rear garden. There has also been a recent addition of a second WC. Externally, there is a low maintenance rear garden and garage to the side, as well as off street parking for two cars.

The property also has potential for future development including extensions at the rear and loft (STPP).

Situated a 5 minute walk from Langley Station, servicing Crossrail's Elizabeth Line into London, as well as local shops and amenities in Langley village, and many highly regarded schools including the ever-popular Langley Grammar School, the property provides everyday convenience.



Property Information

-  SEMI-DETACHED BUNGALOW
-  TWO DOUBLE BEDROOMS
-  BAY-FRONTED LIVING ROOM
-  LARGE REAR GARDEN WITH GARAGE
-  5 MINUTES FROM LANGLEY STATION
-  NO CHAIN
-  RECENTLY RENOVATED
-  SPACIOUS 19FT KITCHEN DINER
-  DRIVEWAY PARKING FOR 2 CARS
-  WALKING DISTANCE TO MANY SCHOOLS

x2
Bedrooms

x1
Reception Rooms

x2
Bathrooms

x2
Parking Spaces

Y
Garden

Y
Garage

Transport Links

NEAREST STATIONS:

- Langley - 480 yards
- Iver - 1.8 miles
- Slough - 1.9 miles

Local Schools

PRIMARY SCHOOLS:

- Langley Hall Primary Academy
480 yards
- The Langley Academy Primary
680 yards
- Marish Primary School
700 yards
- Ryvers School
0.6 miles
- The Langley Heritage Primary

0.6 miles

SECONDARY SCHOOLS:

- Langley Hall Arts Academy
200 yards
- The Langley Academy
530 yards
- Langley Grammar School
0.6 miles
- St Bernard's Catholic Grammar School
1.1 miles
- Ditton Park Academy
1.2 miles
- Council Tax**
Band D

Floor Plan



Alderbury Road
Approximate Floor Area = 66.32 Square meters / 713.86 Square feet
Garage Area = 11.76 Square meters / 126.58 Square feet
Total Area = 78.08 Square meters / 840.45 Square feet

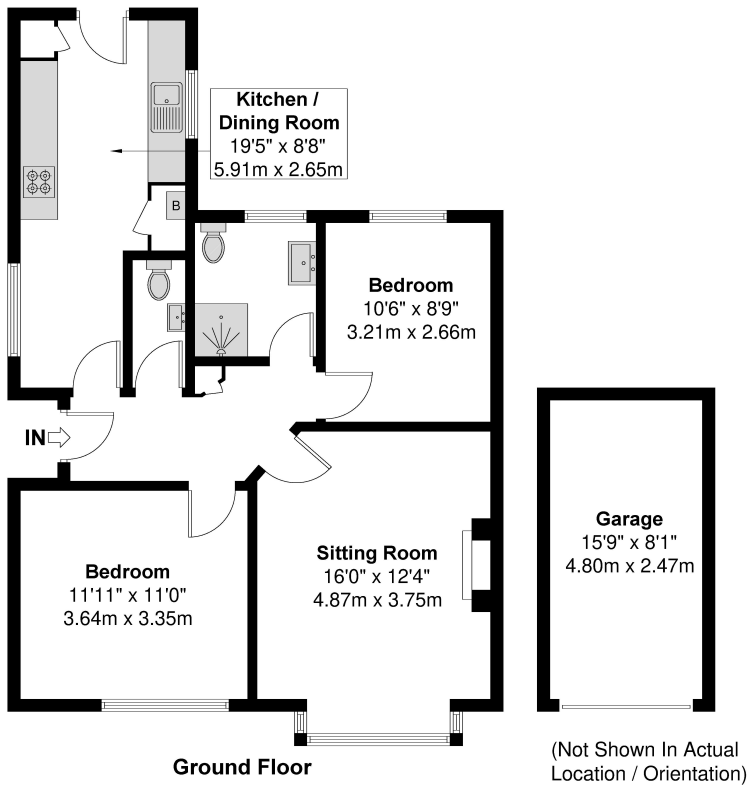

Illustration for identification purposes only,
measurements are approximate, not to scale.

Prospective purchasers should be aware that these sales particulars are intended as a general guide only and room sizes should not be relied upon for carpets or furnishing. We have not carried out any form of survey nor have we tested any appliance or services, mechanical or electrical. All maps are supplied by Goview.co.uk from Ordnance Survey mapping. Care has been taken in the preparation of these sales particulars, which are thought to be materially correct, although their accuracy is not guaranteed and they do not form part of any contract.

