



Day & Co
ESTATE AGENTS

28 Cavendish Street
Keighley
BD21 3RG



52 Exley Road, Keighley, West
Yorkshire, BD21 1LT

£350,000

T: 01535 664609

W: www.dayandcoestateagents.co.uk

E: keighley@dayandcoestateagents.co.uk

- MATURE DETACHED RESIDENCE
- THREE BEDROOMS
- GATED DRIVEWAY, SINGLE GARAGE

- SITUATED ON A LARGE PLOT
- TWO RECEPTION ROOMS
- EPC RATING E

SUMMARY

** INDIVIDUAL, MATURE DETACHED RESIDENCE SITUATED ON A LARGE PLOT (Approx .25 Acre), THREE BEDROOMS, TWO RECEPTION ROOMS, POPULAR RESIDENTIAL AREA, RARE OPPORTUNITY, EPC RATING E **

FULL DESCRIPTION

A rare opportunity to be able to purchase an elegant, mature stone detached residence of character and style in need of modernisation set on a large plot of approximately .25 of an acre. Delightfully situated in a popular suburb of Keighley with views across the Valley. This well established detached house offers accommodation across two floors and includes Double Glazing together with Gas Fired Central Heating. In brief the accommodation comprises -

Ground Floor - Entrance Porch, Hallway, Living Room with windows to the front and side elevations, Dining Room with Bay Window to the side and windows to the rear elevation, Kitchen with a range of units, worktops, sink, door and window to the rear.

Cellars

First Floor - Landing, Bedroom 1 can be found at the rear with windows to two elevations, Bedroom 2 can be found at the front with windows to two elevations, Bedroom 3 can be found at the front, Bathroom, Separate W.c..

A real feature of this desirable property is the large plot the property stands on which is mainly of lawn with borders which really must be viewed to be fully appreciated. Gated driveway to the side leading to a single garage.

Viewing strictly by appointment.

EPC Rating E

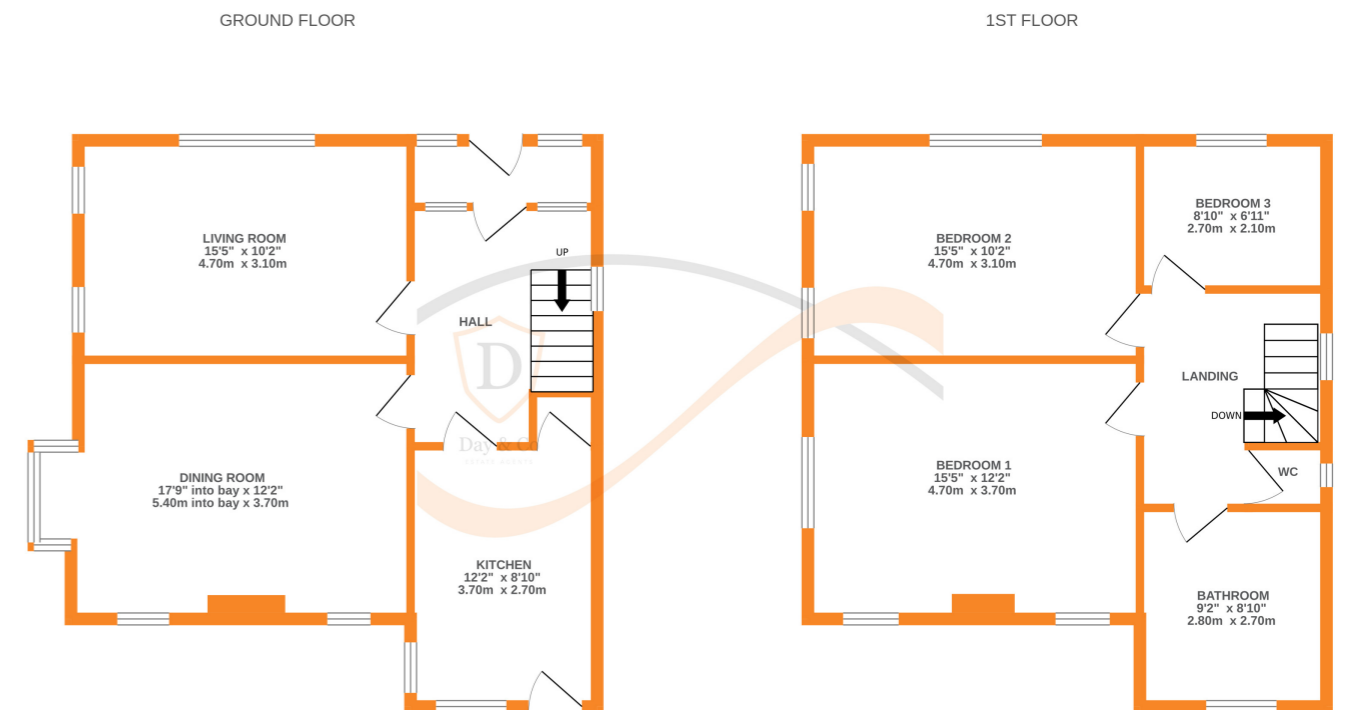

Whilst every attempt has been made to ensure the accuracy of the floorplan contained here, measurements of doors, windows, rooms and any other items are approximate and no responsibility is taken for any error, omission or mis-statement. This plan is for illustrative purposes only and should be used as such by any prospective purchaser. The services, systems and appliances shown have not been tested and no guarantee as to their operability or efficiency can be given.
Made with Metropix ©2023