



- GUIDE PRICE £325,000 - £350,000
- An Ideal First Time Purchase
- Semi-Detached House In A Popular Location In Halstead
- Three Bedrooms
- Kitchen/Breakfast Room
- Generous Living Room With Access To Garden
- Downstairs WC & Family Bathroom
- Generous Rear Garden
- Parking For Two Cars

**Nightingale Drive, Halstead, Essex. CO9 2FQ.**

Located on the sought-after Portway Place development, built by Bellway Homes, this modern three-bedroom semi-detached house presents an excellent opportunity for a professional couple or young family





# Property Details.

## Room Measurements

### Entrance Hall

### WC



### Kitchen/Breakfast Room



13' 09" x 8' 02" (4.19m x 2.49m)

### Lounge



15' 06" x 11' 11" (4.72m x 3.63m)

### Landing

### Bedroom One



14' 02" x 8' 06" (4.32m x 2.59m)

# Property Details.

## Bedroom Two



10' 08" x 8' 06" (3.25m x 2.59m)

## Bedroom Three



8' 09" x 6' 06" (2.67m x 1.98m)

## Family Bathroom



## Outside



Externally, the rear garden is of a generous size and offers a blank canvas for the new owners to make their own. To the side of the property, a private driveway provides off-road parking for two vehicles.

# Property Details.

## Floorplans

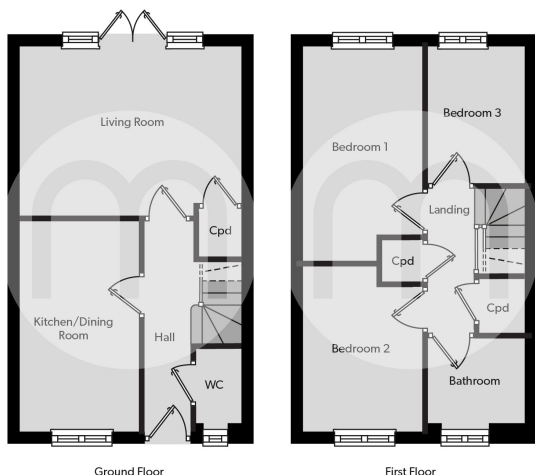

## Location

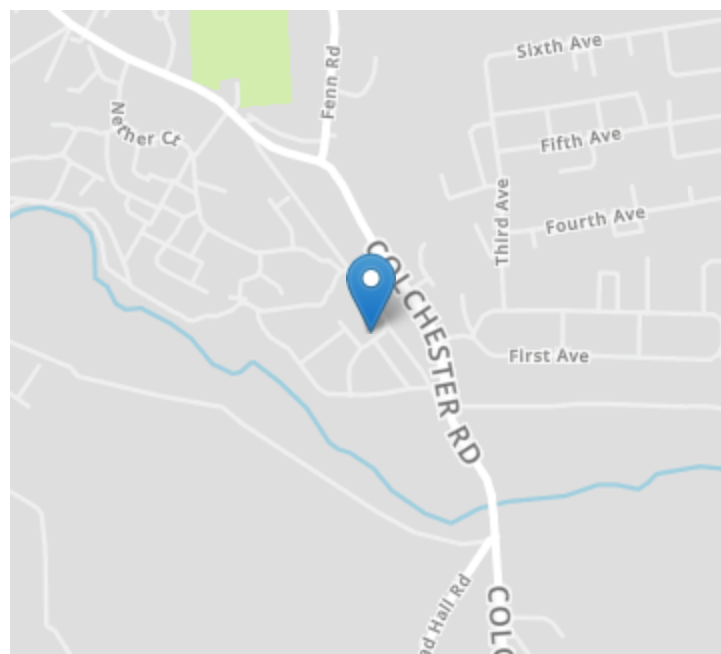

## Energy Ratings

We have not carried out a structural survey and the services, appliances and specific fittings have not been tested. All photographs, measurements, floor plans and distances referred to are given as a guide only and should not be relied upon for the purchase of carpets or any other fixtures or fittings. Gardens, roof terraces, balconies and communal gardens as well as tenure and lease details cannot have their accuracy guaranteed for intending purchasers. Lease details, service ground rent (where applicable) are given as a guide only and should be checked and confirmed by your solicitor prior to exchange of contracts.