

Regulated by:



RICS



Since 1989

Deceptively Spacious 3 Bedroom Town House. In the heart of the popular town of Cardigan.



5 Windsor Terrace Aberystwyth Road, Cardigan, Ceredigion. SA43 1LY.

Ref R/3685/ID

£245,000

**** Deceptively spacious 3 double bedroom town house ** Well presented accommodation ** Off-lying single garage ** convenient edge of town location ** Walking distance to town amenities ** Low maintenance rear garden ** mains gas central heating ** Double glazing throughout ****

The property comprises of Ent Hall, front lounge, dining room, kitchen, utility room, shower room. First floor, 3 double bedrooms, bathroom.

Conveniently positioned on the fringes of the town of Cardigan on the Teifi Estuary. The property enjoys views over Cardigan town and is well placed for an easy reach to major food retailers, bus service and the town centre with its excellent shopping, eating and educational facilities. Only a few miles inland from the Cardigan Bay coast.

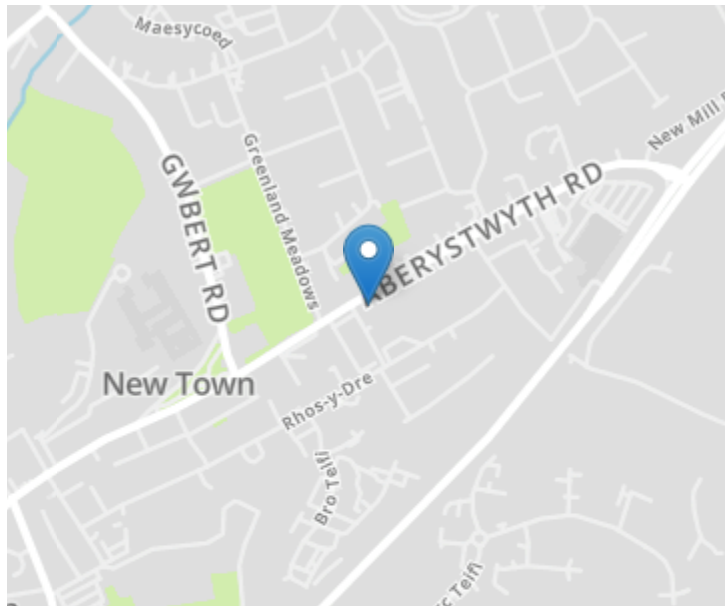

Rear Kitchen / Dining Room



Ground Floor

Front Vestibule

4' 1" x 4' 7" (1.24m x 1.40m) via UPVC door, mosaic tiles, half glazed hardwood door with light well above, into -

Entrance Hall

18' 3" x 6' 7" (5.56m x 2.01m) with stairs to first floor, central heating radiator, laminate flooring.



14' 9" x 11' 2" (4.50m x 3.40m) with a range of base cupboard units, Formica working surfaces above, 1 1/2 stainless steel drainer sink, gas oven and grill with 4 ring gas hob above, stainless steel extractor hood, tiled splashback, 2 x double glazed windows to side, space for automatic washing machine, space for fridge and freezer, door into pantry cupboard, central heating radiator.

Rear Utility / Laundry Room

11' 2" x 13' 6" (3.40m x 4.11m) with sliding doors to rear garden, laminate flooring, central heating radiator, 2 x double glazed window to side and rear.

Shower Room

6' 9" x 6' 5" (2.06m x 1.96m) comprising of a, enclosed shower with power shower above, pedestal, wash hand basin, low-level flush WC, frosted window to side, extractor fan.

First Floor

Split Landing

13' 1" x 6' 5" (3.99m x 1.96m) with access hatch to loft.

Front Principal Bedroom 1

Externally

To the Rear

A low maintenance and enclosed rear garden area being laid to patio slabs and gravel. Rear access on to path.



Outdoor Shed

10' 8" x 7' 4" (3.25m x 2.24m) window to front and side, power connected.



Off lying land and Garage

8' 5" x 15' 6" (2.57m x 4.72m) double doors to front.

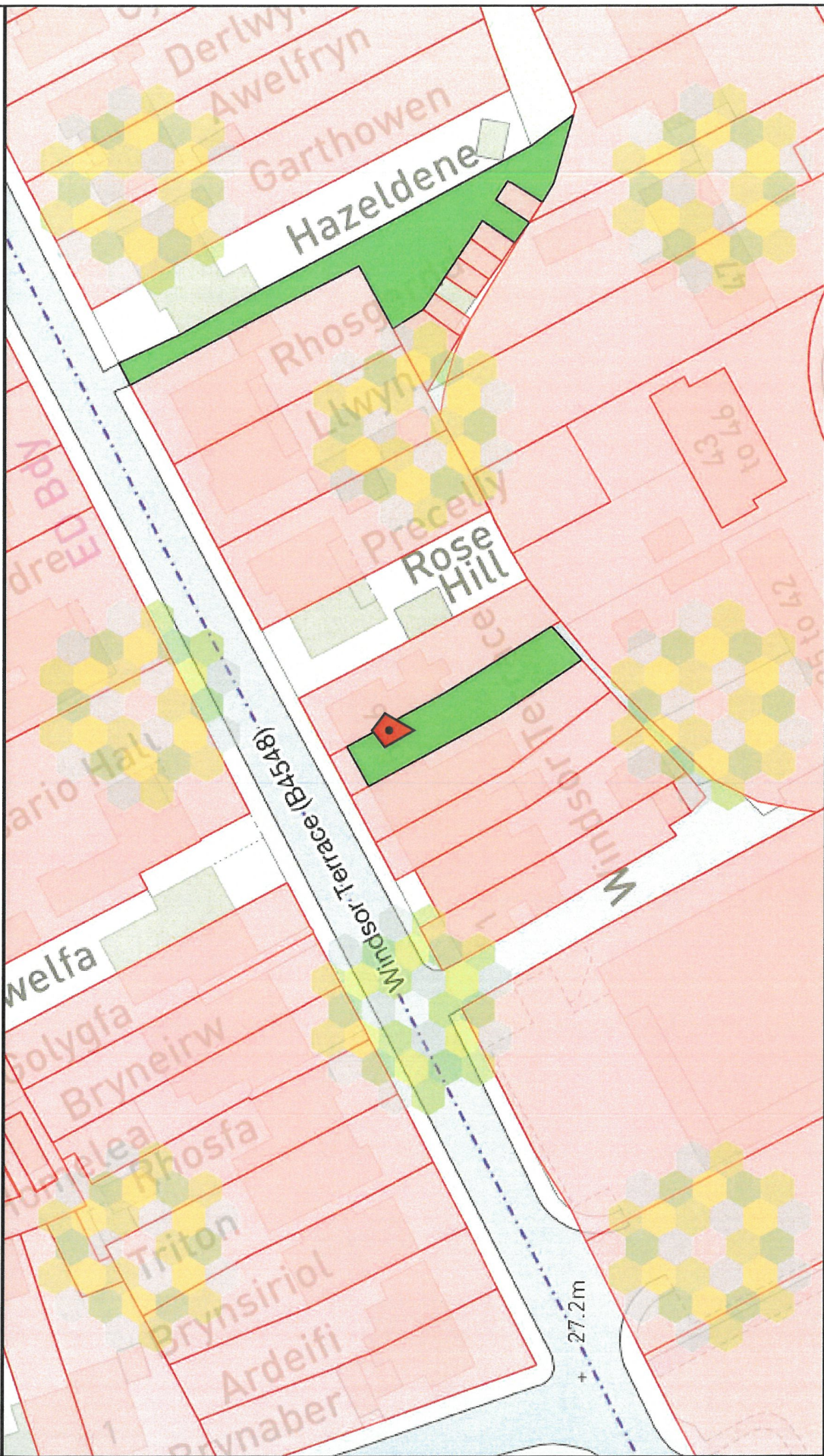

Map scale 1:625

© Crown copyright and database rights 2023 Ordnance Survey 100026316
 This map is for reference purposes only. You are not permitted to copy, sub-license, distribute or sell any of this data to third parties in any form.
 Data last updated 10:00pm 09 MAY, 2023

Ground Floor

Approx. 70.6 sq. metres (759.4 sq. feet)

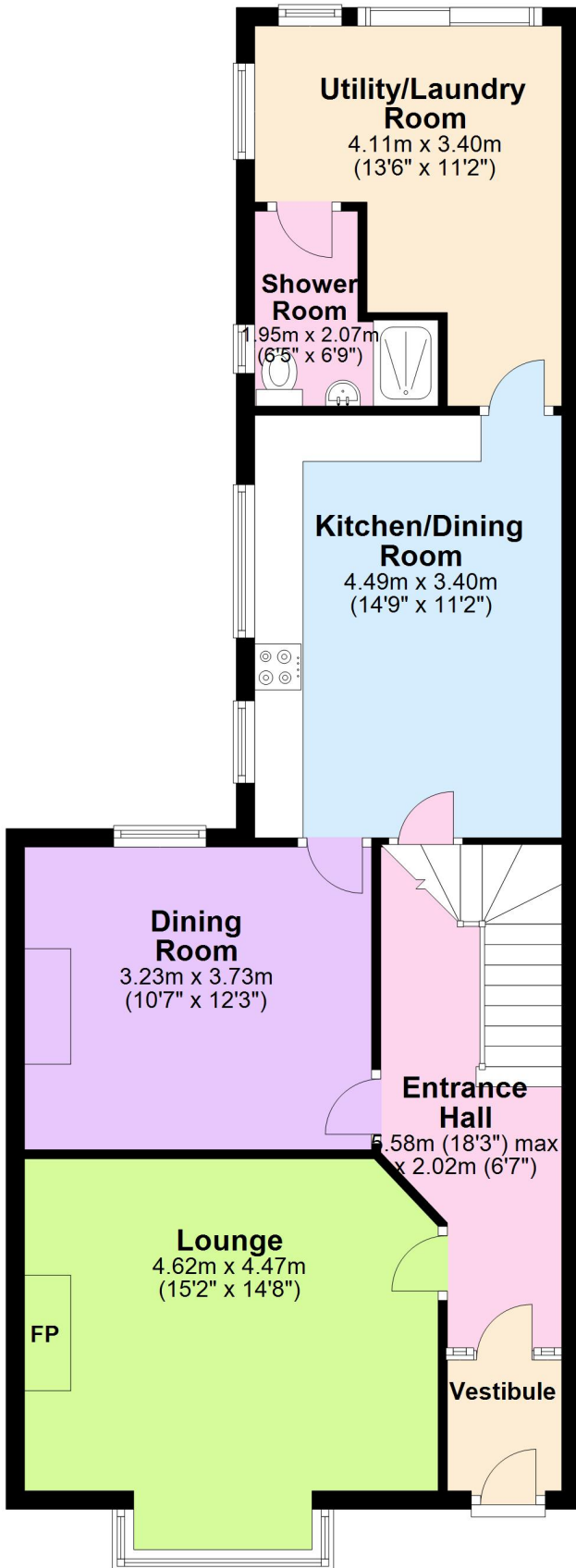

First Floor

Approx. 56.6 sq. metres (609.2 sq. feet)

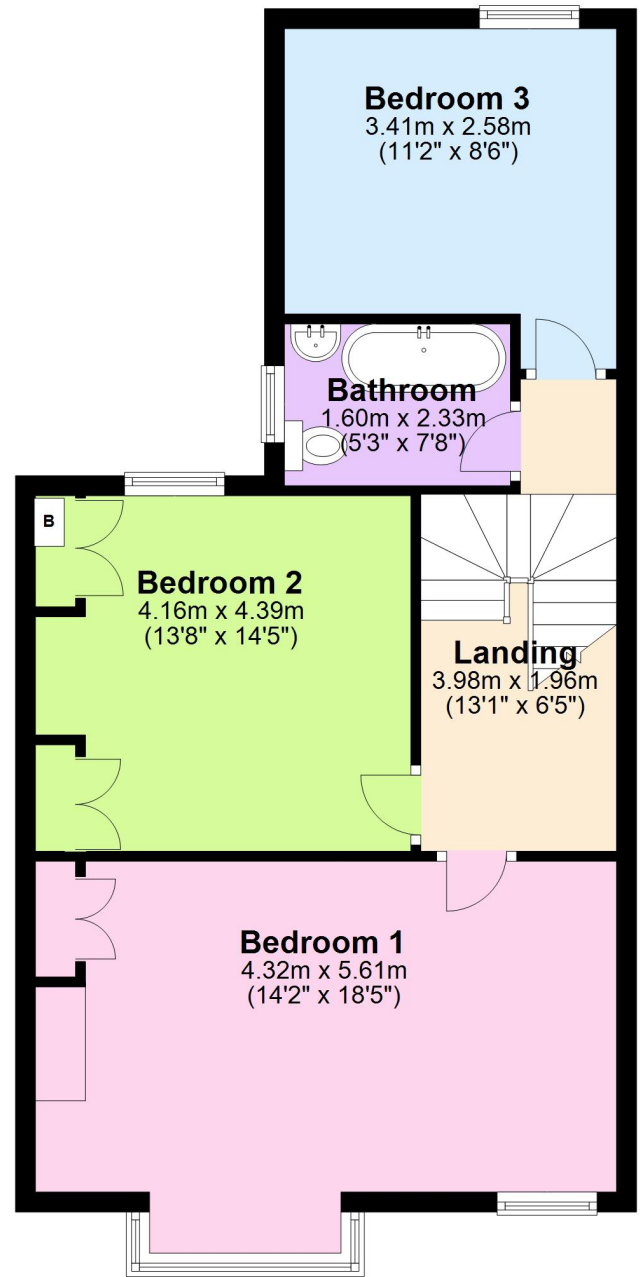

Total area: approx. 127.1 sq. metres (1368.6 sq. feet)

The Floor plans are for guidance only.
Plan produced using PlanUp.

5 Windsor Terrace , Aberystwyth Road, Cardigan