



**7, Firdale Road**  
Northwich CW8 4AZ

**£800**

**[www.westates.co.uk](http://www.westates.co.uk)**  
**01606 331784**





- Mid-Terrace Mews
- Good Size Living Room
- Kitchen Dining Room
- Two Good size Bedrooms
- Modern Bathroom
- Private Gardens
- Parking Space

### Description

A mid-terrace mews style property, located on the popular Firdale Park development. The property has recently been upgraded, featuring a brand new kitchen and is offered in excellent decorative condition throughout. With gas central heating and PVCu double glazing, the accommodation comprises: Entrance hall with built-in cloaks cupboard, good size living room, kitchen breakfast room, first floor landing, two good size bedrooms and a modern bathroom. Externally there is a long front garden, a private rear garden and there is an allocated parking space. Immediately available, restrictions apply.





**Location**  
**Tenure**

**EPC Rating:**

**Important Notes**  
Type Here





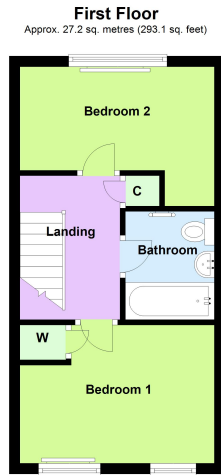
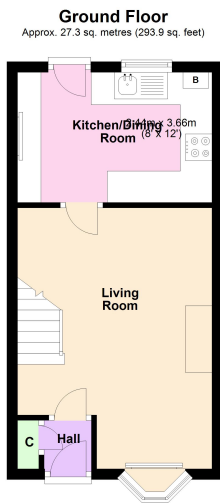

Total area: approx. 54.5 sq. metres (587.1 sq. feet)

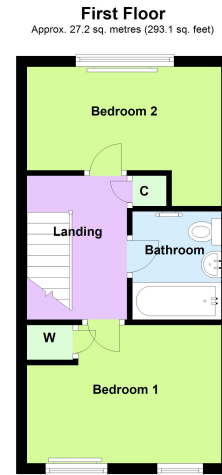
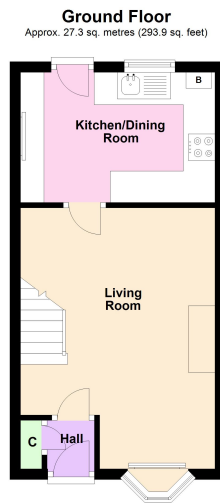

Total area: approx. 54.5 sq. metres (587.1 sq. feet)



These particulars, whilst believed to be accurate are set out as a general outline only for guidance and do not constitute any part of an offer or contract. Intending purchasers should not rely on them as statements of representation of fact, but must satisfy themselves by inspection or otherwise as to their accuracy. All measurements quoted are approximate. We are unable to confirm the working order of any fixtures and fittings including appliances that are included in these particulars. No person in this firm's employment has the authority to make or give any representation or warranty in respect of the property.