



Leythe Road, London, W3 8AW

**Cow & Co**  
LONDON



Guide Price £2600 - £2850 PCM. Presented for sale in excellent decorative condition throughout, and with the benefit of no onward chain this stunning a modern two bedroom two bathroom home has been exquisitely designed.

Leythe Road is located in this attractive residential area just off Acton Lane, within walking distance of the transport and shopping amenities of Acton High Road. For Overground services South Acton station is a five minute walk away and is only a ten minute walk from Acton Town underground station on the Piccadilly line.

The facilities of Chiswick High Road are also easily accessible being a short bus ride away on the E3 route.

There are also good road links out of town via the M4.



- \*Available now\*
- Stunning two double bedroom ground floor period apartment
- Refurbished to a high specification throughout
- Direct access onto a lovely landscaped and low maintenance private garden
- Sleek open plan kitchen with integrated appliances
- Excellent bathroom
- Additional shower room
- Bright and spacious throughout
- Internal courtyard

# Leythe Road

Approx. Gross Internal Area  
66 Sq M - 709 Sq Ft

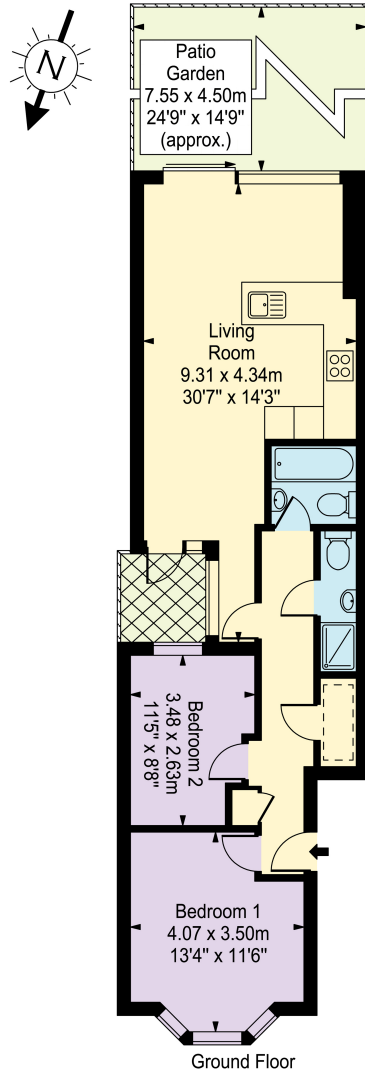

Every attempt is made to assure accuracy, however measurements are approximate and for illustrative purposes only. Not to scale.  
Floor plan by [www.frameworkphotos.co.uk](http://www.frameworkphotos.co.uk)

Agents note: All measurements are approximate and whilst every attempt has been made to ensure accuracy they are for general guidance only and must not be relied on. The fixture and fittings referred to have not been tested and therefore no guarantee can be given that they are in working order. Internal photographs are reproduced for general information and it must not be inferred that any item shown is included with the property.

Tel: 0208 065 0010  
Email: [thehub@cowandco-london.com](mailto:thehub@cowandco-london.com)  
Web: [cowandco-london.com](http://cowandco-london.com)

**Cow & Co**  
LONDON