



**Central House
Lampton Road
Hounslow
Greater London
TW3 1HY**

Offers in Excess of £192,000

bettermove

Lampton Road Hounslow

Bettermove are proud to present this Ground Floor Studio Apartment in Hounslow, available with no forward chain and welcoming cash buyers only.

The property benefits from double glazing, electric throughout and external parking available to hire. The council tax band is C.

This is a leasehold property with 989 years remaining on the lease; the ground rent is £455 per annum and the service charges are £1,183 per annum.

Located in the popular residential area of Hounslow, the property is close to a range of amenities, including shops, supermarkets, restaurants and pubs. Excellent transport connections can be found from Hounslow Central Station and many local bus routes.

This exciting opportunity should not be missed! All enquiries can be made through Bettermove on 0330 004 0050.



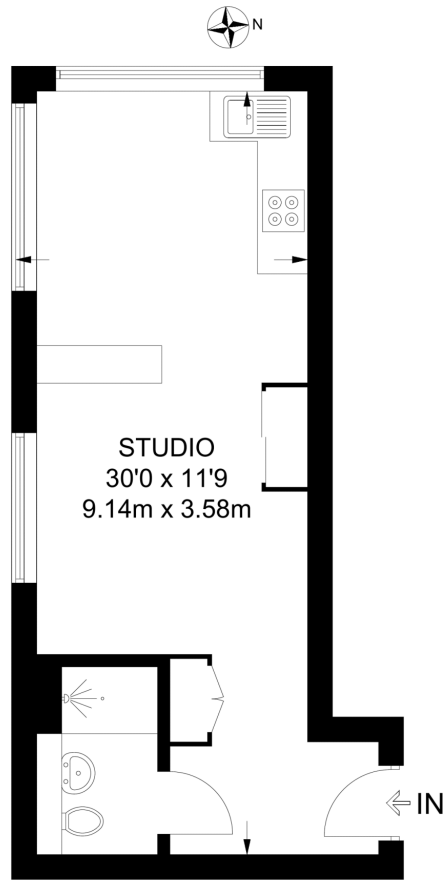

GROUND FLOOR

APPROXIMATE GROSS INTERNAL AREA
334 SQ FT / 31.0 SQ M

This plan has been drawn for illustrative and identification purposes only.

Energy Efficiency Rating		
	Current	Potential
<i>Very energy efficient - lower running costs</i>		
(92+) A		
(81-91) B		
(69-80) C	73	73
(55-68) D		
(39-54) E		
(21-38) F		
(1-20) G		
<i>Not energy efficient - higher running costs</i>		
England, Scotland & Wales		
	EU Directive 2002/91/EC	

Environmental Impact (CO ₂) Rating		
	Current	Potential
<i>Very environmentally friendly - lower CO₂ emissions</i>		
(92+) A		
(81-91) B		
(69-80) C	79	79
(55-68) D		
(39-54) E		
(21-38) F		
(1-20) G		
<i>Not environmentally friendly - higher CO₂ emissions</i>		
England, Scotland & Wales		
	EU Directive 2002/91/EC	

20-22 Bridge End, Leeds, LS1 4DJ
t: 0330 004 0050 e: hello@bettermove.co.uk
www.bettermove.co.uk