



Tewkesbury

01684 293246



7 North East Terrace, East Street, Tewkesbury, GL20 5NT

A delightful Grade II listed town centre cottage with the advantage of a private rear garden and 3 bedrooms.

Using every inch of available space, this is a cleverly planned home. Converted from what was formerly the old Stocking Factory, this little piece of Tewkesbury's history is surprisingly spacious.

From the kitchen with integrated gas hob, electric oven and extractor over, to the lounge with attractive fireplace, it oozes character and charm. Completing the accommodation on the ground floor is a useful WC.

Another surprise are the three bedrooms. On the first floor are two bedrooms and bathroom with shower over the bath, wc and pedestal basin.

Whilst on the second floor is a further double bedroom with study/dressing area.



Outside the rear garden is designed with low maintenance in mind and has the advantage of gated rear access.

The property is located within the delightful private cul du sac which is accessed under the archway from East Street and within easy walking distance of the High Street and the range of shops and amenities offering by the town.

Tewkesbury is an excellent commuter base with the motorway and rail networks close by. It enjoys a wide range of sport, culture, education and health facilities and is a popular tourist centre.



Ground Floor

Lounge 13'2"x9'6"
 Kitchen/Dining Room 13'2"x9'6"Max
 WC

First Floor

Bedroom 1 13'7"x9'6" Max
 Bedroom 3 7'2"x6'9"
 Bathroom 7'7"x6'9"

Second Floor

Bedroom 2 9'6"x7'5"
 Large landing/study area 8'4"x6'10"

Outside

Rear garden with gated rear access

Tewkesbury Borough Council Tax Band A

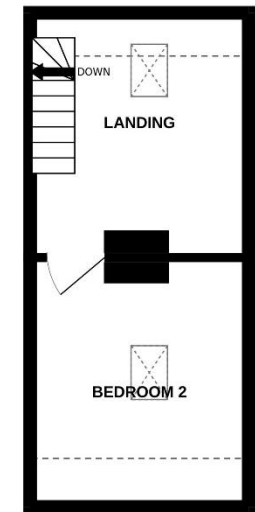
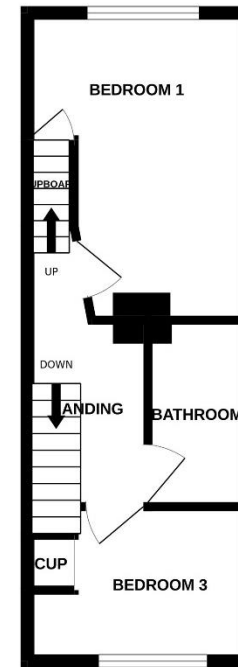
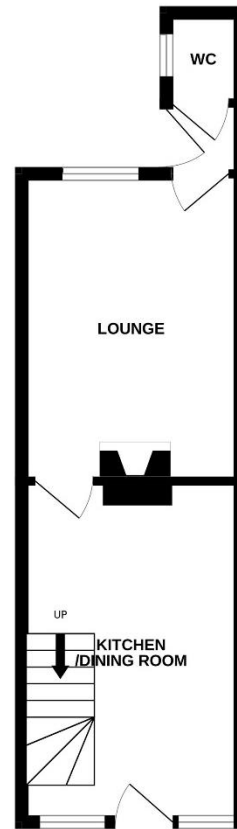

Guide Price £185,000 Freehold

Viewing strictly by arrangement with Engall Castle Ltd
 155 High Street Tewkesbury Gloucestershire GL20 5JP
 Office hours: Mon – Fri 9am to 5.30pm, Sat 9am to 2pm
 email: sales@engallcastle.com

01684 293 246
www.engallcastle.com

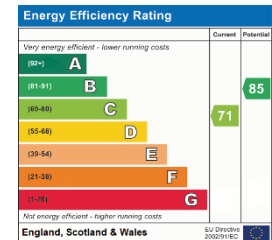

This floorplan is provided for guidance only as an approximate layout of the property and should not be relied upon as a statement of fact.

Agents Note

These property details are set out as a general outline only and do not constitute any part of an Offer or Contract. Any services equipment, fittings or central heating systems have not been tested and no warranty is given or implied by Engall Castle Ltd that these are in working order. Buyers are advised to obtain verification from their solicitor or surveyor. Fixtures and fittings or other items are not included unless specifically described. All measurements, distances and areas are approximate and for guidance only and should not be relied upon for the purposes of fitting carpets or furniture etc. These property details and all statements within this document are provided without responsibility on behalf of Engall Castle Ltd or its employees or representatives and should not be relied on as statements of fact. Prospective purchasers must satisfy themselves as to the accuracy of all details pertaining to the property.

