







A two bedroom apartment set in a most popular 'West End' location, ready for the new owner to put their own stamp on. The property benefits from light and spacious accommodation with the most splendid views over the Channel. ACCOMMODATION COMPRISES: Easy steps leading to communal entrance door, communal entrance hall, stairs and lift to third floor, communal landing, Apartment entrance door leading to entrance hall, kitchen/dining/sitting room, bedroom one, bedroom two, bathroom. NO CHAIN. EPC Rating: C



**Guide Price £180,000**

**Tenure** Leasehold

**Property Type** Apartment

**Receptions** 1

**Bedrooms** 2

**Bathrooms** 1

**Heating** Electric

**EPC Rating** C

**Council Tax** Band C

Folkestone And Hythe District Council



**Ground floor**  
**Communal entrance hall**

Stairs and lift to:

**Third floor**  
**Communal landing**

Door to apartment

**Entrance hall**  
Kitchen being open plan to:

**Kitchen/dining/sitting room**  
22' 3" x 14' 7" (6.78m x 4.45m)

**Bedroom one**  
13' 9" x 10' 8" (4.19m x 3.25m)

**Bedroom two**  
15' 6" x 8' 11" (4.72m x 2.72m)

**Additional information**  
Leasehold: Approximately 980 years remaining.  
Service charge: Approximately £2241.82 per annum  
Ground rent: £250.00 per annum



Approximate Gross Internal Area = 63 sq m / 679 sq ft

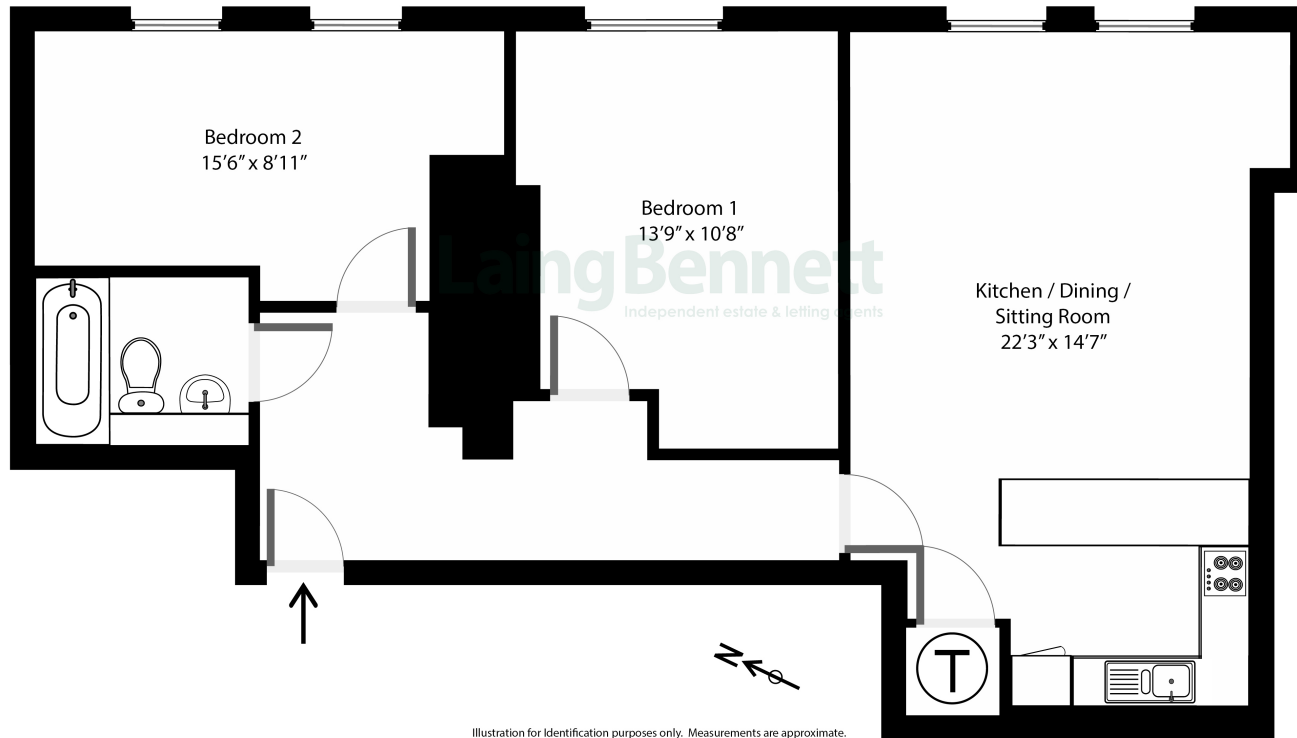
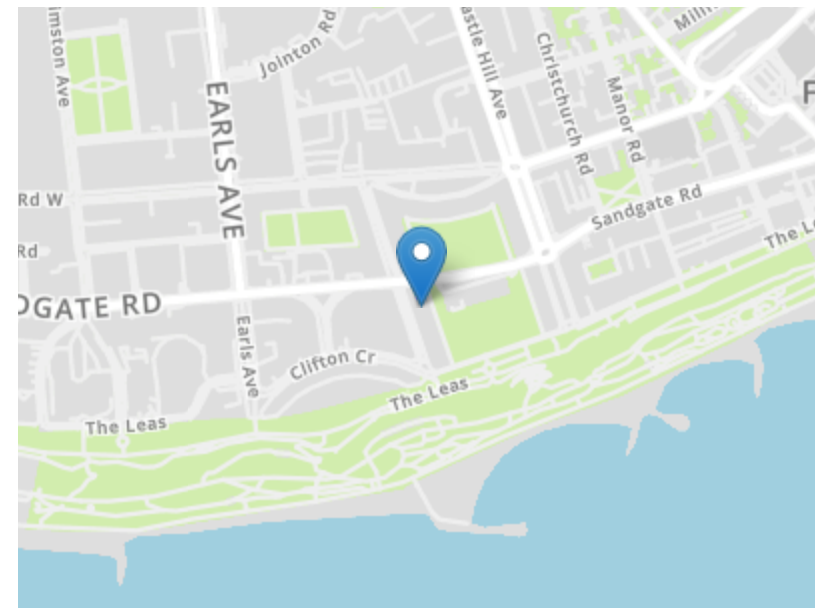

Illustration for identification purposes only. Measurements are approximate. Not to scale. Outbuildings are not shown in actual location.



Need to book a viewing?

If you would like to book a viewing please contact our office on 01303 863393 or email [sales@laingbennett.co.uk](mailto:sales@laingbennett.co.uk)

See all our properties at



[www.laingbennett.co.uk](http://www.laingbennett.co.uk)

The Estate Office  
8 Station Road  
Lyminge  
Folkestone  
Kent  
CT18 8HP

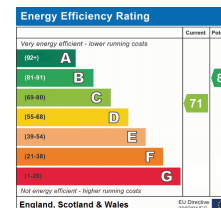

These property details are intended to give a fair description and give guidance to prospective Purchaser/Tenant. They do not constitute an offer or contract of Sale/Tenancy and all measurements are approximate. While every care has been taken in the preparation of these details neither Laing Bennett Ltd nor the Vendor/ Landlord accept any liability for any statement contained herein. Laing Bennett Ltd has not tested any services, appliances, equipment or facilities, and nothing in these details should be deemed to be a statement that they are in good working order or that the property is in good structural condition or otherwise. We advise all applicants to commission the appropriate investigations before Exchange of Contracts/entering into a Tenancy Agreement. It should not be assumed that any contents/furnishing, furniture etc. photographed are included in the Sale/Tenancy, nor that the property remains as displayed in the photographs. No person in the employment of Laing Bennett Ltd has authority to make or give any representation or warranty whatever in relation to this property.