



Queen street

Wilshire Court | Hitchin | Herts | SG4 9TT

www.stonegate-estates.co.uk



QUEEN STREET

Property Description

Situated in a sought-after development in Hitchin town centre, this spacious ground floor retirement apartment offers convenience, comfort, and independence, all within a short walk to local shops, cafes, and amenities.

The property features two generous double bedrooms, a modern shower room, a fitted kitchen, and a bright, well-proportioned living room with French doors opening onto a patio area – perfect for enjoying the outdoors.

Designed with ease of living in mind, the development benefits from a lift to all floors, on-site laundry facilities, a welcoming residents' lounge, and the reassurance of a Development Manager.

Parking is available for residents, and the apartment is offered with no onward chain, making it an ideal move-in ready home. This is a fantastic opportunity to join a friendly retirement community in an unbeatable central location.

Key Features:

Two double bedrooms

Ground floor position with patio via French doors

Fitted kitchen and modern shower room

Residents' lounge and laundry room

Development Manager and lift access

Parking available

No onward chain

Prime location – short walk into Hitchin town centre

£295,000 Leasehold



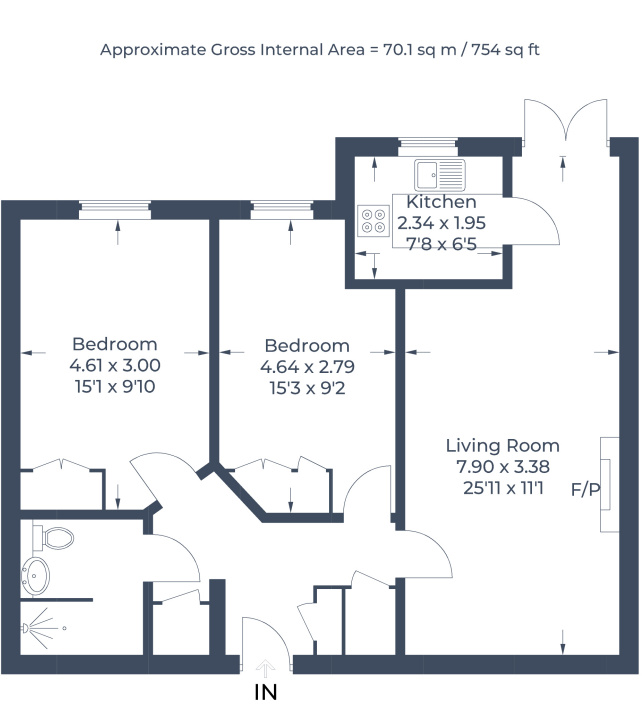

Illustration for identification purposes only,
measurements are approximate, not to scale.
© CJ Property Marketing Produced for Stonegate Estates





- No Chain
- Two Bedroom Apartment
- Ground Floor
- Shower Room
- Retirement Apartment
- Residence Lounge
- Parking

EPC Rating: C

Stonegate Estate Agents

01462 438979

sales@stonegate-estates.co.uk | www.stonegate-estates.co.uk

