

# Crane & Co



## Price Guide

£900,000 - £950,000

High Meadow, Cross in Hand, Heathfield, East Sussex TN21 0SR

🏠 5 Bedroom 🚿 3 Bathroom 📺 2 Reception

📞 01323 440678

✉️ [sales@craneandco.co.uk](mailto:sales@craneandco.co.uk)

# High Meadow, Cross in Hand, Heathfield, East Sussex TN21 0SR

Price Guide  
£900,000 - £950,000  
Freehold

5 Bedroom 3 Bathroom 2 Reception

PRICE GUIDE £900,000 - £950,000

WATCH THE FILM AND 3D TOUR and view EXPERT PHOTOGRAPHY at [craneandco.co.uk](http://craneandco.co.uk) (ALL PROVIDED FREE FOR ALL OUR SELLERS)

A home that truly has it all. Simply stunning from the very first glance, this beautiful five-bedroom detached family home perfectly blends stylish, contemporary living with exceptional craftsmanship and thoughtful design. Every element has been carefully considered and expertly finished to create a home that is as practical as it is breathtaking. Step inside and you'll immediately feel a sense of calm and comfort - that wonderful feeling of 'home'. After a long, busy day, this is where the world slows down, where you can breathe, relax and truly unwind. It's not just a place to live, it's a lifestyle. The heart of the home is the impressive open plan kitchen, dining, and family room. Bathed in natural light, it's a space designed for both entertaining and everyday life. Whether you're enjoying a lazy Sunday breakfast with the family or hosting evenings with friends, this room adapts beautifully to every occasion. The kitchen itself is a masterpiece of design blending timeless elegance with modern functionality. Sleek worktops, bespoke cabinetry, and quality appliances combine with warm oak finishes to create a space that's both stylish and inviting. The adjoining utility room adds that all important practicality, keeping the main living area effortlessly organised and clutter free. Just off the main living space, you'll find a cosy TV snug room, the perfect spot for more relaxed moments. Whether it's movie nights with the family, a quiet evening with a good book, or simply somewhere to unwind and to enjoy downtime together. For indoor/outdoor living on sunny days, throw open the French doors and step out into the beautifully landscaped formal garden. Here, you'll find an outdoor bar and stylish entertaining area and extension of your living space during the warmer months. Whether it's summer barbecues, evening drinks, or quiet mornings with a coffee, this garden is made for making memories. The mature gardens are a true highlight of the home. Lush lawns, beautifully planted borders, and magnificent, well established trees wrap around the property, creating a wonderful sense of privacy and seclusion. A charming kitchen garden adds a delightful touch ideal for those who enjoy growing their own herbs, fruit, and vegetables. It's a peaceful, sunlit space that invites you to step outside, slow down, and connect with nature. Bedrooms have been designed for rest and relaxation. The master suite is a true sanctuary, generously sized and beautifully finished, it features bespoke fitted wardrobes and a luxurious en-suite shower room. Four further bedrooms provide plenty of space for family, guests, or even a home office, while two additional bathrooms ensure that everyone has their own space. Approached via a sweeping, gated driveway, the home makes an immediate impression. There's ample parking for family and visitors alike, along with a garage for added convenience. The sense of privacy and prestige begins the moment you arrive and continues throughout the entire property. The complete package This home really does tick every box from the stunning interior design to the generous outdoor space, it's a perfect balance of style, comfort, and practicality. We invite you to come and experience it for yourself but make sure to allow a little extra time for your visit. There's so much to see, and even more to fall in love with.

## Room Sizes

Entrance Hallway  
Kitchen/Living area - 25' 7" x 19' 2"  
Utility Room - 10' 5" x 7' 9"  
Bedroom 3 - 12' 8" x 8' 7"  
Living Room - 16' 3" x 11' 3"  
Bathroom  
Bedroom 1 - 13' 6" x 11' 6"  
En Suite  
Bedroom 4 - 11' 9" x 7' 10"  
1st Floor  
Bedroom 2 - 16' 8" x 9' 5"  
Bedroom 5 - 7' 11" x 7' 4"  
Bathroom  
Outside  
Garage - 15' 0" x 8' 0"

High Meadow, Cross in Hand, Heathfield, East Sussex TN21 0SR

Crane & Co

Main Features

01323 440678 sales@craneandco.co.uk craneandco.co.uk

# High Meadow, Cross in Hand, Heathfield, East Sussex TN21 0SR

Price Guide  
£900,000 - £950,000  
Freehold

5 Bedroom 3 Bathroom 2 Reception

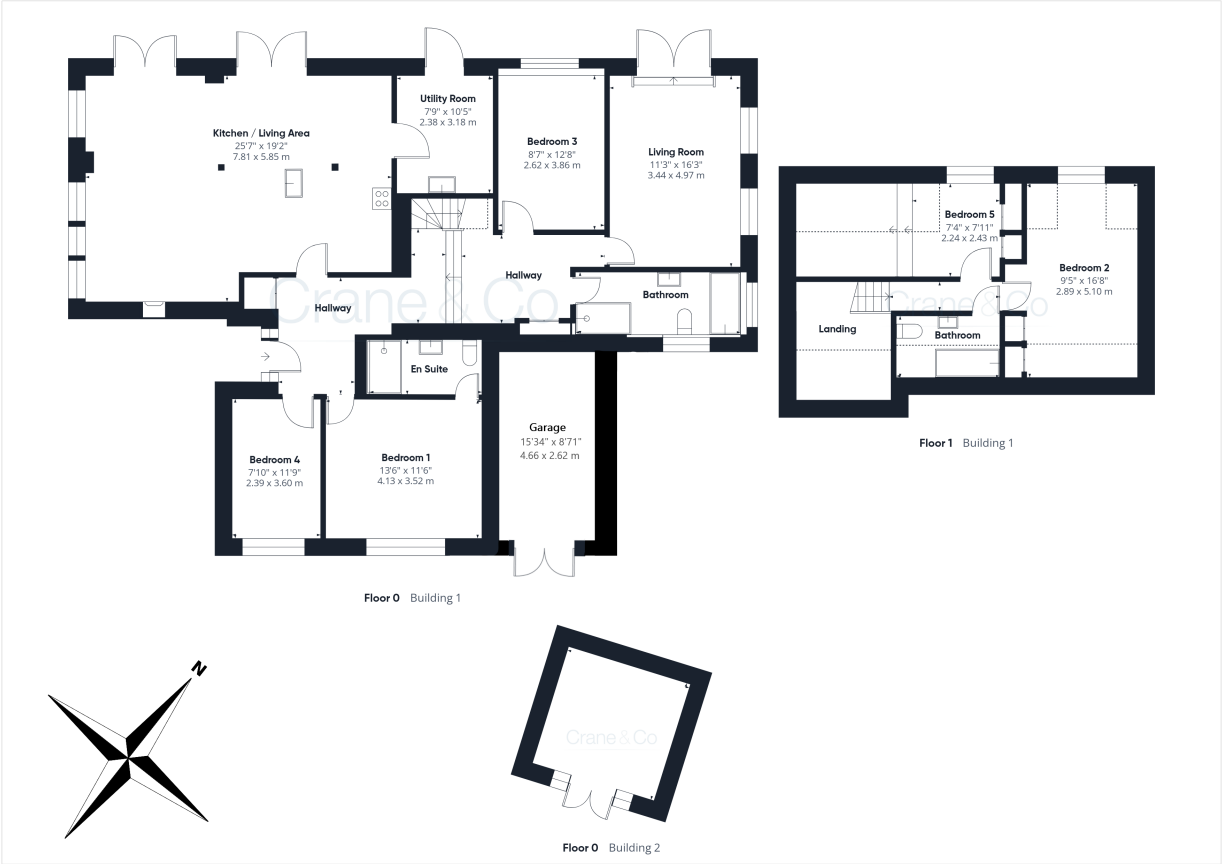



Crane & Co

High Meadow, Cross in Hand, Heathfield, East Sussex TN21 0SR

☎ 01323 440678 ✉ [sales@craneandco.co.uk](mailto:sales@craneandco.co.uk) 🌐 [craneandco.co.uk](https://www.craneandco.co.uk)



Crane & Co

High Meadow, Cross in Hand, Heathfield, East Sussex TN21 0SR

☎ 01323 440678 ✉ sales@craneandco.co.uk 🌐 craneandco.co.uk

# High Meadow, Cross in Hand, Heathfield, East Sussex TN21 0SR

5 Bedroom 3 Bathroom 2 Reception

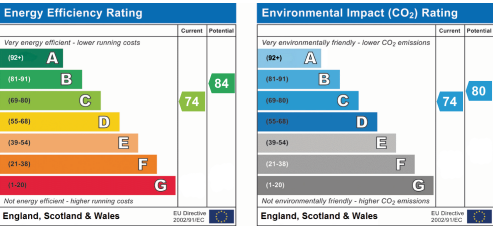
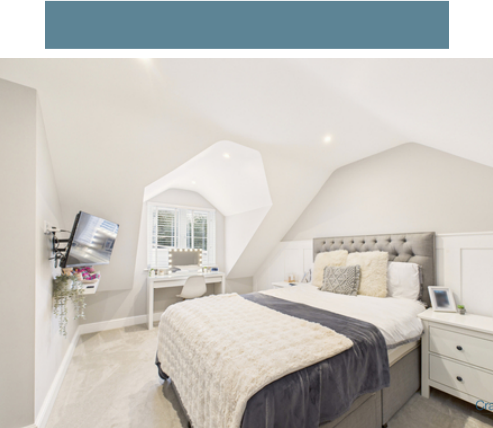
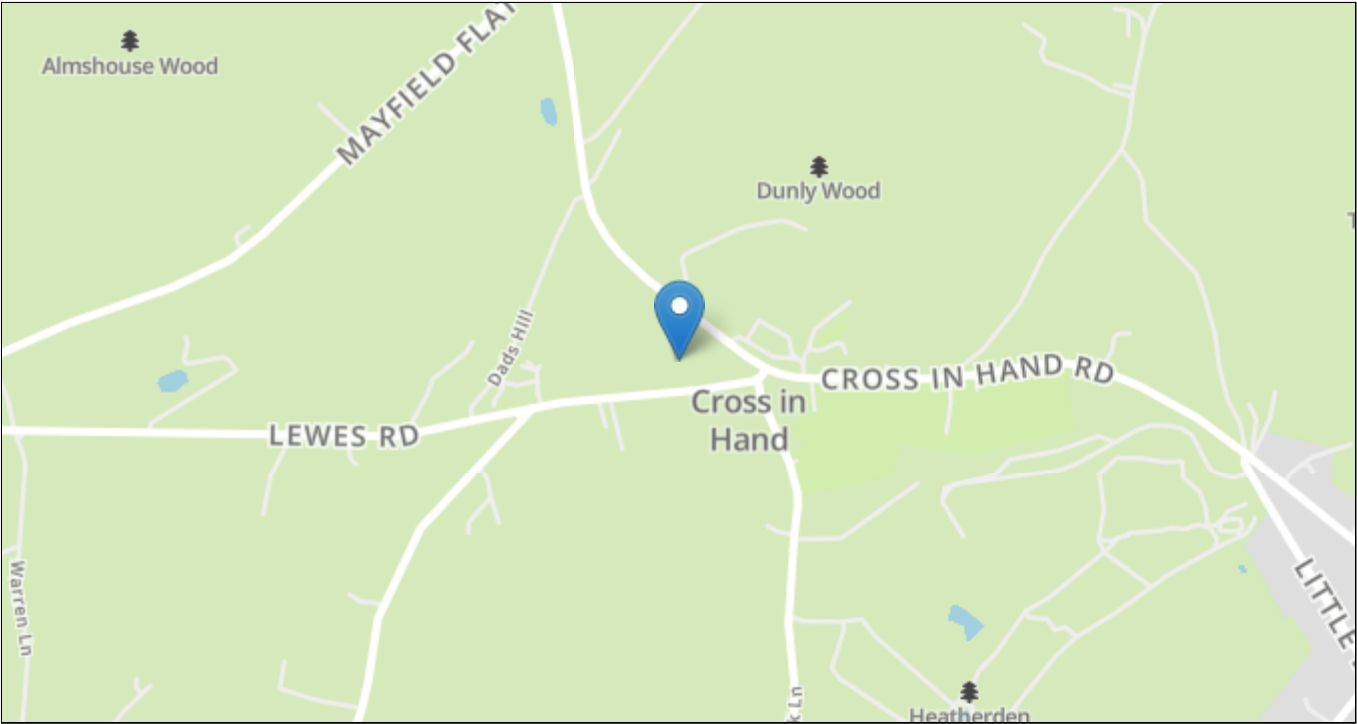

Price Guide  
£900,000 - £950,000  
Freehold

Crane & Co

Sales particulars are intended only as general guidance. The Company therefore gives notice that none of the material issued or visual depictions of any kind made on behalf of the Company can be relied upon as accurately describing any of the Specified Matters prescribed by any Order made under the Property Misdescriptions Act 1991. Nor do they constitute a contract, part of a contract or a warranty. You should obtain clarification on any matters or information that are important to you.