

## 2 West Street

Dover  
CT17 0DU

**£180,000 FREEHOLD**

Draft Details...FOR SALE THROUGH BURNAP + ABEL...Price Range £180,000 - £190,000...Ideal Two-Bedroom Terraced House – Chain-Free with Off-Road Parking and Garden | Double Glazing | Gas Central Heating | Perfect for First-Time Buyers or Investors | This well-maintained two-bedroom terraced house is a fantastic opportunity for first-time buyers or buy-to-let investors, offered to the market chain-free. The property features a modern style kitchen and bathroom, double glazing and gas central heating, ensuring year-round comfort. Additional highlights include off-road parking and a private garden, making it a practical and appealing home. Located in close proximity to local schools and shops, this home offers convenience, comfort, and great value in a popular residential area. For your chance to view call sole agents Buranp + Abel on 01304 279107.





Lounge

11' 1" x 10' 2" (3.38m x 3.10m)

Dining Room

12' 8" x 11' 1" (3.86m x 3.38m)

Bathroom

10' 6" x 5' 4" (3.20m x 1.63m)

Bedroom One

11' 2" x 10' 8" (3.40m x 3.25m)

Bedroom Two

11' 1" x 10' 3" (3.38m x 3.12m)

Garden

Off Street Parking

Area Information

Situated close to Dover Town Centre with its range of amenities including shopping, educational and recreational facilities together with the Docks and seafront offering regular ferry crossings to The Continent and within easy access of the St James' Retail Park. The property is on the main bus route and there are several primary and secondary schools are dotted around the town. The nearby A2 dual carriageway offers a fast connection to the Cathedral City of Canterbury. Dover Priory mainline railway station offers excellent fast speed connections to the capital.

Ground Floor  
Approx. 30.6 sq. metres (329.9 sq. feet)

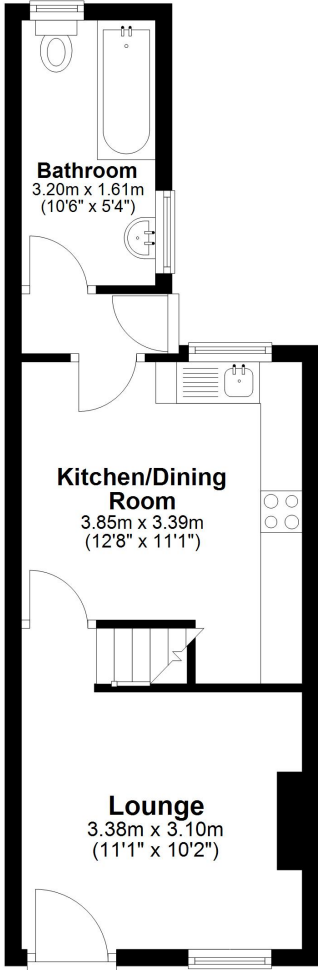

First Floor  
Approx. 24.3 sq. metres (261.3 sq. feet)

