



5 Chalice Way, Greenhithe, Kent, DA9 9PR
£230,000 Leasehold



Description

New To The Market! Guide Price £230,000-£240,000

Well presented ground floor two bedroom flat situated just a short walk from Stones Crossing Station. Ideal for first time buyers, Bluewater/hospital staff or buy to let investors. Use our online diary to request your viewing!

Situated on the popular Saxon Park, which is only minutes from Bluewater Shopping Centre, easy access to Darenth Valley Hospital the country park has excellent woodland walks and surrounded by horse paddocks. The proximity to Bluewater Shopping Centre and Darenth Valley Hospital has become popular for local employees and shoppers who want to take advantage of the walking distance shops, restaurants, cafes and bars. Greenhithe Village is only a short walk away with ASDA supermarket and the trading estate. Greenhithe Village is known for its historic pubs which over look the Thames and have views of Dartford Bridge. For London Commuters, Stone Crossing Station is approximately 300m away, Dartford Main Line Station is approx. 2.4 miles away which is also within the Oyster Zone and Ebbsfleet International Station is approximately 4.1 miles away which has 17 minutes into St Pancras or 10 minutes to Stratford. The A2 and M25 networks are only a short driveaway for easy access to travel to London, Stansted or Gatwick Airport and coastal routes.

GROUND FLOOR 567 sq.ft. (52.7 sq.m.) approx.

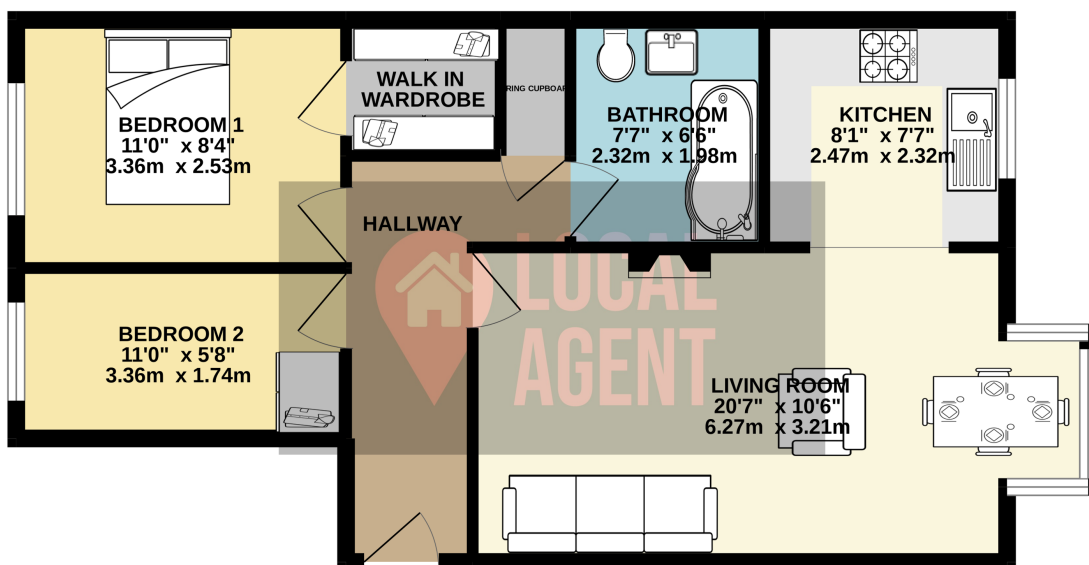

TOTAL FLOOR AREA : 567 sq.ft. (52.7 sq.m.) approx.

Whilst every attempt has been made to ensure the accuracy of the floorplan contained here, measurements of doors, windows, rooms and any other items are approximate and no responsibility is taken for any error, omission or mis-statement. This plan is for illustrative purposes only and should be used as a guide only.