



Set on a good sized plot, this three double bedroom detached bungalow provides spacious and flexible living accommodation. The layout features a modern kitchen/breakfast room, a living room with feature fireplace and patio doors on to the garden, three double bedrooms and a family bathroom. The rear garden is fully enclosed and laid to lawn and to the front there is a large driveway with parking for multiple cars as well as a detached 18ft garage. This property is offered to the market with NO CHAIN allowing the possibility of a quick sale and is an excellent family purchase due to its generous size and convenient location and planning permission has been granted for a side and rear extension, reference number: 18/01488/FULL.



## Property Information

-  NO CHAIN
-  DETACHED BUNGALOW
-  DRIVEWAY PARKING
-  EPC - PENDING
-  PLANNING PERMISSION GRANTED - 18/01488/FULL
-  THREE BEDROOMS
-  DETACHED GARAGE
-  GARDEN
-  COUNCIL TAX F

					
<b>x3</b>	<b>x1</b>	<b>x1</b>	<b>x2</b>	<b>Y</b>	<b>Y</b>
<b>Bedrooms</b>	<b>Reception Rooms</b>	<b>Bathrooms</b>	<b>Parking Spaces</b>	<b>Garden</b>	<b>Garage</b>

## Floor Plan

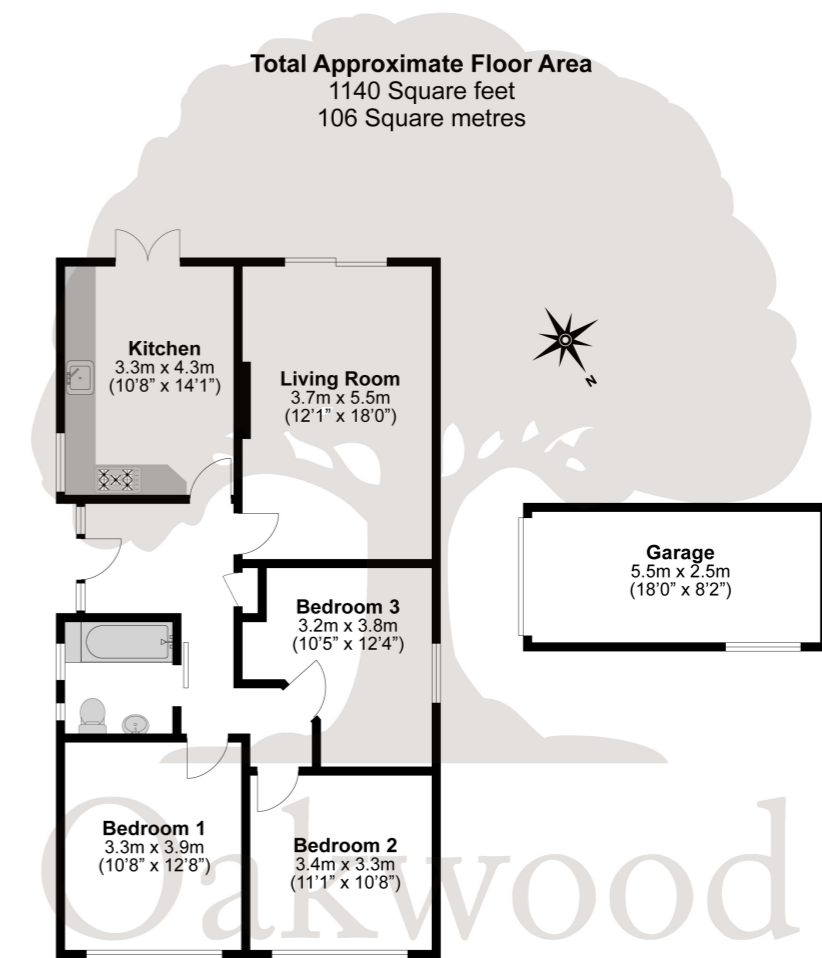

**Illustrations are for identification purposes only, measurements are approximate, not to scale.**

Prospective purchasers should be aware that these sales particulars are intended as a general guide only and room sizes should not be relied upon for carpets or furnishing. We have not carried out any form of survey nor have we tested any appliance or services, mechanical or electrical. All maps are supplied by Goview.co.uk from Ordnance Survey mapping. Care has been taken in the preparation of these sales particulars, which are thought to be materially correct, although their accuracy is not guaranteed and they do not form part of any contract.

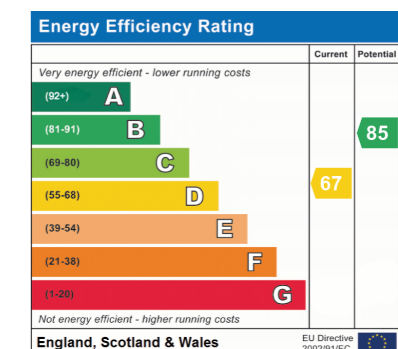
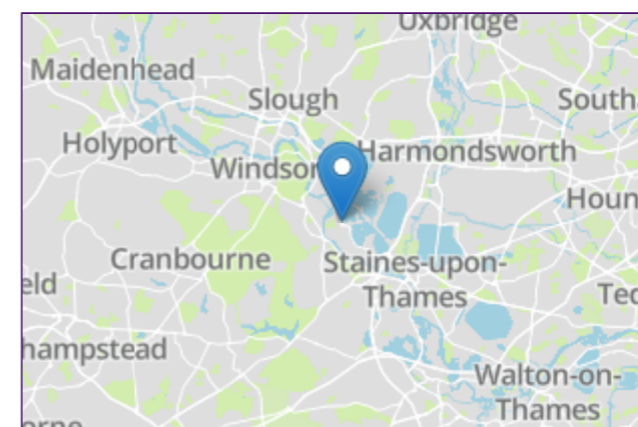

### External

Driveway parking, rear garden laid to lawn, detached garage.

### Schools

#### PRIMARY SCHOOLS:

Wraysbury Primary School

0.1 miles away

State school

King's Court First School

5.2 miles away

State school

St John's Beaumont School

5.1 mile away

Independent school

St Peter's Church of England Middle School

5.1 miles away

State school

Bishopsgate School

5.3 miles away

Independent school

#### SECONDARY SCHOOLS:

St John's Beaumont School

5.1 mile away

Independent school

St Peter's Church of England Middle School

5.1 miles away

State school

Bishopsgate School

5.3 miles away

Independent school

Churchmead Church of England (VA) School

2.7 miles away

State school

St Peter's Centre

4.9 miles away

State school

### Transport Links

Nearest stations:

Sunnymeads (0.9 miles)

Wraysbury (1.2 miles)

Datchet (2.6 miles)

### Council Tax

Band F