

PAUL ALEXANDER  
MORTGAGE CONSULTANTS

For all insurance and mortgage needs,  
please call Paul Alexander Mortgage Consultants  
on 020 8997 3915

LONDON'S LOCAL AGENT  
[enquiries@orchardsoflondon.com](mailto:enquiries@orchardsoflondon.com)  
020 3962 6000 | [orchardsoflondon.com](http://orchardsoflondon.com)  
Westworld West Gate London W5 1DT

## ROSEMONT ROAD

£1,600 pcm

- Two double bedrooms
- Modern eat-in kitchen
- Smart bathroom
- Stylish reception room
- Off street parking
- Lift service
- Excellent condition
- Walking distance to Acton High Street and Churchfield Road
- Within easy reach of Acton Main line station and Acton Town

LONDON'S LOCAL AGENT  
[enquiries@orchardsoflondon.com](mailto:enquiries@orchardsoflondon.com)  
020 3962 6000 | [orchardsoflondon.com](http://orchardsoflondon.com)  
Westworld West Gate London W5 1DT







Orchards of London are delighted to offer to the market for let, a beautifully presented two double bedroom flat in a prime Acton location. Rosemont Court is set back in a leafy suburb, walking distance to Acton's vibrant town centre and excellent local schools. The property boasts a bright front facing reception room with an abundance of natural light, an elegant master bedroom, a further second large double bedroom and a smart family bathroom.

Within the property you will also find a superb fitted kitchen/diner with integrated appliances and lovely breakfast area. Rosemont Court has the added benefit of off street parking. An incoming tenant would benefit

from being walking distance to Acton Town (District/Piccadilly) and Acton Mainline stations, as well as having the green spaces of Springfield Park on their doorstep.



Approximate Gross Internal Area = 66.3 sq m / 714 sq ft

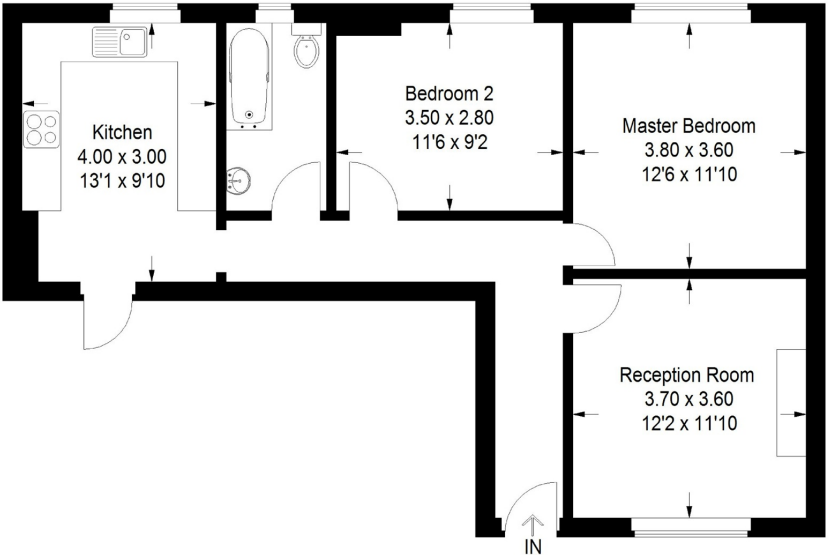

Illustration for identification purposes only, measurements are approximate, not to scale.  
FloorplansUsketch.com © 2014 (ID136946)