



17, Ravenswood
Northwich CW8 1NW

£475,000

www.westates.co.uk
01606 331784



An exceptional family home, in cul-de-sac location with large gardens, which are not overlooked and extremely private.

- Well Proportioned Family Home
- Three Reception Rooms
- Luxury Kitchen
- Conservatory
- Four Bedrooms
- Two Bath/Shower Rooms
- Large, Mature Gardens
- Double Garage & Driveway

Description

This is a great family home, it's located on a small cul-de-sac with a large rear garden, that backs on to the A556 Northwich bypass and is therefore not overlooked. The house itself is offered in good decorative order and features gas central heating and PVCu double glazing, comprises: Entrance hall, cloakroom/WC, study, dual aspect lounge, open plan kitchen dining room and conservatory on the ground floor and a landing, four good size bedrooms, a re-fitted en-suite shower room and bathroom on the first floor. Outside to the front there is an open plan garden and double width driveway which leads to a detached double garage. The gardens to the rear are mature and extremely private.



Location

Hartford is a bustling Cheshire village with an excellent range of local facilities including a hub of shops at its centre, offering everything you could want or need. There are three public house's in the village, The Red Lion, The Coachman and the Hartford Hall Hotel, in addition there are two wine bars/bistros; Chime, located in the heart of the village and The Hart of Hartford, which is located on School Lane. Two railway stations serve the village with the West Coast Main Line service running through Hartford, enabling access to London within two hours. Trains to Manchester and Chester run from Greenbank station. The A556 and A49 easily facilitate access to the region's major road network with Manchester and Liverpool airports both within 20 miles. The well regarded Grange private school is less than a mile away and both Hartford High and St Nicholas Catholic High School are within walking distance as are the four village primary schools; Hartford Primary School, St Wilfrid's Catholic Primary School, Hartford Manor Community School and the private Grange primary School. Nearby Northwich caters for a more comprehensive range of amenities, including leading supermarkets with Waitrose, Sainsbury's and Tesco all represented.

Tenure

FREEHOLD

EPC Rating: D



Ground Floor

Approx. 68.8 sq. metres (740.1 sq. feet)

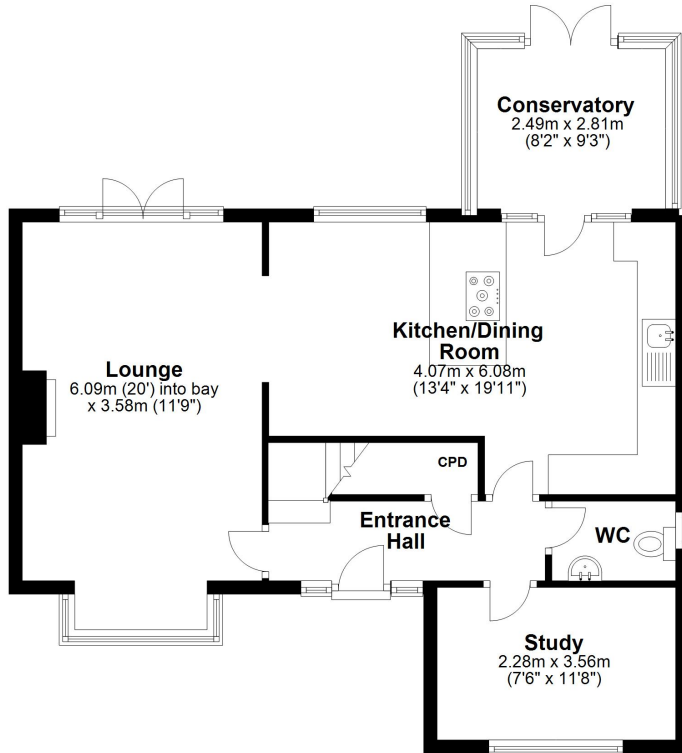

First Floor

Approx. 61.0 sq. metres (656.6 sq. feet)

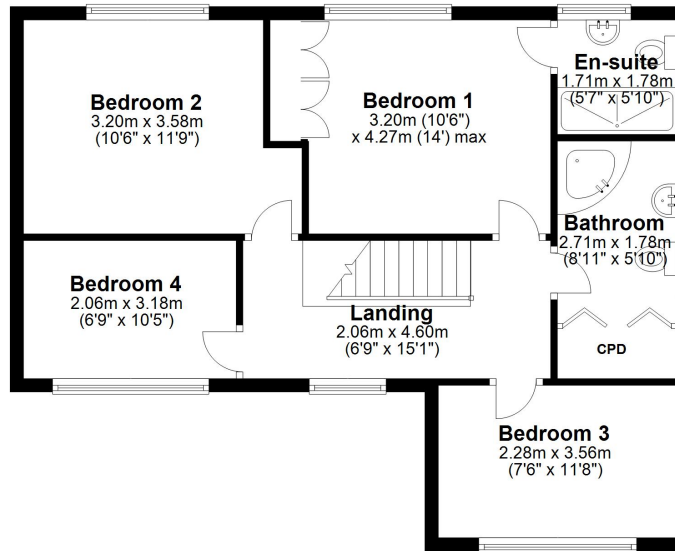

Total area: approx. 129.8 sq. metres (1396.7 sq. feet)



Boomin

These particulars, whilst believed to be accurate are set out as a general outline only for guidance and do not constitute any part of an offer or contract. Intending purchasers should not rely on them as statements of representation of fact, but must satisfy themselves by inspection or otherwise as to their accuracy. All measurements quoted are approximate. We are unable to confirm the working order of any fixtures and fittings including appliances that are included in these particulars. No person in this firm's employment has the authority to make or give any representation or warranty in respect of the property.