

FOR SALE

£295,000

Periwood Crescent, Perivale, Greenford, Greater London. UB6



Peter Gamble and Company offer to the market this perfectly located ground floor, 1 BEDROOM apartment with PATIO GARDEN

Situated on the Carey built Woodlands development, the property sits just 4 minutes walk to Perivale's Central Line tube station with local bus routes, shops and local nature sites all on the doorstep.

Allocated parking space is right by the entrance to the property.

The property boasts a good sized double bedroom with built-in wardrobes, separate bathroom suite with bath and shower, hallway storage cupboards, and well proportioned open-plan, living space, and kitchen.





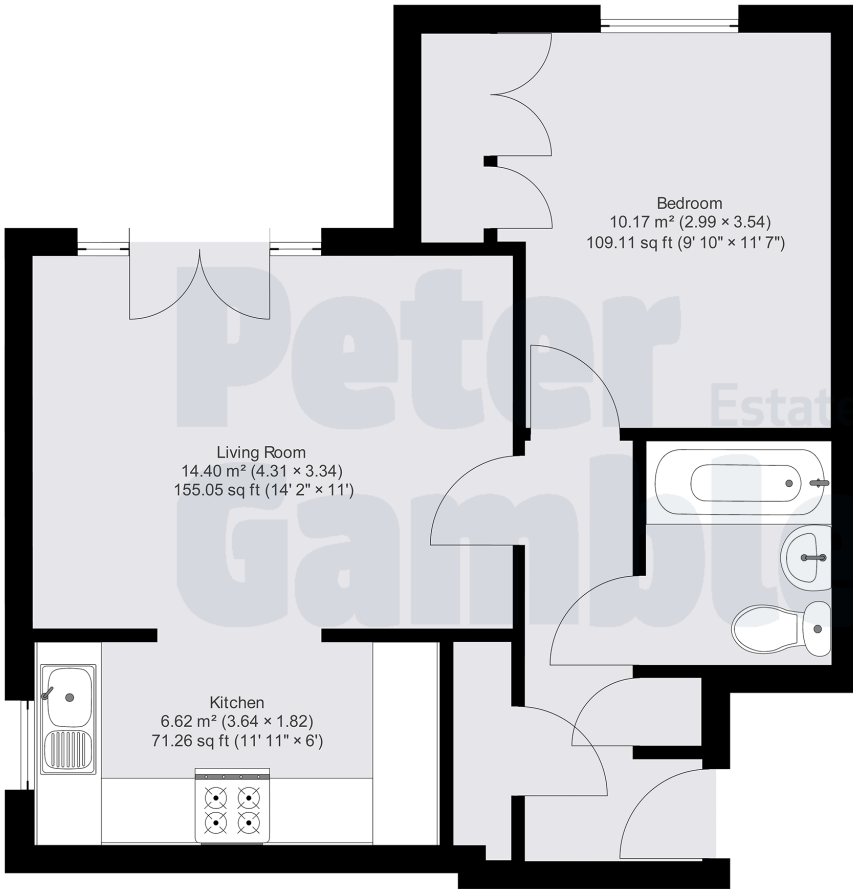

# Snowfleck House

Peter Gamble Estate Agents since 1979

**APPROX. GROSS INTERNAL FLOOR AREA:**  
43.5 sq. m / 469 sq.ft

WHILST EVERY ATTEMPT HAS BEEN MADE TO ENSURE THE ACCURACY OF THE FLOOR PLAN CONTAINED HERE, NO RESPONSIBILITY IS TAKEN FOR ANY ERROR, OMISSION OR MIS-STATEMENT. THIS PLAN IS FOR ILLUSTRATIVE PURPOSES ONLY AND SHOULD BE USED AS SUCH

© Avasmo Energy

Energy Efficiency Rating		Current	Potential
<i>Very energy efficient - lower running costs</i>			
(92-100) <b>A</b>			
(81-91) <b>B</b>			
(69-80) <b>C</b>		80	80
(55-68) <b>D</b>			
(39-54) <b>E</b>			
(21-38) <b>F</b>			
(1-20) <b>G</b>			
<i>Not energy efficient - higher running costs</i>			
<b>England, Scotland &amp; Wales</b>		EU Directive 2002/91/EC	