

FOR
SALE



5 River View Court, Bridge Street, Hereford HR4 9BQ

£325,000 - Leasehold

22, Broad Street, Hereford, HR4 9AP 01432 355455 hereford@flintandcook.co.uk

PROPERTY SUMMARY

This highly impressive modern ground floor apartment forms part of a historic Art Deco building converted and extended in around 2010 by highly regarded local developers, Perfection Homes Ltd, and is just a short distance from the Cathedral and city centre of Hereford within close proximity of the River Wye with some lovely walks. Apartment 5 has been finished to a very high standard with features including powder-coated aluminium double glazing, underfloor gas central heating, video door entry system, integrated stereo system, front and rear pedestrian access via a secure carparking area (with designated space) and a prime feature of the property is the balcony which has a southerly aspect.

POINTS OF INTEREST

- *Landmark development near River Wye*
- *2 Bedrooms, 2 Shower Rooms*
- *Underfloor heating*
- *Stereo system*
- *Balcony/Terrace*
- *Off-road secure parking*



ROOM DESCRIPTIONS

Communal Entrance Hall

With door entry phone system.

Inner Hall (serving apartments 5 & 6) and a secondary access leading to the carpark area.

Apartment 5 - Spacious Entrance Hall

With door entry phone and video entrance phone.

Utility Room

Plumbing for washing machine, electric fuseboard, tiled floor.

Lounge/Dining Room

Oak laminate flooring, integrated speaker system, window to side, window to rear and patio doors to the BALCONY/TERRACE.

Kitchen

Fitted with a range of oak-style base and wall mounted units with granite worktops and splashbacks, built-in electric double oven, 4-ring gas hob, extractor hood, 1½ bowl sink unit, built-in dishwasher, built-in fridge/freezer, cupboard housing the gas fired central heating boiler, radiator, extractor fan, wall mounted electric heater, Velux window, window and door to the courtyard (communal).

Bedroom 1

Built-in wardrobe, wall light points, ceiling speakers, window.

Bedroom 2

Wall light points, built-in wardrobe, window.

Shower Room 1

Comprising shower cubicle, wash hand-basin with cupboard under, WC, ladder style radiator, further electric towel rail, tiled walls and floor, ceiling speaker, extractor fan.

Shower Room 2

Tiled walls and floor, corner shower cubicle, wash hand-basin with cupboard under, WC, ceiling speaker, ladder style radiator, further electric towel rail, wall mounted cupboard, shaver point, extractor fan.

Outside

There is a carpark with a designated parking space.

Services

Mains water, electricity, drainage and gas are connected. Telephone (subject to transfer regulations). Gas-fired central heating.

Outgoings

Council tax band TBC - payable 2024/25 £TBC.

Water and drainage - rates are payable/metered supply.

Money laundering regulations

Prospective purchasers will be asked to produce identification, address verification and proof of funds at the time of making an offer.

Viewing

Strictly by appointment through the Agent, Flint & Cook, Hereford (01432) 355455.

Directions

What3words - faded.handed.cone

Ground Floor
Approx. 93.6 sq. metres (1007.3 sq. feet)

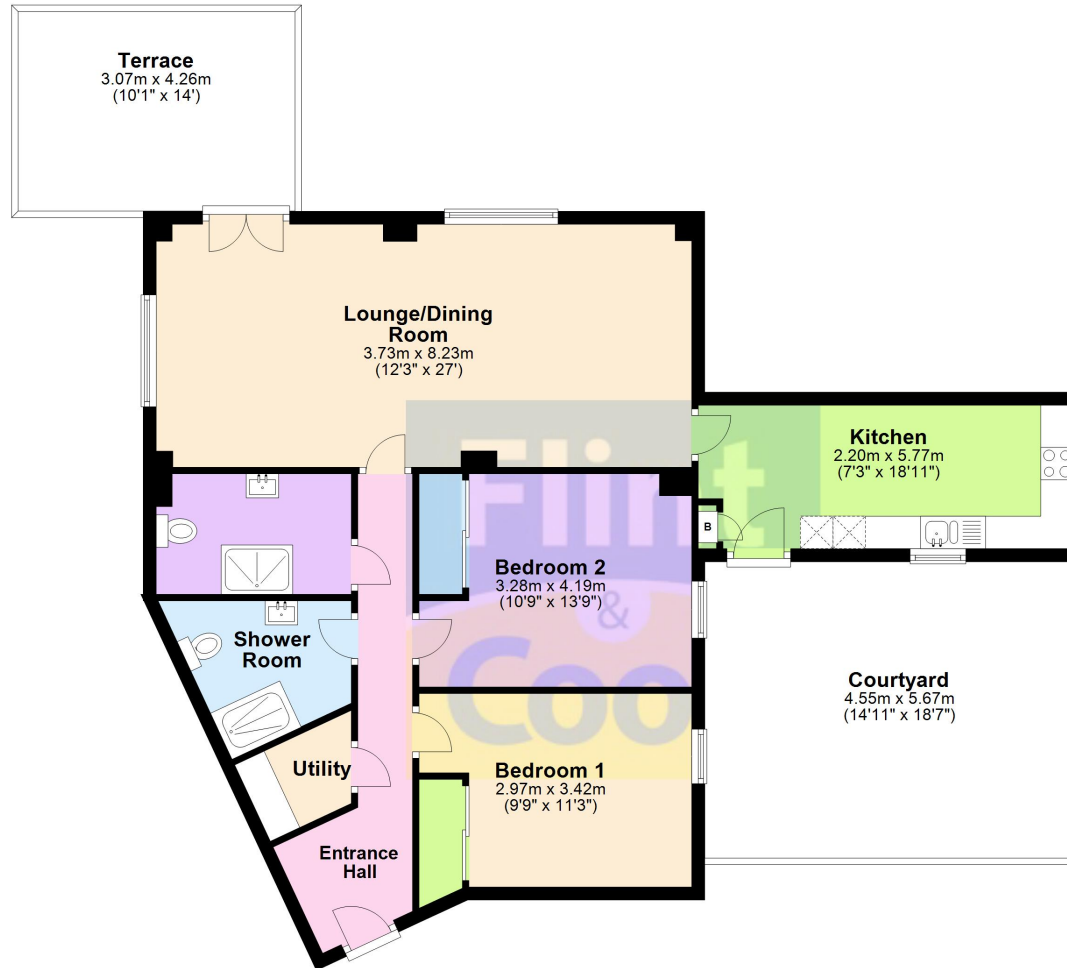

Total area: approx. 93.6 sq. metres (1007.3 sq. feet)

This plan is for illustrative purposes only
Plan produced using PlanUp.

These particulars are prepared for the guidance only of prospective purchasers. They are intended to give a fair and overall description of the property and do not constitute the whole or any part of an offer or contract. Any information contained herein (whether in text, plans or photographs) is given in good faith but should not be relied upon as being a statement or representation of fact. Any plans provided by the agents and/or with the sales particulars are intended for guidance purposes only; we cannot guarantee the accuracy and scale of any plans, and they do not form any part of the sales contract. Nothing in these particulars shall be deemed to be a statement that the property is in good condition or otherwise nor that any services or facilities are in good working order. Any movable contents, fixtures and fittings, (whether wired or not) referred to in these property particulars (including any shown in the photographs) are, unless the particulars say otherwise, excluded from the sale. In the event that the buyer proposes to purchase any movable contents or include them in any offer for the property, the buyer cannot in any respect imply any such inclusion from the property particulars. Any areas, measurements or distances referred to herein are approximate only and may be subject to amendment. It should not be assumed that the property has all necessary planning, building regulation or other consents and these matters must be verified by an intending purchaser. The information in these particulars is given without responsibility on the part of the agents or their clients and neither the agents nor their employees have any authority to make or give any representations or warranties whatever in relation to this property.

Flint & Cook Privacy Statement: We take your privacy very seriously. Your data will not be shared with any other parties without your express permission. Our Data protection Policy can be read in full on the Flint & Cook website, www.flintandcook.co.uk

| Energy Efficiency Rating | | Current | Potential |
|---|----------|---------|-----------|
| Very energy efficient - lower running costs | | | |
| (92+) | A | | |
| (81-91) | B | | |
| (69-80) | C | 80 | 80 |
| (55-68) | D | | |
| (39-54) | E | | |
| (21-38) | F | | |
| (1-20) | G | | |
| Not energy efficient - higher running costs | | | |
| England, Scotland & Wales | | | |
| EU Directive 2002/91/EC | | | |