



50 Stoneley, Letchworth Garden City, Hertfordshire, SG6 4QZ

£325,000

This striking Semi-detached freehold property is available CHAIN FREE, offering two good sized double bedrooms, dual aspect lounge with feature fireplace, a well fitted kitchen/ dining space opening into the 4.8m conservatory, a clever utility cupboard and a ground floor bathroom (currently a wet room style).





# 50 Stonely

Approximate Gross Internal Area  
926 sq ft - 86 sq m

- TWO DOUBLE BEDROOM SEMI-DETACHED HOME
- POPULAR LOCATION CLOSE TO COUNTRYSIDE
- FREEHOLD | CHAIN FREE
- DUAL ASPECT LOUNGE | FITTED KITCHEN/DINING ROOM
- UTILITY CUPBOARD | SIZABLE GROUND FLOOR BATHROOM |
- LARGE CONSERVATORY
- GARAGE & LONG DRIVEWAY
- FRONT, REAR & SIDE GARDENS
- SCOPE FOR FURTHER EXTENSION/ LOFT CONVERSION STP
- CLOSE TO SCHOOLS AND LOCAL AMENITIES | 1 MILE TO TOWN/STATION

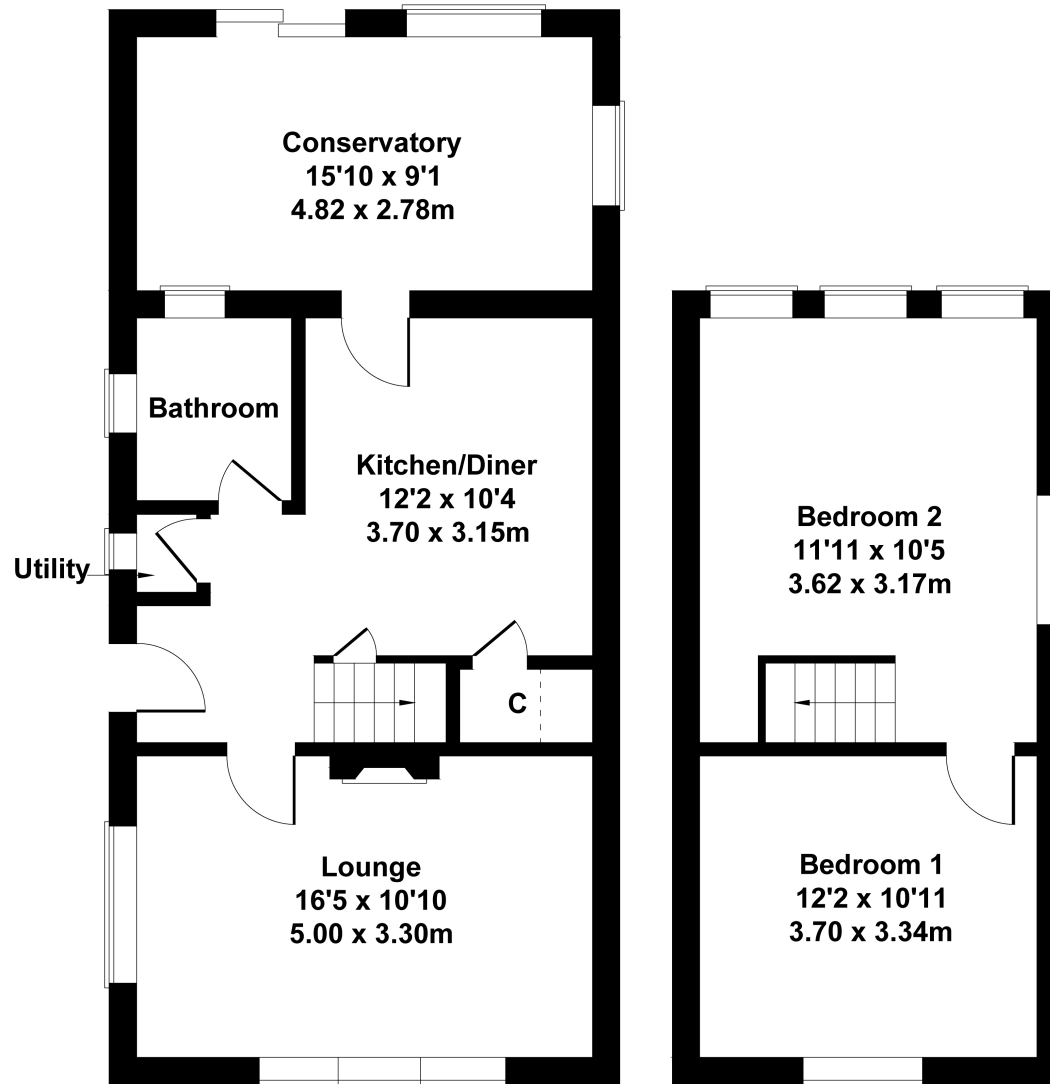

**GROUND FLOOR**

**FIRST FLOOR**

Not to Scale. Produced by The Plan Portal 2024  
For Illustrative Purposes Only.

