



10 Mullway, Letchworth Garden City, Hertfordshire, SG6 4BH

£335,000

Lane & Bennetts are delighted to bring to market this three bedroom mid terraced, well-proportioned family home in the popular Wilbury area. There is a modern, upgraded kitchen with new integrated electric oven and gas hob. This home boasts a long and characterful garden with delightful patio area and ample shed storage. The property is beautifully presented and offers a new buyer a perfect first time purchase, upgrade from an apartment or is an ideal investment. Letchworth train station and town are less than a mile away from this home and it is in the catchment of 'Good' Ofsted rated schools. The driveway offers parking for up to two vehicles. The property benefits from being on the doorstep of the Letchworth Greenway and Hitchin Lavender fields.



10 Mullway, Letchworth Garden City, SG6 4BH

Approximate Gross Internal Area
721 sq ft - 67 sq m

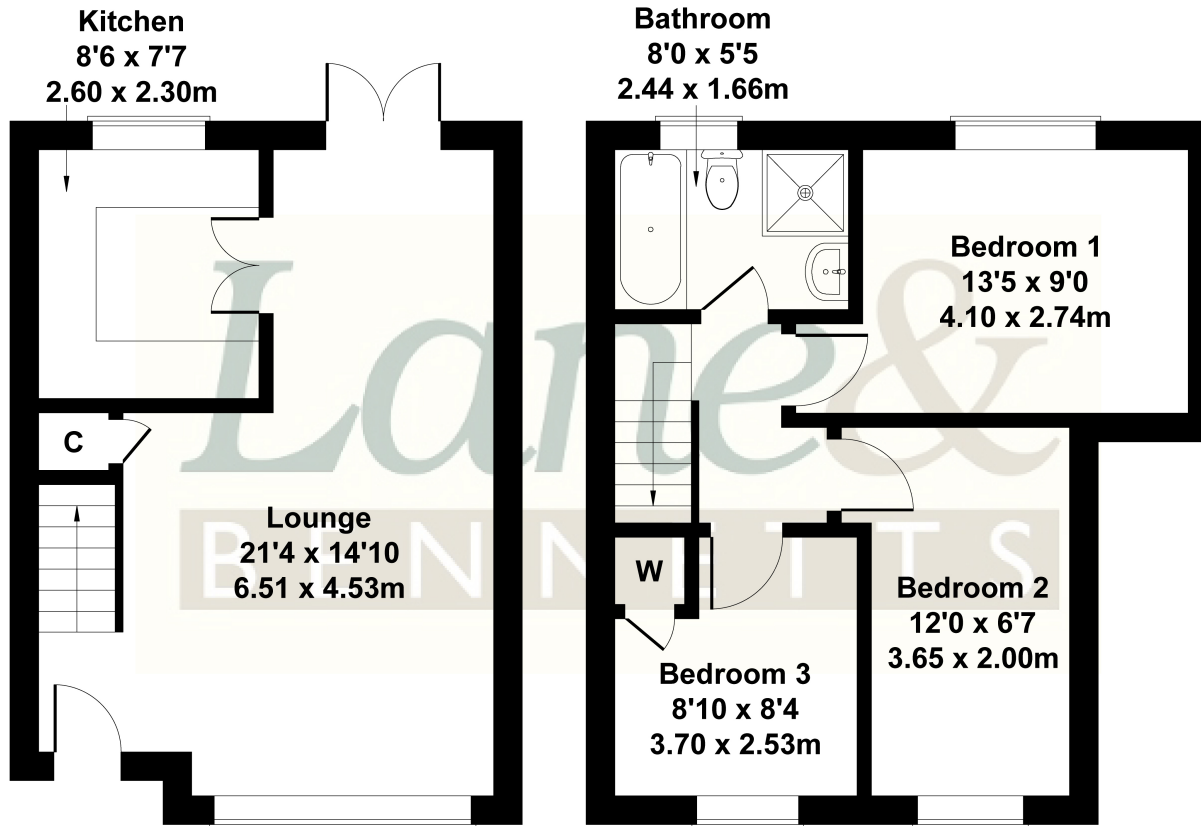

GROUND FLOOR

FIRST FLOOR

Not to Scale. Produced by The Plan Portal 2025
For Illustrative Purposes Only.

- THREE BEDROOM MID TERRACED HOME
- DUAL ASPECT OPEN PLAN LOUNGE / DINER
- MODERN KITCHEN WITH NEW OVEN
- SIZABLE FAMILY BATHROOM WITH BATH AND SEPARATE SHOWER CUBICLE
- DELIGHTFUL GARDEN WITH LARGE ENTERTAINING PATIO
- PLENTIFUL SHEDS
- OFF-ROAD PARKING FOR UP TO TWO VEHICLES
- BEAUTIFULLY PRESENTED THROUGHOUT
- LESS THAN 1 MILE FROM STATION & TOWN
- LEASEHOLD | COUNCIL TAX BAND: C | EPC: D

