



Ventonlace
Grampound Road
Truro
Cornwall
TR2 4TA

Offers in Excess of £325,000

bettermove 

Ventonlace

Truro

Bettermove are proud to present this 3 bedroom detached house in the village of Grampound Road, Truro.

The property benefits from double glazing, gas central heating throughout and has off street parking available via the driveway. The council tax band is C.

The interior of this beautifully presented property comprises a spacious living room, dining room, fitted kitchen WC and garage on the ground floor. The first floor consists of 3 bedrooms and the family bathroom. The exterior boasts a private and spacious rear garden, perfect for enjoying the summer months.

Located in the popular village of Grampound Road, the property is close to a range of amenities, including shops, supermarkets, restaurants and pubs. Public transport connections can be found into nearby towns Truro and St Austell.

This exciting opportunity should not be missed! All enquiries can be made through Bettermove on 0330 004 0050.





Ground Floor

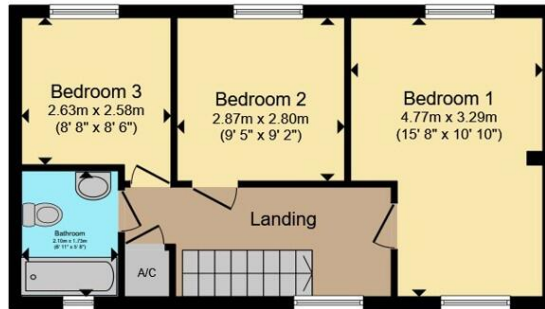

First Floor

Total floor area 102.8 m² (1,106 sq.ft.) approx

This floor plan is for illustrative purposes only. It is not drawn to scale. Any measurements, floor areas (including any total floor area), openings and orientation are approximate. No details are guaranteed, they cannot be relied upon for any purpose and they do not form part of any agreement. No liability is taken for any error, omission or misstatement. A party must rely upon its own inspection(s). Powered by www.focalagent.com



20-22 Bridge End, Leeds, LS1 4DJ
t: 0330 004 0050 e: hello@bettermove.co.uk
www.bettermove.co.uk