



Paynes Park

HITCHIN | Hertfordshire | SG5 1EJ

www.stonegate-estates.co.uk



PAYNES PARK

Property Description

Situated in the heart of Hitchin town centre, this generous ground-floor retirement apartment offers both comfort and convenience for those seeking a peaceful yet connected lifestyle.

Offered with no onward chain, the property features a well-proportioned double bedroom, a bright and spacious living/dining area with direct access to a private patio, a modern fitted kitchen, and a contemporary shower room.

The apartment benefits from wide hallways and ample storage, creating a light and airy feel throughout.

Residents enjoy exclusive access to a welcoming communal lounge, a well-equipped laundry room, and the reassurance of a dedicated Development Manager on-site.

The property is ideally located within easy walking distance of local shops, cafes, transport links, and all the amenities that vibrant Hitchin has to offer. This is a fantastic opportunity to enjoy independent living within a friendly and supportive community.

Key Features:

Ground floor with direct patio access

Generously sized throughout

Fitted kitchen and modern shower room

Residents lounge and laundry facilities

On-site Development Manager

Sought-after retirement development

Walking distance to Hitchin town centre

No onward chain

£220,000 Leasehold



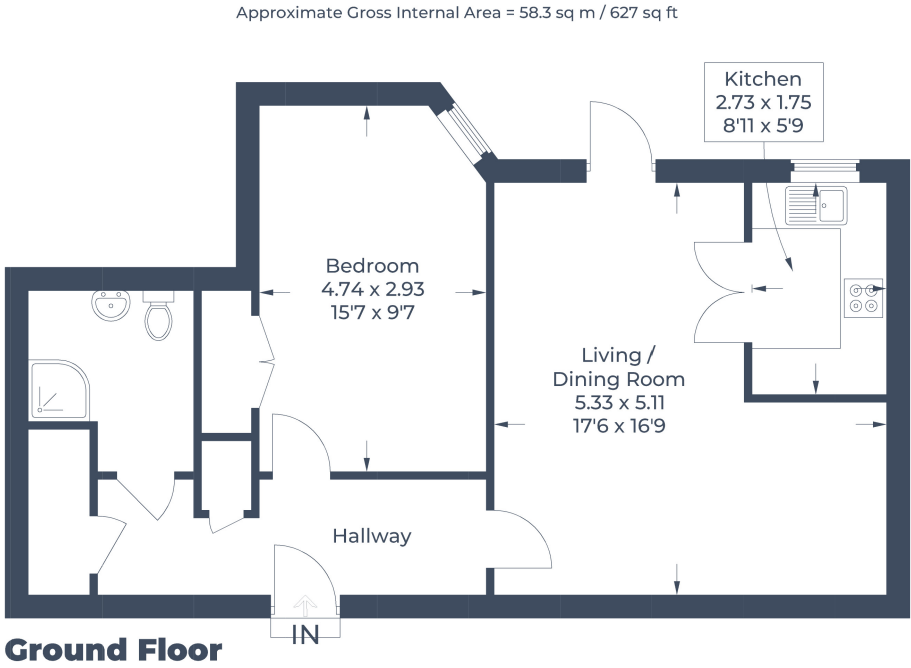

Illustration for identification purposes only,
measurements are approximate, not to scale.
© CJ Property Marketing Produced for Stonegate Estates



- Ground Floor Apartment
- Independent Living
- Good Size Accommodation
- No Chain
- Residents Lounge
- Laundry Facilities
- Town Centre Location

EPC Rating: C

Stonegate Estate Agents

01462 438979

sales@stonegate-estates.co.uk | www.stonegate-estates.co.uk

