



**Willow Close
Filey
North Yorkshire
YO14 9NY**

Offers In Excess Of £199,950

bettermove

Willow Close

Filey

Bettermove are proud to present this 3 bedroom Terraced house in Filey. This property is available with no forward chain.

The property benefits from double glazing, gas central heating throughout via a new Worcester Bosch boiler, has recently undergone a full rewiring and has off street parking available via the driveway.

The council tax band is C.

The interior of this beautifully presented property comprises of two spacious living rooms, sunroom, fitted kitchen and separate washroom on the ground floor. The first floor consists of 3 bedrooms and the family bathroom. The loft within this property is fully boarded featuring plenty of storage space.

The exterior boasts a private enclosed rear and front garden, perfect for enjoying the summer months.

Located in the popular town of Filey, the property is close to a range of amenities, including shops, supermarkets, restaurants and pubs.

Excellent transport connections can be found from the A165 and many local bus routes.

This exciting opportunity should not be missed! All enquiries can be made through Bettermove on 0330 004 0050.

You can secure the purchase today by paying an exclusivity fee of £1,000 which gives you the rights to purchase within a given timeframe.

Paying this fee ensures that the seller takes their property off the market and reserves it exclusively for you, therefore eliminating the risk of gazumping and aborted costs.





Ground Floor

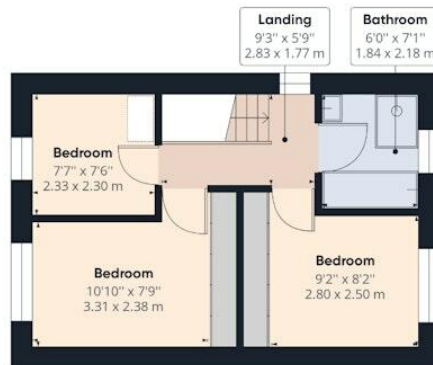

Floor 1

Approximate total area⁽¹⁾

952.28 ft²
88.47 m²

Reduced headroom

7.21 ft²
0.67 m²

(1) Excluding balconies and terraces

☐ Reduced headroom
(below 1.5m/4.92ft)

While every attempt has been made to ensure accuracy, all measurements are approximate, not to scale. This floor plan is for illustrative purposes only.

GIRAFFE360

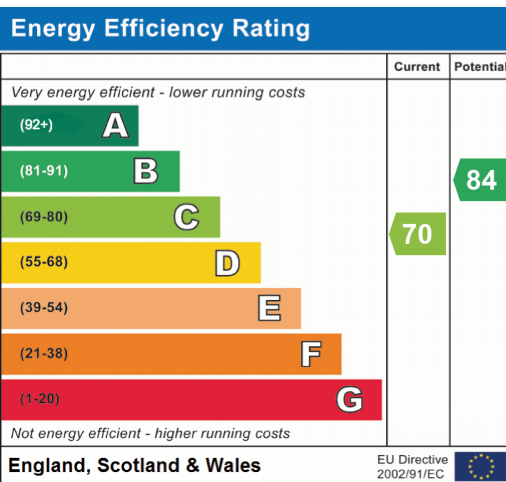



20-22 Bridge End, Leeds, LS1 4DJ
t: 0330 004 0050 e: hello@bettermove.co.uk
www.bettermove.co.uk