

# East Street

Warminster, BA12 9BZ

COOPER  
AND  
TANNER



£159,950 Freehold

🛏 1 🛋 1 🚿 1 EPC F

## Description

Grade II listed - This one bedroom mid terrace Victorian house is set in a quiet row of similar cottages and comes to the market with NO ONWARD CHAIN. It is within easy walking distance to the town centre. It offers a kitchen, separate sitting room with a Victorian Fireplace. Upstairs there is a main bedroom which leads into another room which could be used a study . There is potential to make TWO bedrooms upstairs. Also there is the main bathroom. The property is in need of modernisation and updating. Outside there is access through a gate to a lovely private good sized garden ( Note: the garden can be found along the path and is separate to the cottage).

## East Street, Warminster, BA12

Approximate Area = 735 sq ft / 68.2 sq m  
For identification only - Not to scale

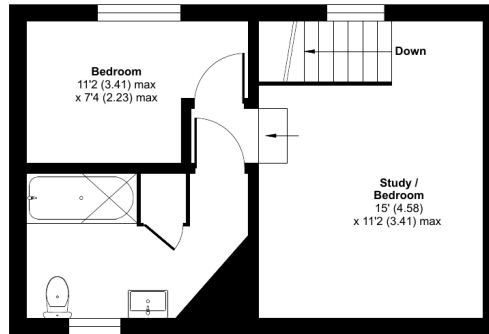

FIRST FLOOR

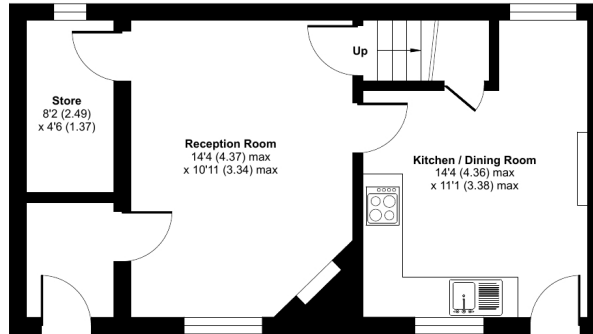

GROUND FLOOR

 Floor plan produced in accordance with RICS Property Measurement 2nd Edition, incorporating International Property Measurement Standards (IPMS2 Residential). © nichcom 2025. Produced for Cooper and Tanner. REF: 1230653



### Features

- Victorian Cottgae
- Kitchen
- Sitting Room
- One Bedroom
- Study (Potential to be bedroom 2)
- Bathroom
- In need of modernisation
- Separate detached private garden
- Close to town centre
- No onward chain
- Grade II listed

### Local Information

- Council Tax Band B
- Tenure Freehold
- EPC Rating F

#### WARMINSTER OFFICE

Telephone 01985 215579

48-50, Market Place, Warminster, Wiltshire BA12 9AN

[warminster@cooperandtanner.co.uk](mailto:warminster@cooperandtanner.co.uk)

**COOPER  
AND  
TANNER**

Important Notice: These particulars are set out as a general outline only for the guidance of intended purchasers and do not constitute, nor constitute part of, an offer or contract. All descriptions, dimensions, reference to condition and necessary permissions for use and occupation, warranties and other details are given without responsibility and any intending purchasers should not rely on the m as statements or rep representations of fact but must satisfy themselves by inspection or otherwise as to the correctness of each of them.

