



Chennells Close

Hitchin | Hertfordshire | SG4 0EA

www.stonegate-estates.co.uk



CHENNELLS CLOSE

Property Description

We are delighted to bring to the market this incredibly well presented and much improved two bedroom end of terrace property.

Ideal for a first time buyer, this home has under gone vast improvement by its current owner to include a refitted kitchen, a refitted bathroom suite, redecoration throughout, modern flooring and carpeting and electric heating with modern double glazing.

Outside there is a courtyard style garden which is fully enclosed and gated onto two parking spaces.

The property is situated within a quiet cul-de-sac and gives easy access to the train station, Letchworth garden city and the town centre.

To avoid disappointment, we advise an early viewing of this beautiful and also rare, shared ownership property.

Buyer be aware that this is on a 50/50 share basis and therefore a rent will be due on the existing share.

Details on request.

£160,000 Leasehold



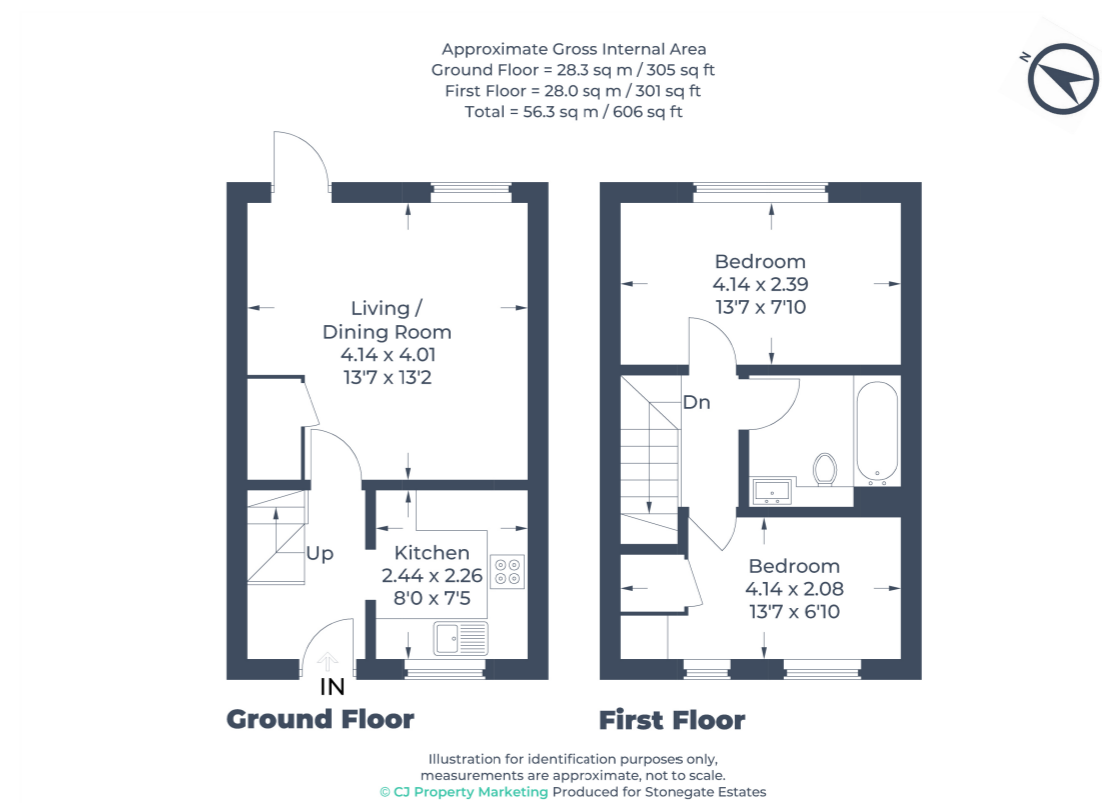



- Two Bedrooms
- End of Terrace House
- Parking
- Enclosed Garden
- Beautifully Presented
- 50/50 Shared Ownership
- Good Commuter Location
- Viewing Highly Recommended

EPC Rating: E

Stonegate Estate Agents

01462 438979

sales@stonegate-estates.co.uk | www.stonegate-estates.co.uk

