

FOR SALE

£210,000 Leasehold



33 Colyers Reach, Chelmsford, Essex, CM2 6RW

- ONE BEDROOM TERRACED HOUSE
- NO ONWARD CHAIN
- ELECTRIC HEATING
- ALLOCATED PARKING SPACE

- VIEWS OVER COMMUNAL GROUNDS TO FRONT
- QUIET LOCATION
- RECENTLY REFITTED KITCHEN
- CLOSE TO SHOPS



PROPERTY DESCRIPTION

Presenting a stunning one-bedroom terraced house for sale, situated in a highly sought-after location. The property is in immaculate condition, and its location benefits from excellent public transport links, local amenities, and an abundance of walking and cycling routes.

This splendid home features a single reception room, which offers a serene view of the garden. The house also boasts a well-appointed kitchen, infused with natural light and complete with a cosy breakfast area.

The bedroom is a generous size and has the benefit of a very large built-in wardrobe.

Bathroom and a large storage cupboard, and the benefit of a loft.

The property is situated within close proximity to Asda super store and associated amenities in the village square. Excellent riverside walks extending through Danbury to Maldon. Chelmer retail park offers further shopping. Bus routes connect into the City centre for leisure facilities and main line rail station to Liverpool Street

The property is offered for sale with no onward chain.



ROOM DESCRIPTIONS

Lounge

13' 0" x 10' 0" (3.96m x 3.05m) sealed unit entrance door to front, feature box bay window, stairs to first floor, electric panel radiator.

Kitchen

13' 0" x 5' 6" (3.96m x 1.68m) recently re-fitted kitchen with Base and wall mounted units with roll top worksurfaces, tiled splash backs, single stainless steel sink and drainer, space and plumbing for washing machine, space for fridge/freezer, freestanding electric cooker with an induction hob over. Double glazed window to rear.

First Floor Landing

Built in storage cupboard housing hot water cylinder and emersion heater, wardrobe space, doors to;

Bedroom

13' 0" x 10' 04" (3.96m x 3.15m) Sealed unit window to front, very large built in wardrobes, electric heating.

Bathroom

White suite comprising ; panel enclosed bath , overhead shower and screen, tiling to walls, wash hand basin with vanity cupboard beneath, low flush w.c, sealed unit window to rear, tiled flooring, electric heating.

Parking

One allocated parking space plus visitor parking in residents car park. Communal lawned gardens with children's play area. This leads into parkland and riverside walks.

Lease

84 YEARS REMAINING.

£1600.00 MAINTENANCE CHARGE INCLUDING BUILDINGS INSURANCE

GROUND RENT £50.00 P.A

Expected lease extension cost £10,000



FLOORPLAN

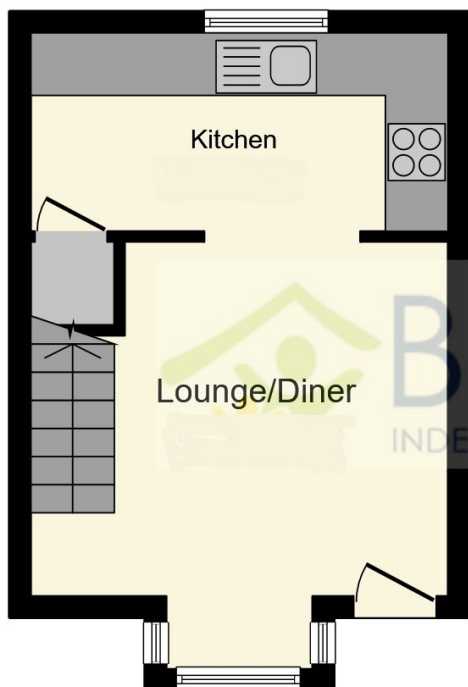

Ground Floor

Floor area 22.6 sq.m. (243 sq.ft.) approx

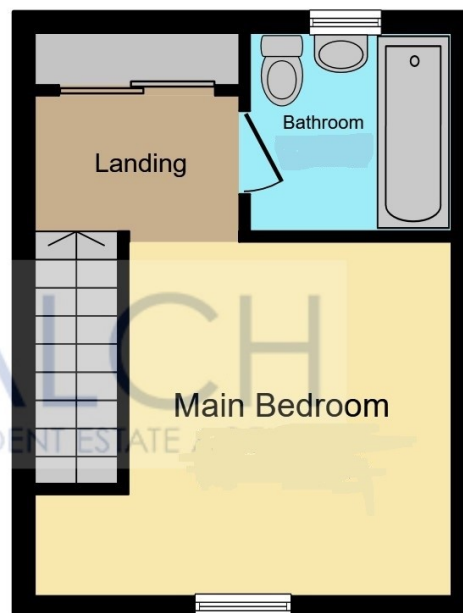

First Floor

Floor area 21.6 sq.m. (233 sq.ft.) approx

This Floor Plan is for illustration purposes only and may not be representative of the property. The position and size of doors, windows and other features are approximate. Unauthorized reproduction prohibited. © PropertyBOX