



Benson Street,  
Pitshill



**OneAgency**

01782 970222

[hello@oneagencygroup.co.uk](mailto:hello@oneagencygroup.co.uk)



# Offers in Excess of £75,000

Mid terrace house located conveniently for Tunstall town centre and access to the A500. The property is considered an ideal buy to let or first time buy and is offered with no chain involvement.





## GROUND FLOOR

### THROUGH LIVING/DINING ROOM

Double glazed window to front and rear, two radiators, laminate flooring, under stairs storage area, stairs to first floor.

### LIVING AREA

3.64m x 3.33m (11' 11" x 10' 11")

### DINING AREA

3.64m x 2.71m (11' 11" x 8' 11")

### KITCHEN

Fitted with a range of wall, base and drawer storage units, radiator, stainless steel sink and drainer unit, fitted oven and hob, double glazed window to side, door to side.

## BATHROOM

1.79m x 1.68m (5' 10" x 5' 6")  
Bathroom suite comprising of panelled bath, WC and pedestal wash hand basin, double glazed frosted window to rear, radiator.

## FIRST FLOOR

### BEDROOM ONE

3.35m x 3.67m (11' 0" x 12' 0")  
Double glazed window to front,, radiator.

### BEDROOM TWO

2.73m x 3.65m (8' 11" x 12' 0")  
Double glazed window to rear, radiator, built in storage area with Glow-Worm boiler.

## OUTSIDE

Rear yard.

## AGENTS NOTES

Council Tax Band A



GROUND FLOOR

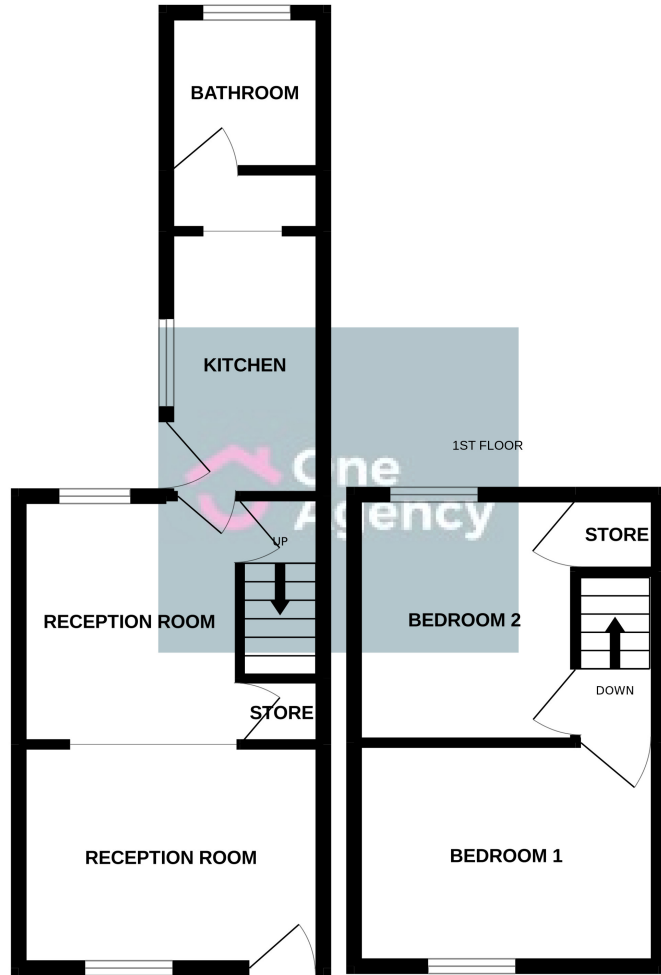

Whilst every attempt has been made to ensure the accuracy of the floorplan contained here, measurements of doors, windows, rooms and any other items are approximate and no responsibility is taken for any error, omission or mis-statement. This plan is for illustrative purposes only and should be used as such by any prospective purchaser. The services, systems and appliances shown have not been tested and no guarantee as to their operability or efficiency can be given.  
Made with Metropix ©2022

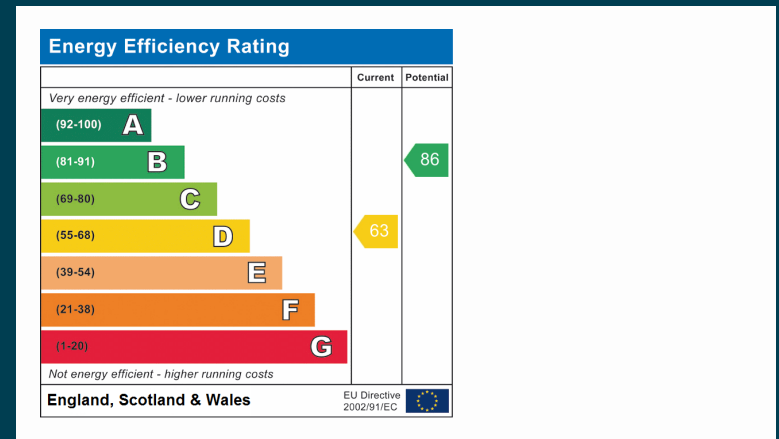

OneAgency, 9 & 10 Ridge House Drive, Festival Park, Stoke-on-Trent, ST1 5SJ

01782 970222

hello@oneagencygroup.co.uk

Every attempt has been made to ensure accuracy, however, all measurements are approximate and for illustrative purposes only. **Not to scale.**

In accordance with The Consumer Protection from Unfair Trading Regulations 2008 the following particulars have been prepared in good faith and they are not intended to constitute part of an offer or contract. We have not carried out a structural survey and the services, appliances and specific fittings have not been tested. All photographs, measurements, floor plans and distances referred to are given as a guide only and should not be relied upon for the purchase of carpets or any other fixtures and fittings. Lease details, service charges and ground rent (where applicable) are given as a guide only and should be checked and confirmed by your Solicitor prior to exchange of contracts.