

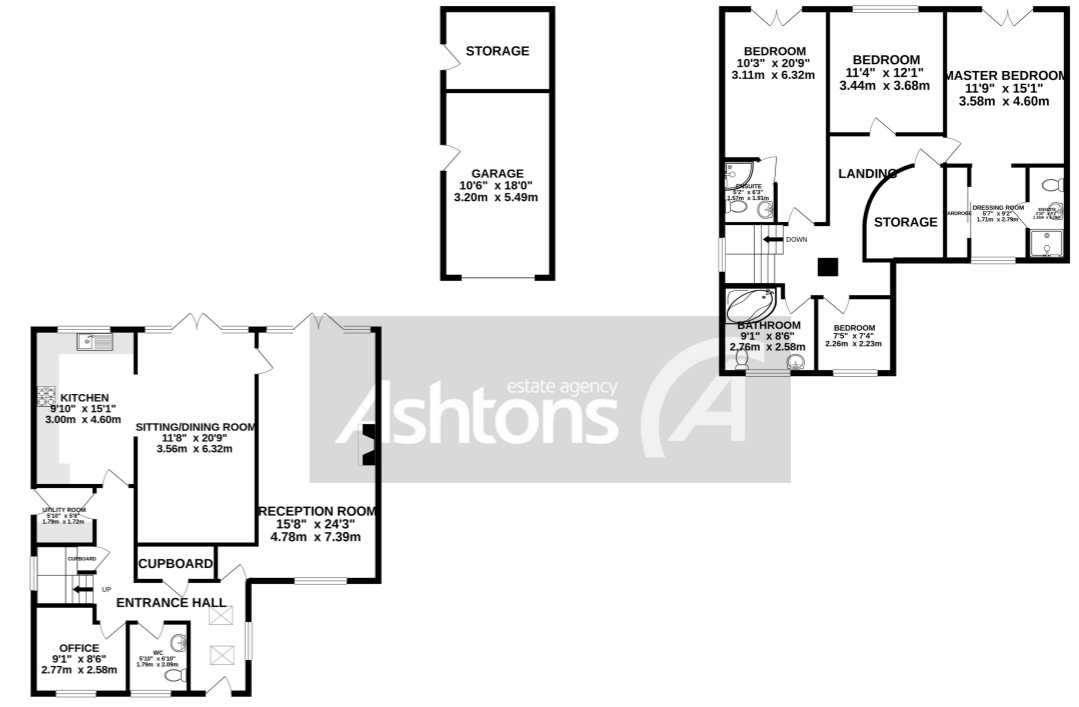

GROUND FLOOR
1298 sq.ft. (120.6 sq.m.) approx.

1ST FLOOR
982 sq.ft. (91.3 sq.m.) approx.



TOTAL FLOOR AREA: 2280 sq.ft. (211.8 sq.m.) approx.
Whilst every attempt has been made to ensure the accuracy of the floorplan contained here, measurements of doors, windows, rooms and any other items are approximate and no responsibility is taken for any error, omission or mis-statement. This plan is for illustrative purposes only and should be used as such by any prospective purchaser. The services, systems and appliances shown have not been tested and no guarantee as to their operability or efficiency can be given.
Made with Metropix ©2020

Twiss Green Lane, Culcheth. WA3 4BZ £799,995

Large detached family house | Four bedrooms | Two en suite bathrooms | Driveway for ample parking | Underfloor heating | Music system to four zones | Large Garage & Driveway | Freehold title |

