

Truuli



Howberry Road, Thornton Heath, Surrey, CR7 8HY

£450,000 Freehold

- Lovely terraced home
- Neutral decor throughout
- Generously sized home with ample storage
- Schools and parks nearby
- 26" reception room
- Extended kitchen
- No onward chain

Southbridge Place, Croydon, Surrey, CR0 4HA

Tel: 0330 043 0002

Email: save@truuli.co.uk Web: www.truuli.co.uk

Howberry Road, Thornton Heath, Surrey, CR7 8HY

£450,000 Freehold

Nestled on a sought-after residential street, this charming 1930s terraced home presents an excellent opportunity for both families, investors and professionals.

Perfectly located with convenient access to the lively Crystal Palace area and the peaceful Norwood Lakes, this property effortlessly combines period features with contemporary comfort.

Howberry Road

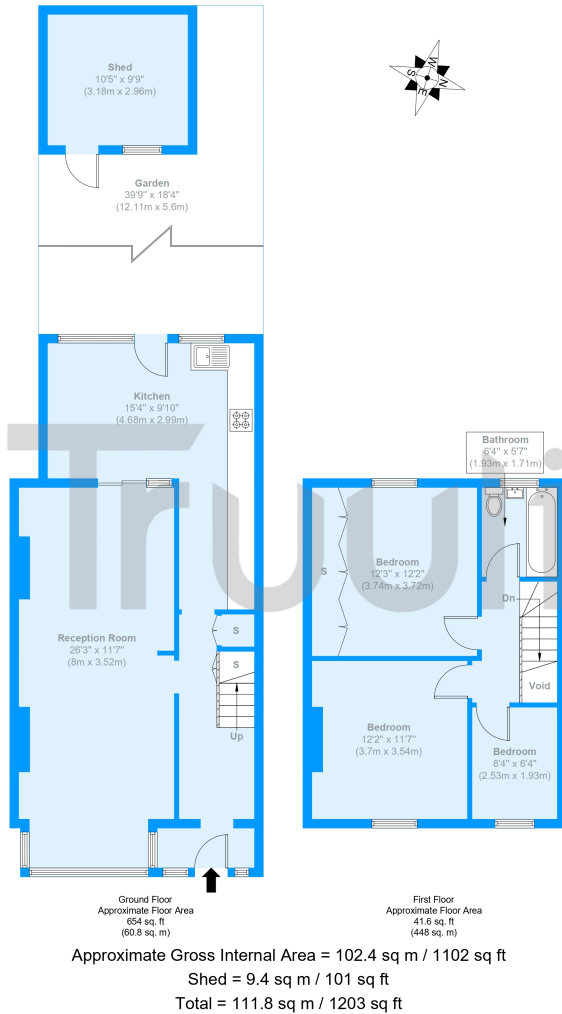

The Floor plan is not to scale and measurements and areas shown are approximate and therefore should be used for illustrative purposes only. The plan has been prepared in accordance with the RICS code of Measuring Practice and whilst we have confidence in the information produced it must not be relied on. Maximum lengths and widths are represented on the floor plan. If there is any aspect of particular importance, you should carry out or commission your own inspection of the property.
 Copyright © BleuPlan

Energy Efficiency Rating		Current	Potential
Very energy efficient - lower running costs			
(92+)	A		
(81-91)	B		85
(69-80)	C	70	
(55-68)	D		
(39-54)	E		
(21-38)	F		
(1-20)	G		
Not energy efficient - higher running costs			
England, Scotland & Wales		EU Directive 2002/91/EC	

