





Penn Street, Belper, Derbyshire DE56 1GH
£150,000 - Freehold



PROPERTY DESCRIPTION

Offered with no upward chain is this charming one bedroom stone cottage located within close proximity to Belper town Centre. The property briefly comprises of. :- Living room with under stairs storage cupboard, kitchen and shower room. To the first floor there is a double bedroom and externally the property offers a private enclosed rear courtyard style garden. We believe the property will ideally suit single people and couples and recommend an early internal inspection of this competitively priced property .

POINTS OF INTEREST

- Charmin Stone Cottage
- 1 Bedroom
- Kitchen
- Shower Room
- Cottage Garden
- Ideal Downsize
- Close To Belper Town
- COUNCIL TAX BAND A

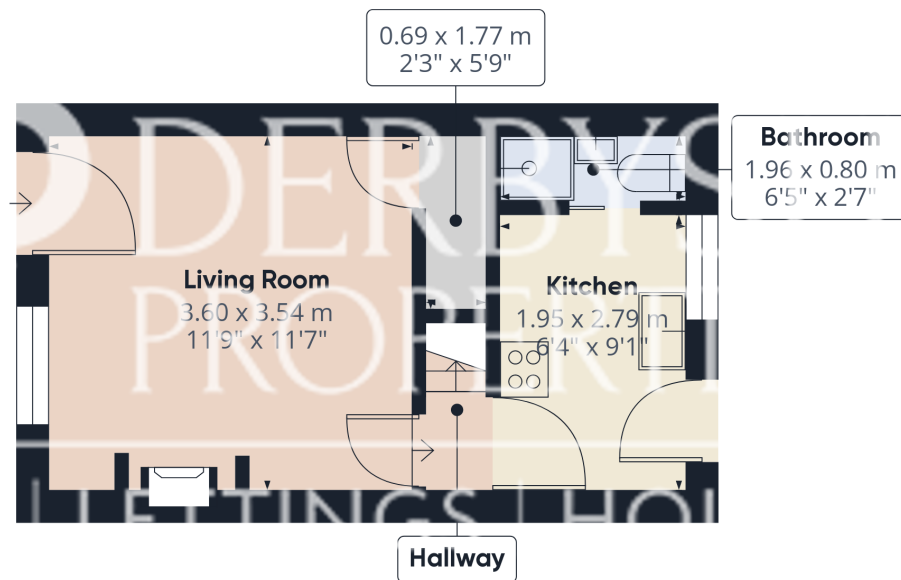

Ground Floor

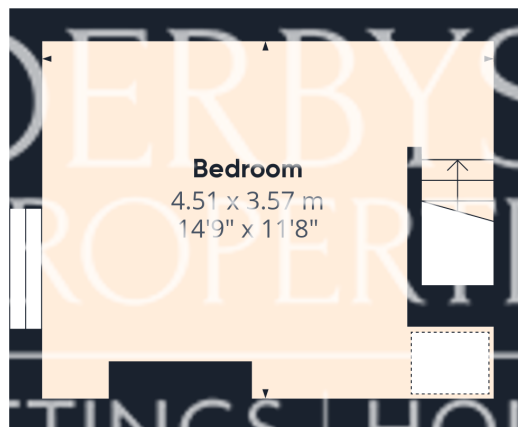

Floor 1

Approximate total area⁽¹⁾

36.77 m²

395.79 ft²

(1) Excluding balconies and terraces

While every attempt has been made to ensure accuracy, all measurements are approximate, not to scale. This floor plan is for illustrative purposes only.

Calculations are based on RICS IPMS 3C standard.

GIRAFFE360