



26 ALMANSA WAY • LYMINGTON • SO41 9PY

£339,950

A stunning two-bedroom duplex apartment in the sought-after Lymington Shores Development. Offered with no forward chain this like-new apartment features a large open-plan kitchen/dining living room, en-suites off both bedrooms and a large wrap-around balcony.



FELLS GULLIVER

PROPERTY EXPERTS

Est.1988

GROUND FLOOR
39.3 sq.m. (424 sq.ft.) approx.

1ST FLOOR
39.5 sq.m. (425 sq.ft.) approx.

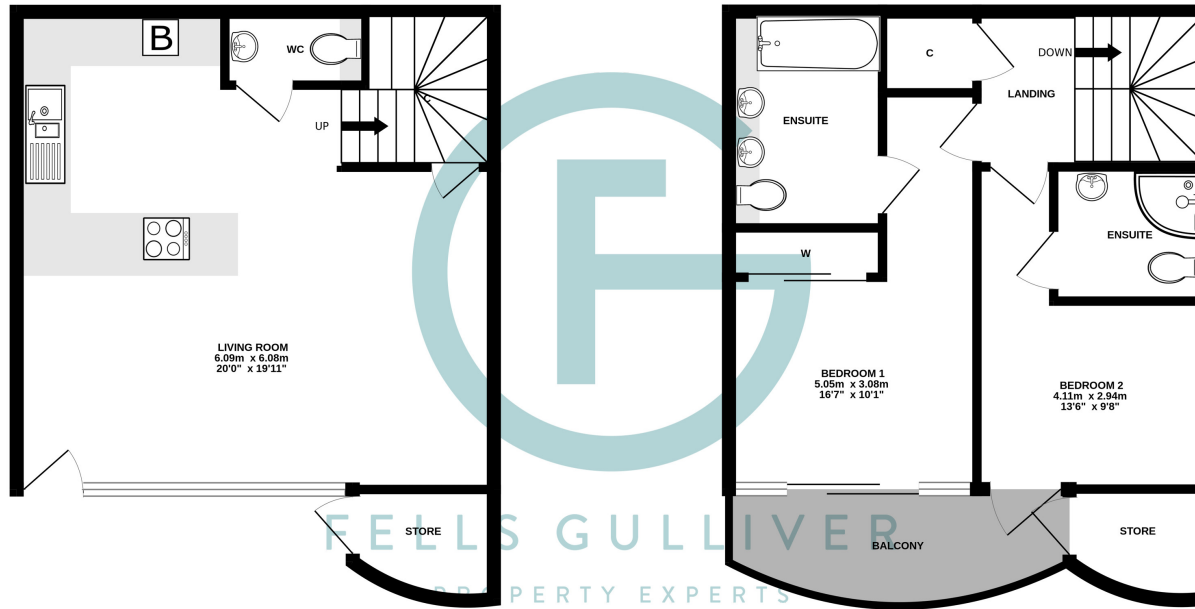

TOTAL FLOOR AREA : 78.8 sq.m. (849 sq.ft.) approx.
Made with Metropix ©2023

Property Specification

A stunning two-bedroom duplex apartment

Ground and first floor accommodation

Large balcony with additional storage

Own front door with private front garden

Large open plan kitchen/dining and reception room

En-suite bathrooms off both bedrooms and downstairs cloakroom

Moments from Lynton High Street and New Forest

Secure underground parking space

Sought after luxury riverside development

Offered with no forward chain

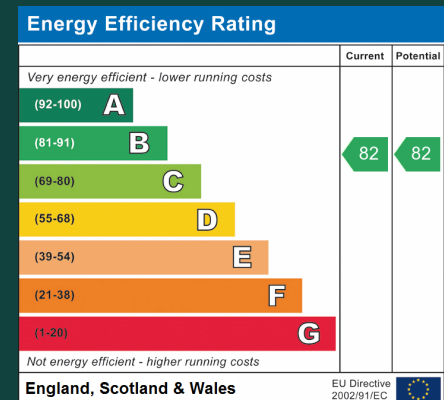

Description

A spacious and beautifully presented duplex apartment occupying the ground and first floor with direct access. The accommodation comprises two double bedrooms, each with a modern en suite and an adjoining balcony. The master bedroom benefits from floor-to-ceiling fitted wardrobes and sliding doors to the balcony. The balcony is of good size with plenty of space for bistro seating, a large external storage cupboard and views on both sides towards the river.

Downstairs there is a large open-plan kitchen/dining/reception room, a fantastic space ideal for entertaining. The luxury modern kitchen has ample worktop space with a breakfast bar and built-in appliances. A cloakroom completes the ground floor. The apartment has underfloor heating throughout. The property comes with an easily accessed underground parking space.

The duplex is within easy reach of the quaint cobbled street of Quay Hill and the Marinas and Yacht Clubs beyond, offering plenty of opportunities for the water sports

enthusiast. Lymington High Street is moments away with a wide range of shops, boutiques, supermarkets, and restaurants. Lymington Town train station is approximately a 5-minute walk and has a rail link to the mainline station at Brockenhurst, connecting to London Waterloo (under two hours away). The New Forest is just across the bridge making this property ideal for all outdoor activities.

We understand from the seller that the latest service charges and ground rent are as follows;

Ground Rent: £275 per annum (2 instalments of £137.50 payable half yearly) 01/04/23 - 31/03/24

Service Charge & Maintenance: £1,939.40 per annum (2 instalments of £969.70 payable half yearly) 01/04/23 - 31/03/24

Lease: 125 years from 2015.





Fells Gulliver • 125 High Street • Lymington • Hampshire • SO41 9AQ

01590 671711 lymington@fells-gulliver.com fells-gulliver.com

Fells Gulliver (Lymington) Limited give notice to anyone reading these particulars that they have been prepared as a general guide only. Their accuracy is not guaranteed, and they do not form part of a contract. We have not carried out any detailed survey nor tested the services, appliances or specific fittings. Room sizes are approximate and should not be relied upon for carpets or furnishings. Photographic images are reproduced in good faith and are for information only, they do not infer that any items shown are included in the sale. If there is any point which is of importance to you please contact us in order to check any information, particularly if you are contemplating traveling some distance to view this property.



FELLS GULLIVER

PROPERTY EXPERTS

Est.1988