



Day & Co
ESTATE AGENTS

28 Cavendish Street
Keighley
BD21 3RG



9 John Street, Oakworth,
Keighley, West Yorkshire, BD22
7HD

£179,995

T: 01535 664609

W: www.dayandcoestateagents.co.uk

E: keighley@dayandcoestateagents.co.uk

- Superbly Presented Through Terrace
 - Accommodation Over Four Floors
 - Enclosed Patio & Decking/Off-Road Parking
- Three Bedrooms & Spacious Bathroom With Four Piece Suite
 - Modern Fitted Kitchen/Lounge With Multi-Fuel Burning Stove
 - Popular Village Location Of Oakworth

SUMMARY

****A SUPERBLY PRESENTED 3 BEDROOM THROUGH TERRACE, POPULAR VILLAGE LOCATION OF OAKWORTH WITH FAR REACHING VIEWS!**** Having accommodation over 4 floors, modern fitted kitchen, spacious bathroom with 4 piece suite, enclosed patio with decking, off-road parking - VIEWING ESSENTIAL TO FULLY APPRECIATE!! Awaiting EPC.

FULL DESCRIPTION

Of interest to a variety of buyers is this superbly presented three bedroom through terrace situated in the popular village location of Oakworth with excellent access to village amenities and the local primary school. The four storey accommodation comprises of an open plan living room and kitchen having an attractive range of modern base and wall mounted units, integrated oven, hob and extractor fan, a multi-fuel burning stove, double glazed windows to both front and rear aspect and doors to both front and rear. To the lower ground floor is a spacious sitting room/home office with double glazed window to the front and radiator. To the first floor there is a double bedroom and the spacious bathroom having a four piece suite comprising of a bath, shower cubicle, WC, wash hand basin, radiator, double glazed window to the rear, To the second floor there are two further bedrooms both with double glazed Velux windows. Externally there is an enclosed patio with decking area and off-road parking. Viewing essential to fully appreciate, awaiting EPC.

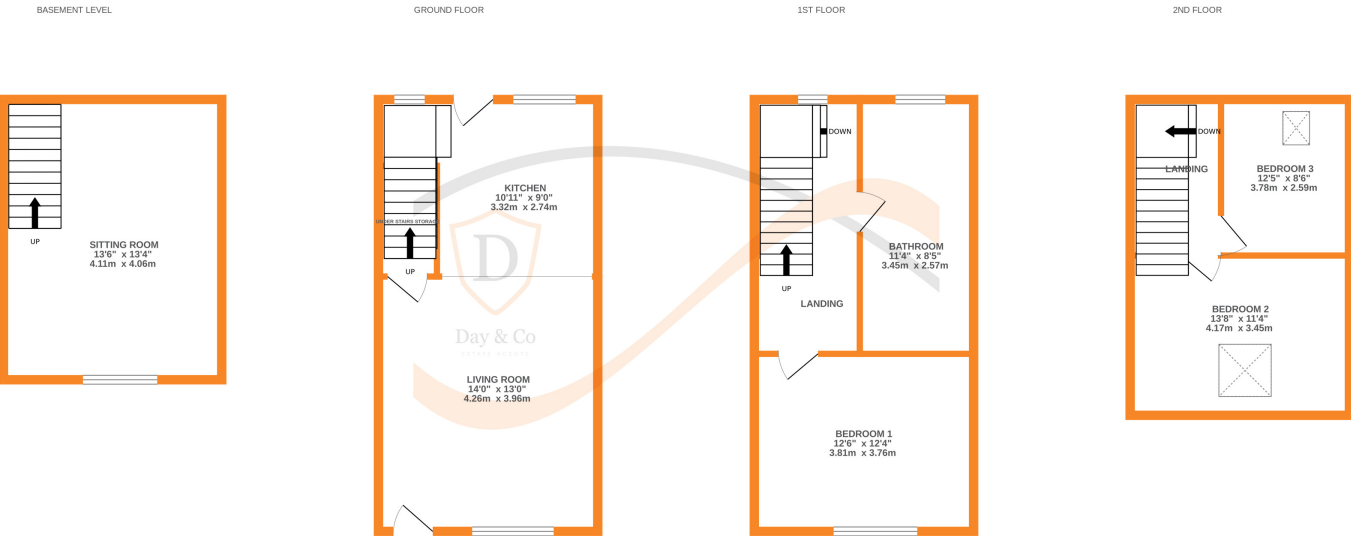

Whilst every attempt has been made to ensure the accuracy of the floorplan contained here, measurements of doors, windows, rooms and any other items are approximate and no responsibility is taken for any error, omission or mis-statement. This plan is for illustrative purposes only and should be used as such by any prospective purchaser. The services, systems and appliances shown have not been tested and no guarantee as to their operability or efficiency can be given.
Made with Metropix ©2025