

# Truuli



## Limes Road, Croydon, Surrey, CR0 2HF

£450,000 Freehold

- Paved rear garden
- Scope to extend
- Three double bedrooms
- Two reception rooms
- Newly refurbished bathroom and kitchen
- Residential road

Southbridge Place, Surrey, CR0 4HA

Tel: 0330 043 0002

Email: [save@truuli.co.uk](mailto:save@truuli.co.uk) Web: [www.truuli.co.uk](http://www.truuli.co.uk)

# Limes Road, Croydon, Surrey, CR0 2HF

£450,000 Freehold

Set within a residential road near East Croydon is this spacious, three-double-bedroom house on Limes Road.

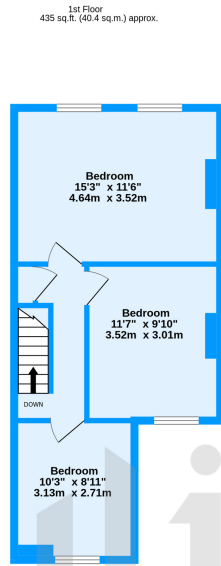
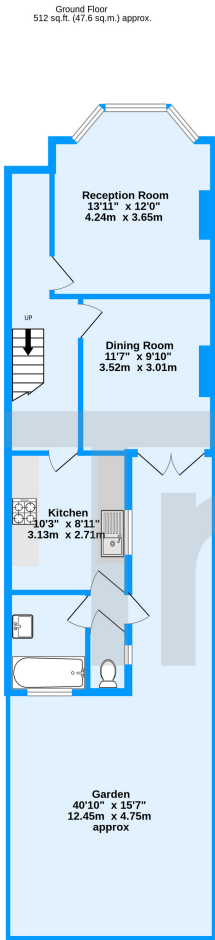

Limes Road, Croydon, CR0  
TOTAL FLOOR AREA: 947 sq.ft. (88.0 sq.m.) approx.  
Measurements are approximate. Not to scale. Illustrative purposes only  
Made with Metroplex ©2024

