



17 Balmoral Drive, Harthill, Shotts, North Lanarkshire, ML7 5FD

Beautifully Presented Two-Bedroom, Ground-Floor Flat with Gardens & Driveway

Up to date price and viewing info at mov8realestate.com/property

espc rightmove[®] find your happy Zoopla

Property Description

Beautifully presented and spacious, two-bedroom, ground-floor flat with a garden and a driveway. Set in a quiet residential street in Harthill, Shotts, North Lanarkshire, well located for the surrounding areas.

Comprises a vestibule, hallway, an open plan living room and kitchen, two flexible bedrooms and a family bathroom.

Highlights include a quality fitted kitchen with space for appliances and a modern bathroom suite. In addition, there is contemporary lighting and flooring, gas central heating and double glazing as well as superb storage.

Externally, there is a lawn and a driveway to the front with an enclosed garden.

A welcoming entrance provides access to all rooms, leading into the open-plan living room and kitchen, finished with wood-effect flooring and light décor throughout, complemented by a large window that floods the space with natural light. The kitchen features modern worktops, a tiled-effect splashback, a sink with a drainer, space for additional appliances, alongside an integrated oven and electric hob.

Bedrooms one and two are beautifully presented with matching wood-effect flooring, light décor, and built-in cupboards for added storage. The hall also benefits from a generous double built-in cupboard at the front of the property, while at the rear sits the family bathroom, fitted with a stylish three-piece suite including a shower over the bath.



17 Balmoral Drive, Harthill, Shotts, ML7 5FD

Approximate Gross Internal Area: (700 sq ft - 65 sq m.)

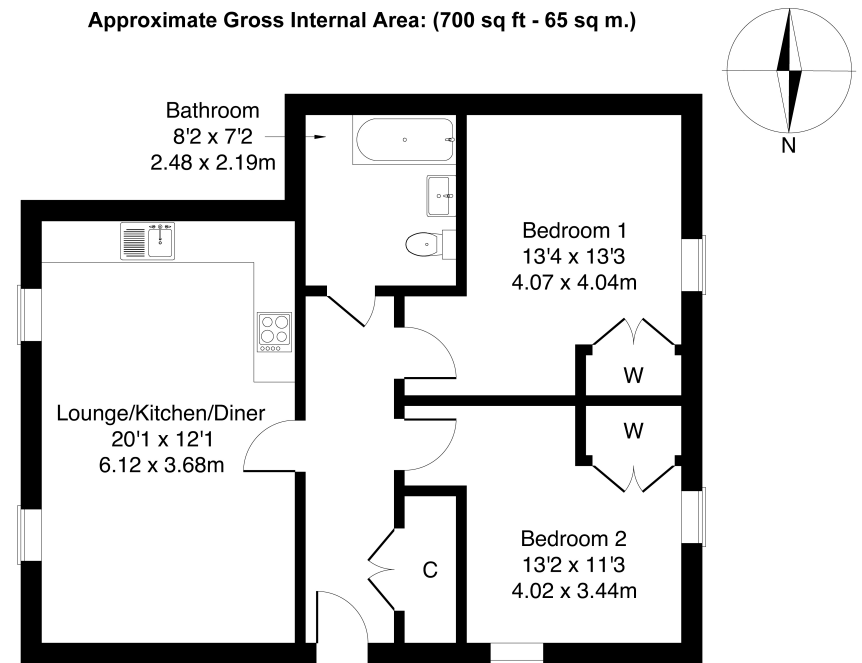

Legal Disclaimer : Floor-plan and measurements are for illustrative guidance only, and not intended to form part of any contract.

Area Description

Increasingly popular with families and commuters, Shotts lies between Glasgow and Edinburgh, just minutes from the M8 motorway. The town offers a range of local amenities and recreational facilities, including a golf club, bowling club, and leisure centre with a swimming pool. Convenience shopping is available locally, with more extensive retail

options in nearby Wishaw, Hamilton, and Livingston. Regular direct rail services run to both Edinburgh and Glasgow, alongside a good local bus service. Well-regarded primary schools are found in the town, with secondary schooling at Calderhead High School, and further options available in Wishaw and Hamilton.





Our Services

-  Free pre-sale property valuations
-  Great value fixed estate agency fees
-  Extensive buyer matching database
-  Purchase and sale conveyancing

Contact Us

0345 646 0208

sales@mov8realestate.com

www.mov8.com

Head Office

6 Redheughs Rigg, Edinburgh, EH12 9DQ

Glasgow Office

77 Renfrew Street, Glasgow, G2 3BZ



Estate Agents and Solicitors



These particulars do not form part of any contract and the statements or plans contained herein are not warranted nor are they to scale. All descriptions, dimensions, areas, reference to condition and necessary permissions for use and occupation and other details are given in good faith, and are believed to be correct, but any prospective purchaser should not rely on them as statements or representations of fact, and any prospective purchaser must satisfy themselves by inspection or otherwise as to the correctness of each of them. The Seller shall not be bound to accept the highest or any offer nor to accept a full offer of the Fixed Price where this is applicable. Approximate measurements have been taken by sonic device and measurements are most often taken to the widest point of any room or space. Services and appliances have not been tested for efficiency or safety and no warranty is given as to their compliance with any Regulations. Offers should be made using the Combined Standard Clauses.